



D	Internal layout updated to JSA drawing No. 1734-JSA-WY-XX-DR-A-01201_P11.	DW	KH	12.05.2022
C	Notes revised.	DW	KH	07.10.2021
B	Internal layout updated (JSA file ref. 1734-JSA-WY-XX-M2-A-90201).	DW	KH	20.09.2021
A	Internal layout updated and site access relocated.	DW	KH	29.07.2021
REV	DETAILS	DRAWN	CHECKED	DATE

NOTES :

1. This drawing to be read & printed in colour.
2. This drawing is for illustrative purposes only, and not for construction.

PROJECT	Tewin Road, Welwyn Garden City
DRAWING TITLE	Proposed Southern Service Yard Access (Sheet 1 of 5)

CLIENT	HBD								
SCALE	1:250	SIZE	A3	DRAWN BY	DW	CHECKED BY	KH	DATE	05.07.2021
PROJECT REF	21055		DWG NO	004(1)		REV	D		

pulsar
TRANSPORT PLANNING

4 Underwood Row, London, N1 7LQ
Tel: 020 7324 2677
www.pulsartransport.co.uk

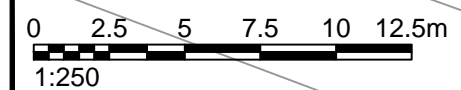
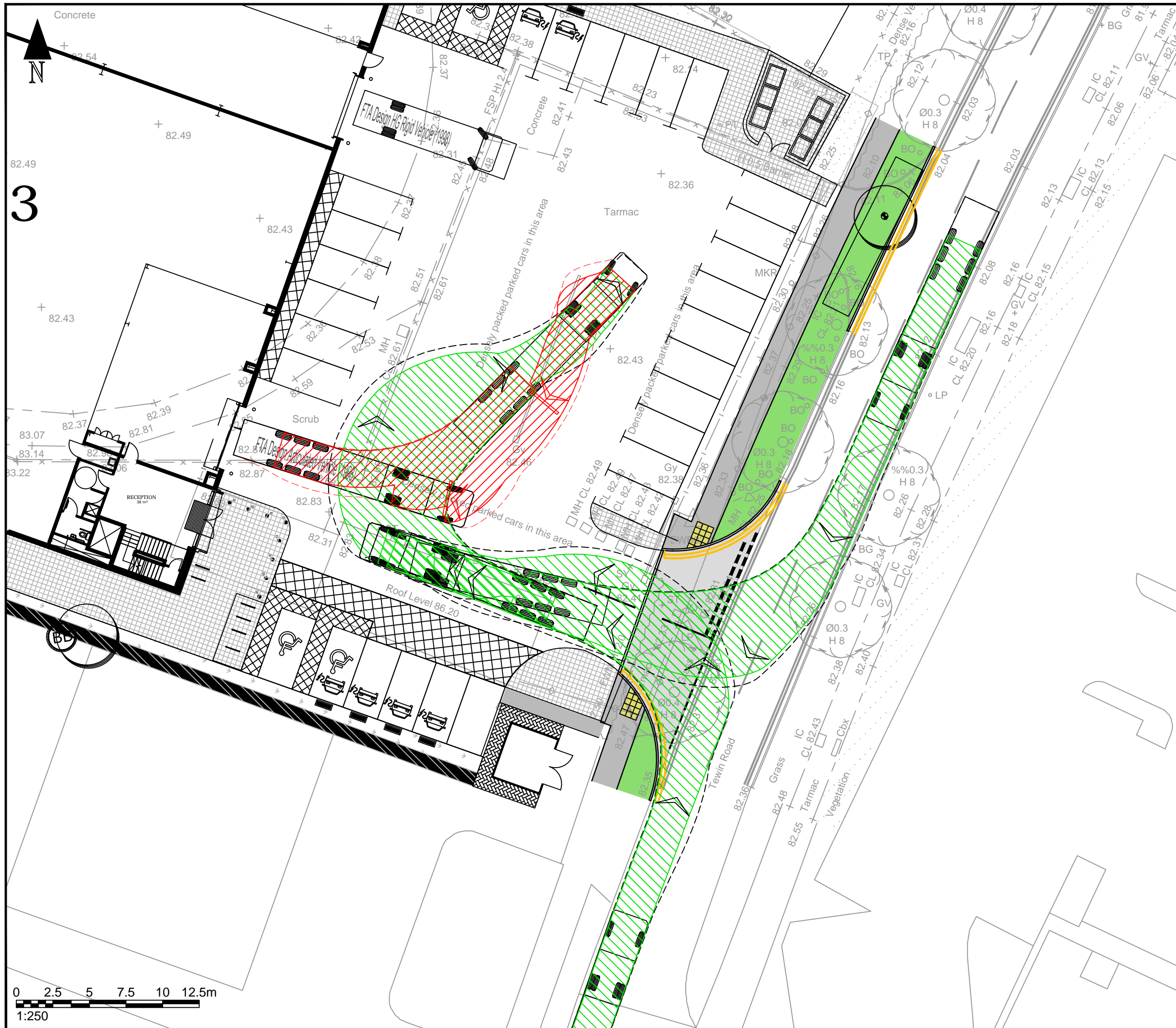

NOTES:

1. This drawing to be read & printed in colour.
2. This drawing is for illustrative purposes only, and not for construction.

FTA DESIGN ARTICULATED VEHICLE (1998)

Overall Length	16.480m
Overall Width	2.550m
Overall Body Height	3.870m
Min Body Ground Clearance	0.515m
Max Track Width	2.470m
Lock to Lock Time	3.00s
Kerb to Kerb Turning Radius	6.550m

	FORWARD MOVEMENTS (design speed - 5kph)
	REVERSE MOVEMENTS (design speed - 2.5kph)

D	Internal layout updated to JSA drawing No. 1734-JSA-WY-XX-DR-A-01201_P11.	DW	KH	12.05.2022
C	Notes revised.	DW	KH	07.10.2021
B	Internal layout updated (JSA file ref. 1734-JSA-WY-XX-M2-A-90201).	DW	KH	20.09.2021
A	Internal layout updated and site access relocated.	DW	KH	29.07.2021

REV	DETAILS	DRAWN	CHECKED	DATE
-----	---------	-------	---------	------

CLIENT: **HBD**

PROJECT: **Tewin Road, Welwyn Garden City**

DRAWING TITLE: **Proposed Southern Service Yard Access (Sheet 2 of 5)**

SCALE	1:250	SIZE	A3
-------	-------	------	----

DRAWN BY	DW	CHECKED BY	KH	DATE	05.07.2021
----------	----	------------	----	------	------------

pulsar
TRANSPORT PLANNING

4 Underwood Row, London, N1 7LQ
Tel: 020 7324 2677
www.pulsartransport.co.uk

PROJECT REF	21055	DWG NO	004(2)	REV	D
-------------	-------	--------	--------	-----	---

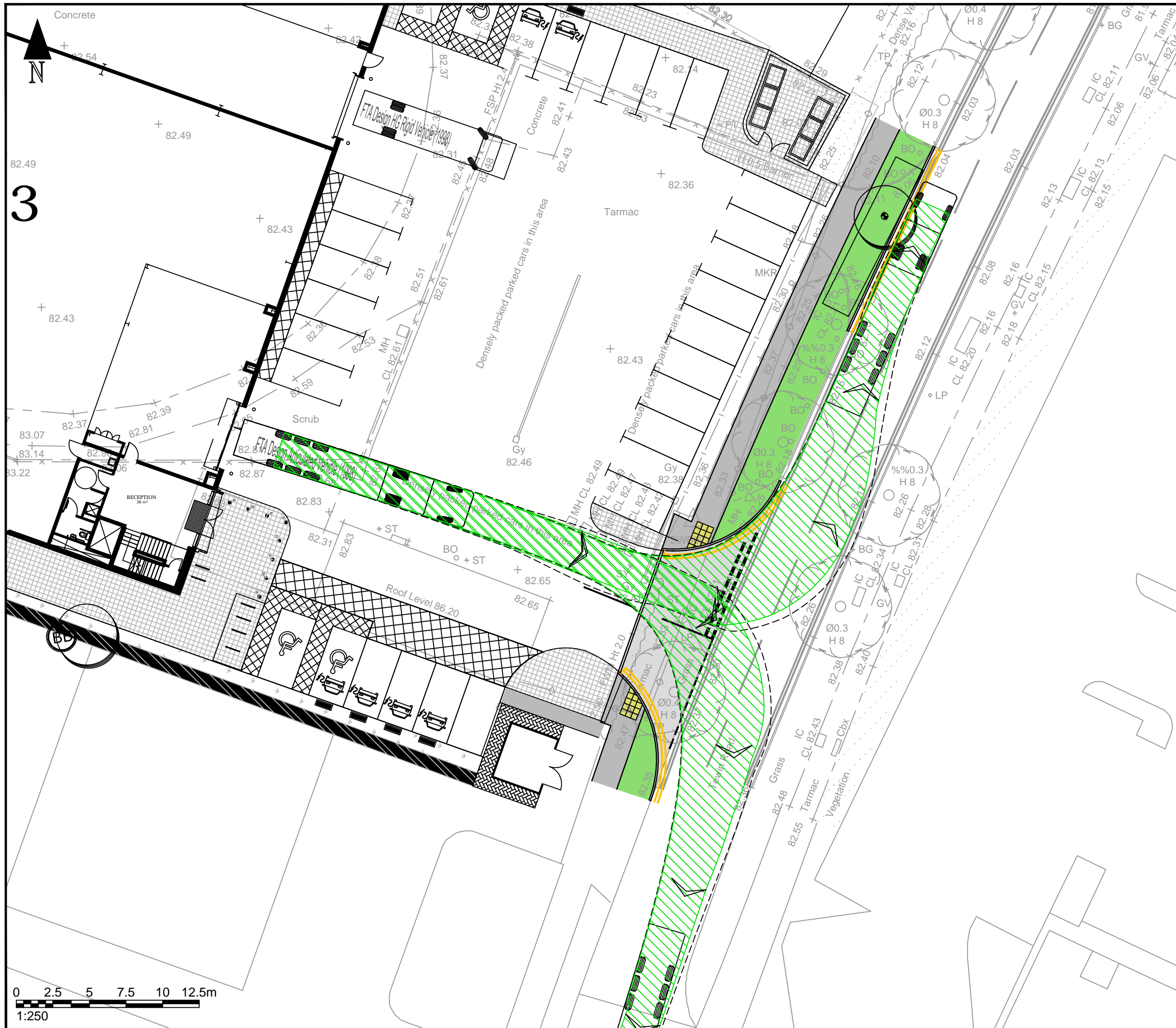

NOTES:

- This drawing to be read & printed in colour.
- This drawing is for illustrative purposes only, and not for construction.

FTA DESIGN ARTICULATED VEHICLE (1998)

Overall Length	16.480m
Overall Width	2.550m
Overall Body Height	3.870m
Min Body Ground Clearance	0.515m
Max Track Width	2.470m
Lock to Lock Time	3.00s
Kerb to Kerb Turning Radius	6.550m

	FORWARD MOVEMENTS (design speed - 5kph)
	REVERSE MOVEMENTS (design speed - 2.5kph)

D	Internal layout updated to JSA drawing No. 1734-JSA-WY-XX-DR-A-01201_P11.	DW	KH	12.05.2022
C	Notes revised.	DW	KH	07.10.2021
B	Internal layout updated (JSA file ref. 1734-JSA-WY-XX-M2-A-90201).	DW	KH	20.09.2021
A	Internal layout updated and site access relocated.	DW	KH	29.07.2021

REV	DETAILS	DRAWN	CHECKED	DATE

CLIENT: **HBD**

PROJECT: **Tewin Road, Welwyn Garden City**

DRAWING TITLE: **Proposed Southern Service Yard Access (Sheet 3 of 5)**

SCALE	1:250	SIZE	A3
-------	-------	------	----

DRAWN BY	DW	CHECKED BY	KH	DATE	05.07.2021
----------	----	------------	----	------	------------

pulsar
TRANSPORT PLANNING

4 Underwood Row, London, N1 7LQ
Tel: 020 7324 2677
www.pulsartransport.co.uk

PROJECT REF	DWG NO	REV
21055	004(3)	D

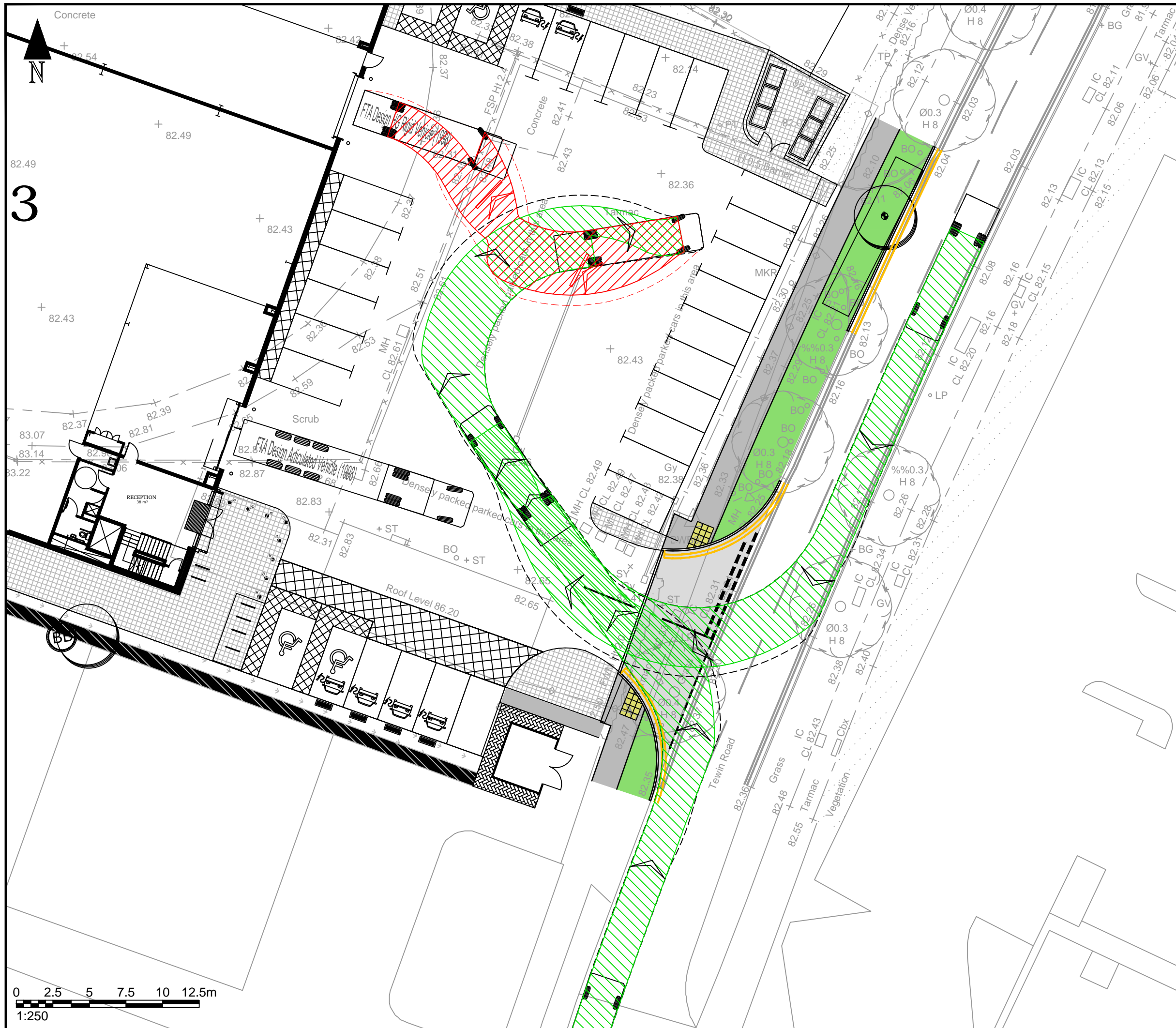

3

NOTES:

1. This drawing to be read & printed in colour.
2. This drawing is for illustrative purposes only, and not for construction.

FTA DESIGN HG RIGID VEHICLE (1998)

	FORWARD MOVEMENTS (design speed - 5kph)
	REVERSE MOVEMENTS (design speed - 2.5kph)

D	Internal layout updated to JSA drawing No. 1734-JSA-WY-XX-DR-A-01201_P11.	DW	KH	12.05.2022
C	Notes revised.	DW	KH	07.10.2021
B	Internal layout updated (JSA file ref. 1734-JSA-WY-XX-M2-A-90201).	DW	KH	20.09.2021
A	Internal layout updated and site access relocated.	DW	KH	29.07.2021

REV	DETAILS	DRAWN	CHECKED	DATE

CLIENT: **HBD**

PROJECT: **Tewin Road, Welwyn Garden City**

DRAWING TITLE: **Proposed Southern Service Yard Access (Sheet 4 of 5)**

SCALE: 1:250 SIZE: A3

DRAWN BY: DW CHECKED BY: KH DATE: 05.07.2021

pulsar
TRANSPORT PLANNING

4 Underwood Row, London, N1 7LQ
Tel: 020 7324 2677
www.pulsartransport.co.uk

PROJECT REF	DWG NO	REV
21055	004(4)	D

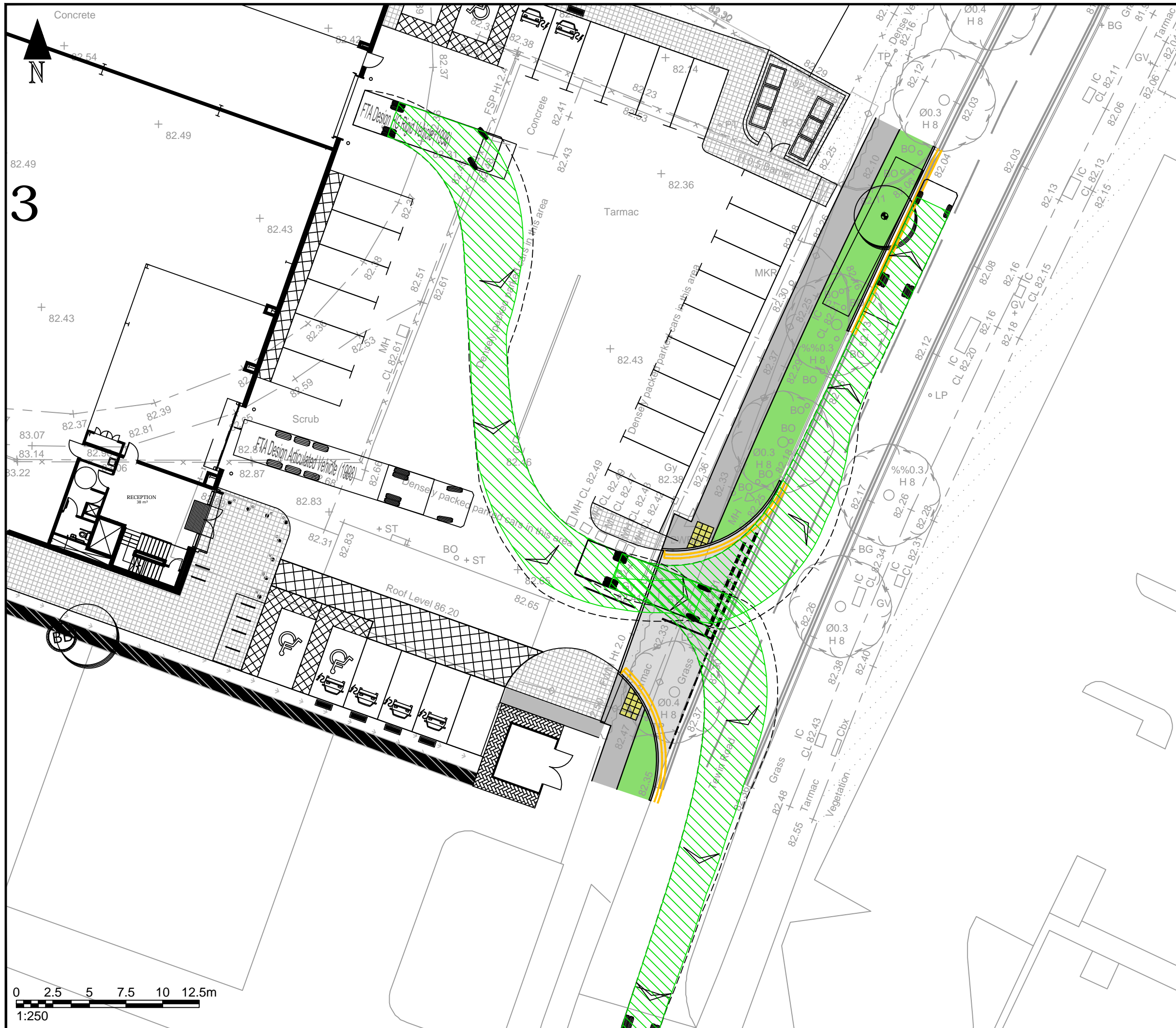

3

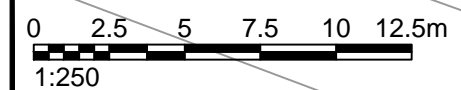

NOTES:

- This drawing to be read & printed in colour.
- This drawing is for illustrative purposes only, and not for construction.

FTA DESIGN HG RIGID VEHICLE (1998)

	FORWARD MOVEMENTS (design speed - 5kph)
	REVERSE MOVEMENTS (design speed - 2.5kph)

D	Internal layout updated to JSA drawing No. 1734-JSA-WY-XX-DR-A-01201_P11.	DW	KH	12.05.2022
C	Notes revised.	DW	KH	07.10.2021
B	Internal layout updated (JSA file ref. 1734-JSA-WY-XX-M2-A-90201).	DW	KH	20.09.2021
A	Internal layout updated and site access relocated.	DW	KH	29.07.2021

REV	DETAILS	DRAWN	CHECKED	DATE

CLIENT: **HBD**

PROJECT: **Tewin Road, Welwyn Garden City**

DRAWING TITLE: **Proposed Southern Service Yard Access (Sheet 5 of 5)**

SCALE	1:250	SIZE	A3
-------	-------	------	----

DRAWN BY	DW	CHECKED BY	KH	DATE	05.07.2021
----------	----	------------	----	------	------------

pulsar
TRANSPORT PLANNING

4 Underwood Row, London, N1 7LQ
Tel: 020 7324 2677
www.pulsartransport.co.uk

PROJECT REF	21055	DWG NO	004(5)	REV	D
-------------	-------	--------	--------	-----	---