

Existing Location Plan - No.52
1 : 1250

Outline of previously approved
planning application
Number: N6/2014/2504/FP

Outline of previously approved hard
landscaping in planning application
Number: N6/2014/2504/FP

Outline of previously approved
vehicular access in planning application
Number: W6/2014/2503/EM

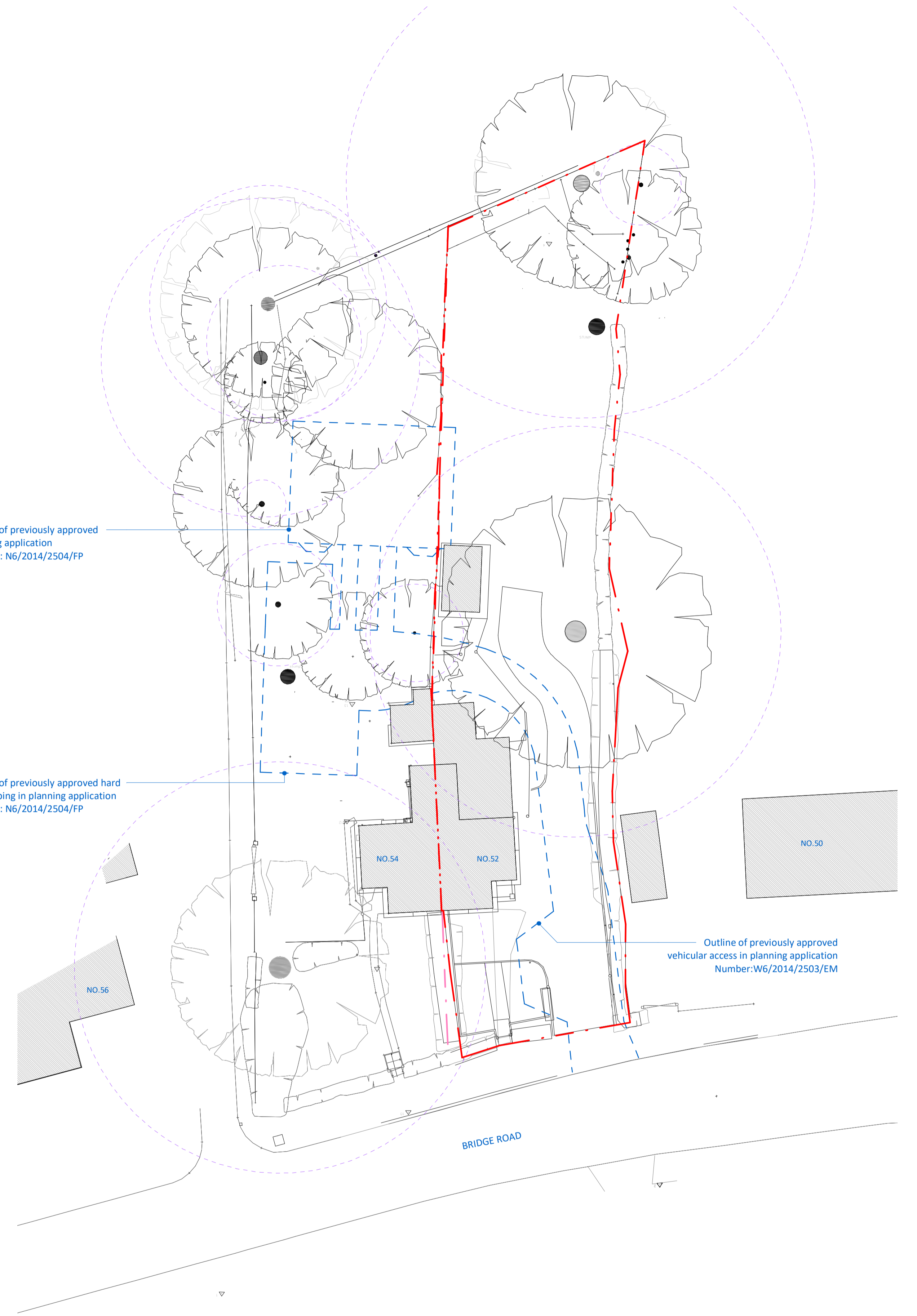

Existing Site Plan
1 : 200

| Rev | Notes | Date | By | Auth |
|-----|-------|------|----|------|
| | | | | |
| | | | | |
| | | | | |
| | | | | |
| | | | | |
| | | | | |
| | | | | |
| | | | | |
| | | | | |
| | | | | |

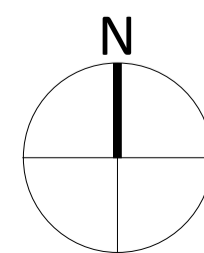

Note:
Do Not Scale from Drawings- except for Local Authority Planning purposes only.
All dimensions shown are to be verified on site by the contractor and any discrepancies to be reported to Andrew Scott Associates Architects Ltd prior to setting out, ordering any materials, fabrication or construction.
Tender drawings are produced only for the benefit of the employer and cannot be relied upon by any third party.
Copyright © Andrew Scott Associates Architects Ltd. This drawing is the property of Andrew Scott Associates Architects Ltd and is the subject of Intellectual Property Rights including copyright, patents, trade marks, design rights, protection from passing off, and the protection of confidential information and hence shall not be reproduced, copied, loaned or submitted to any other party without the written consent of Andrew Scott Associates Architects Ltd.

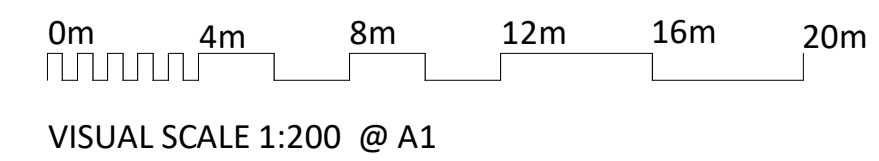

andrew scott associates

Project: RO Bridge Road, 52&54 AL8 6UR
Client: Mr M. Tabrizi
Title: Existing Site - No.52
Scale @ A1: As indicated
Drawing No: 1644.EM2.01

1325 High Road, Whetstone, London N20 9HR
email: mail@architects-asa.co.uk
Tel/Fax: +44 (0)20 8343 9696 www.architects-asa.co.uk
Drawn: RD
Checked: AS
Date: 19/07/21
Status: PLANNING
Revision:

