

This scheme is subject to Town Planning and all other necessary consents.  
 Dimensions, areas and levels where given are only approximate and subject to site survey.  
 All dimensions are to be checked on site. All feasibility studies are subject to full site survey.  
 This drawing is to be read in conjunction with all relevant consultants and/or specialist  
 drawings/documents and any discrepancies or variations are to be notified to the  
 architect in writing before the affected work commences.  
 All queries relating to design of structural elements are to be referred to the structural  
 engineering consultant for resolution.  
 The workmanship and materials of all trades and building operations shall comply with the  
 recommendations of British Standards (BS) 8000 parts 1-16 inclusive and with Approved  
 Document to support Regulation 7 1999 edition (incorporating 2000 amendments) of the  
 Building Regulations 2010.  
 All design and construction is to be in accordance with the Construction (Design and  
 Management) Regulations 2007.

| Rev | Date      | Description            | By |
|-----|-----------|------------------------|----|
| A   | 5.02.2019 | Existing roof amended. | GL |

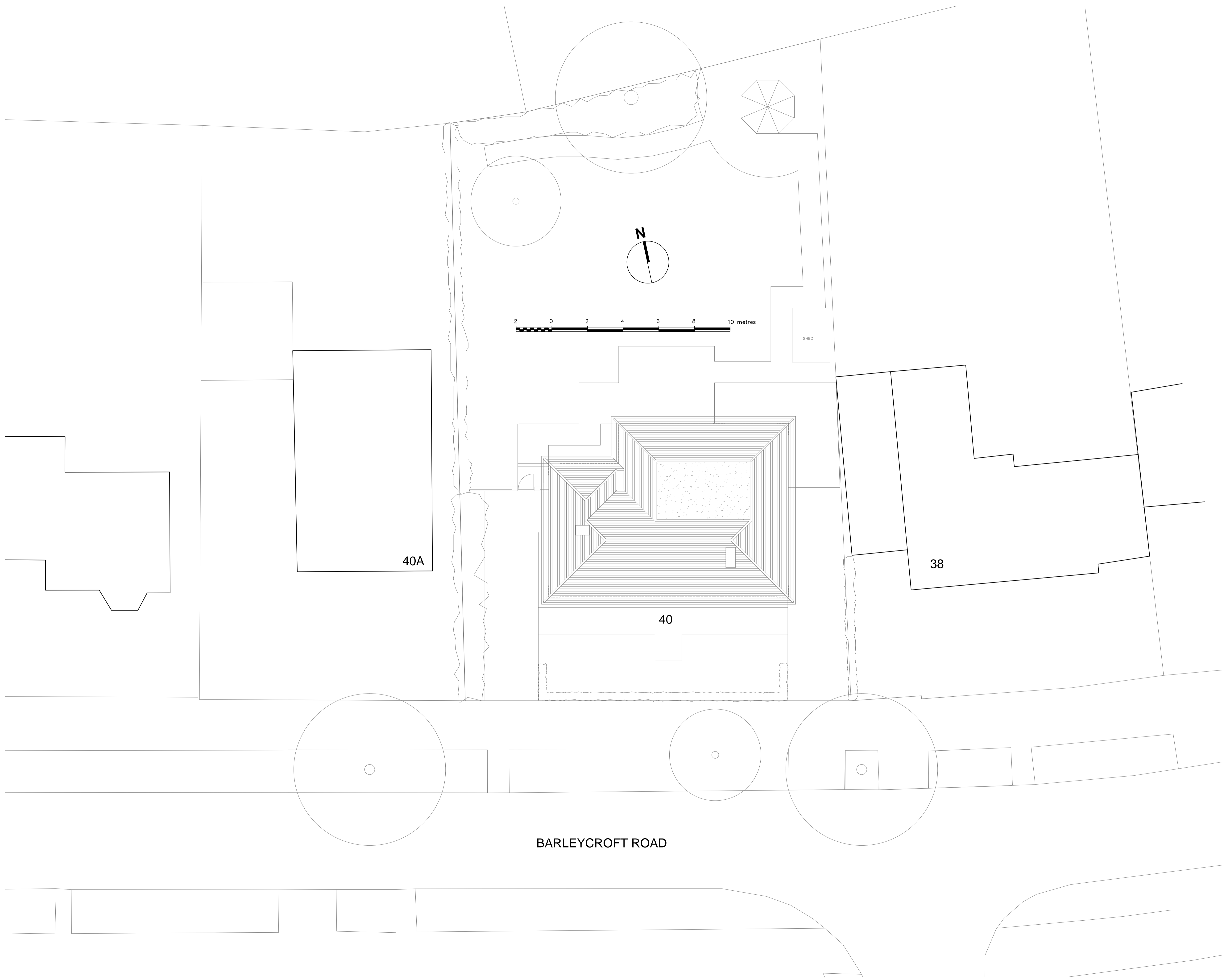

# Louis de Soissons

## ARCHITECTS

Herfordshire Office: Shoof Lodge, Lawrence End Road, Wotton Green LU2 8PH.  
 London Office: Chief Buildings, 10 Margaret Street, London W1W 8RL.  
 T. 020 7979 2027 | London Office | T. 01438 833003 | Herfordshire Office

### PLANNING

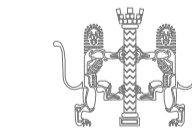

Client  
 Mr. and Mrs. Roberts

Project  
 The Old Manse  
 40 Barleycroft Road  
 Welwyn Garden City  
 Herts AL8 6JU

Drawing Title  
 Block plan  
 as Existing

| Drawn   | Date         | Checked  | Scale @ A1 |
|---------|--------------|----------|------------|
| GL      | October 2017 |          | 1:100      |
| Job No  | Drawing No   | Revision | Note       |
| 2018-44 | E.01         | A        |            |