

This scheme is subject to Town Planning and all other necessary consents. Dimensions, areas and levels where given are only approximate and subject to site survey. All dimensions are to be checked on site. All feasibility studies are subject to full site survey. The drawing is to be read in conjunction with all relevant consultants and/or specialists drawings/documents and any discrepancies or variations are to be notified to the architect in writing before the affected work commences. All queries relating to design of structural elements are to be referred to the structural engineering consultant for resolution. The workmanship and materials of all trades and building operations shall comply with the recommendations of British Standard BS8000 parts 1-16 inclusive and with Approved Document to support Regulation 7 (1999 edition (incorporating 2003 amendments)) of the Building Regulations 2010. All design and construction is to be in accordance with the Construction (Design and Management) Regulations 2007.

| Rev | Date | Description | By |
|-----|-----------|------------------------------|----|
| A | 5.02.2019 | Bedroom 4 extension removed. | GL |

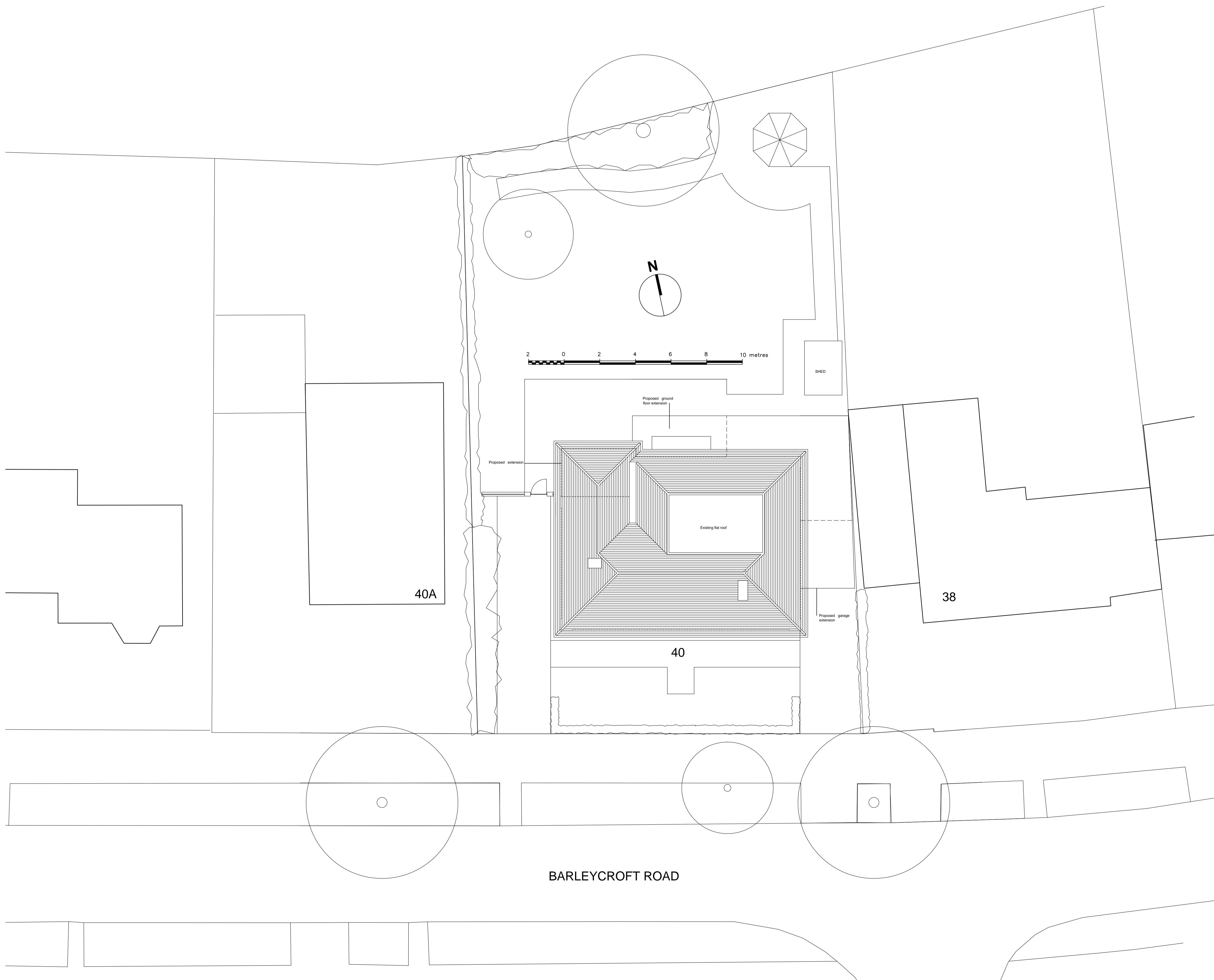

Louis de Soissons

ARCHITECTS

Herefordshire Office: Shoot Lodge, Lawrence End Road, Wandon Green LU2 8PH.
 London Office: Oriol Buildings, 10 Margaret Street, London W1W 8RL.
 T. 020 7979 2027 | London Office | T. 01438 833003 | Herefordshire Office

PLANNING

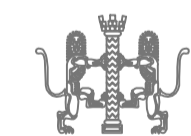

Client
Mr. and Mrs. Roberts

Project
**The Old Manse
 40 Barleycroft Road
 Welwyn Garden City
 Herts AL8 6JU**

Drawing Title
**Block Plan
 as Proposed**

| Drawn | Date | Checked | Scale @ A1 |
|---------|--------------|----------|------------|
| GL | October 2017 | | 1:100 |
| Job No | Drawing No | Revision | Note |
| 2018-44 | P.01 | A | |