

**SCHEDULE**

- Existing trees
- Removed trees
- Existing planting to retain
- New tree planting
- Existing native hedges
- New hedges
- Shrub planting
- Strata cell - urban planting underground systems
- Roof garden planters- design and materials to be decided
- Roof garden planting
- Specimens shrubs
- Climbing plants
- Decking (or similar)
- 1.8m green barbican round pole fencing will be erected

**General Planting Specification**

All PLANTING STOCK SHALL COMPLY WITH the requirements of the British Standards 3936, and shall be healthy, strong with a good shape and strong root system in accordance with the National Plant Specification. The native plants are to be of local provenance and be well labelled. The supply and planting of trees to be in accordance BS 8545:2014. 'Trees: from nursery to independence in the landscape'. Trees and shrubs are to be lifted only between mid October and mid March and to be handled and transported in accordance with relevant codes of practice, with roots kept moist and wrapped to protect them from adverse weather conditions.

All planting operations shall be carried out in accordance with British Standards 4428. Planting pits are to be dug at a size in excess of the roots to allow the roots to be spread out in the pit. All plants are to be planted at their natural depth as they existed in the nursery. 80 litres of peat free tree planting compost or well rotted manure is to be incorporated in the backfill of all tree pits. - (see enclosed diagram)

Tree pits and strata cell construction are to be executed in accordance with Green Blue Urban of Northpoint, Compass Park, Bodiam, East Sussex, TN32 5BS  
Sales and Service: +44 (0)1580 830800  
Website: [www.greenblueurban.com](http://www.greenblueurban.com)

Hedging and Shrub beds- excavate 500mm deep, and break up the base of the planting beds. Provide and lay 400mm deep topsoil in accordance with BS 3882. Cultivate to this depth and incorporate 100mm of well rotted farmyard manure or approved compost. Supply plants in accordance with BS 3936 and plant in accordance with BS 4428. Plant hedging in double staggered row, for boundary hedging 4 per metre, for box hedging 6 per metre. Supply and lay medium grade ornamental bark mulch 75mm deep to all shrub beds.

**Maintenance**  
All plants are to be maintained until established. Shrub beds are to be kept weed free. Grass to be kept well watered until established and kept maintained at a consistent height and weedfree. Hedge bases and 1 metre diameter surrounding trees are to be kept free from weed. Any additional weed growth round the base of the plant removed. The bark mulch is to be topped up annually to 75mm and the planting beds kept free of litter.

Plants within the shrub beds to be faced back from path edges as required. The following plants to be pruned annually. The hedges are to be maintained at a consistent height depending on species and location Box hedges to be maintained at 450-600mm, and boundary a minimum of 1.2 metres or as directed by the client.

**Replacement Planting**  
Replace any tree or plant within a five year period that fails to thrive or is below specification. Any grass area that fails shall be re-turfed in accordance with the specification.

**Annual Maintenance for Trees**  
All plants are to be maintained until established. Maintain a 1metre diameter surround to trees free from grass, weeds and rubbish at all times. Newly-planted trees are to be watered during April-September  
• The intervals between watering is to be fortnightly with additional visits if there has not been rainfall within a weekly period  
• Irrigate watering tubes to capacity or if supplied fill tree watering bags with 90 litre of water for slow release per visit; tree should be watered twice monthly during the summer months for the first 2 years unless there is adequate rainfall to fully hydrate the surrounding ground.  
• Fork over panned down areas.  
• Maintain mulched areas at specified depth, topping up as necessary to maintain a 75 mm cover.  
• Check each stake and tie where fitted and adjust, re-fix or renew as necessary to ensure that no damage occurs to any tree and check each stake is supporting its tree in the intended manner.  
• Check that each tree is growing healthily and remove all dead wood, damaged or diseased branches. Remove any suckering shoots growing from the clear stem. Prunings to be removed off site to the contractors tip.  
• Any wounds shall be neatly pared back to sound wood in accordance with BS. 3998: 2010 'Recommendations for Tree Work'. Re-firm trees which have been loosened by the wind or frost.  
Remove all stakes and ties after two years or after the trees have rooted successfully.

**Management**  
A management company will be set up and landscape maintenance carried out on all the communal area in accordance with the above specification.

NOTE This is a conversion of the office building to flats and there will be no change of levels within the site ( details of the new access path are notated)

**PLANTING SCHEDULE**

Trees				
Key	Species	Size	Height	Qty
Ls	Liquidamber styraciflua Lane Roberts- 45 litre	14-16cm	4.25-6m	6
<b>TOTAL</b>				<b>6</b>

Boundary hedge				
Key	Species	density	Size	Qty
Cb	Carpinus betulus	4/m	460-600mm	320
la	Ilex quifolium	gap up	3 litre pots	25
Hhg	Hedera helix 'Glacier'	1/m	2 litre pots	55
<b>TOTAL</b>				<b>400</b>

Ground cover shrubs and low hedging				
Key	Species	Density	Size	Qty
Bd	Brachyglottis drysdale	4/m	3 litre	20
Ct	Choisya ternata	3/m	5 litre	35
Efg	Euonymus fortunei 'Gaiety girl'	4/m	2 litre	160
Er	Epimedium 'rubrum'	6/m	2 litre	70
Hhg	Hedera helix 'Glacier'	1/m	2 litre	25
<b>TOTAL</b>				<b>310</b>

Specimen shrubs				
Key	Species	Density	Size	Qty
Msg	Miscanthus sinensis 'Gracillimus'	specimen	5 litre	5
Ptp	Phormium tenax 'purpurea'	specimen	5 litre	3
Yf	Yucca filamentosa	specimen	10 litre	3
<b>TOTAL</b>				<b>11</b>

Roof garden				
Key	Species	Density	Size	Qty
Bg	Buddliea globosa	specimen	10 litre	3
Bbk	Buddliea Black Knight	specimen	10 litre	3
Ct	Choisya ternata	2/Metre	5 litre	40
Hhg	Hedera helix 'Glacier'	4/Metre	2 litre	100
Lp	Lonicera pileata	3/Metre	3 litre	60
La	Lavandula angustifolia	2/Metre	2 litre	30
Vt	Viburnum tinis	2/Metre	5 litre	15
<b>TOTAL</b>				<b>251</b>

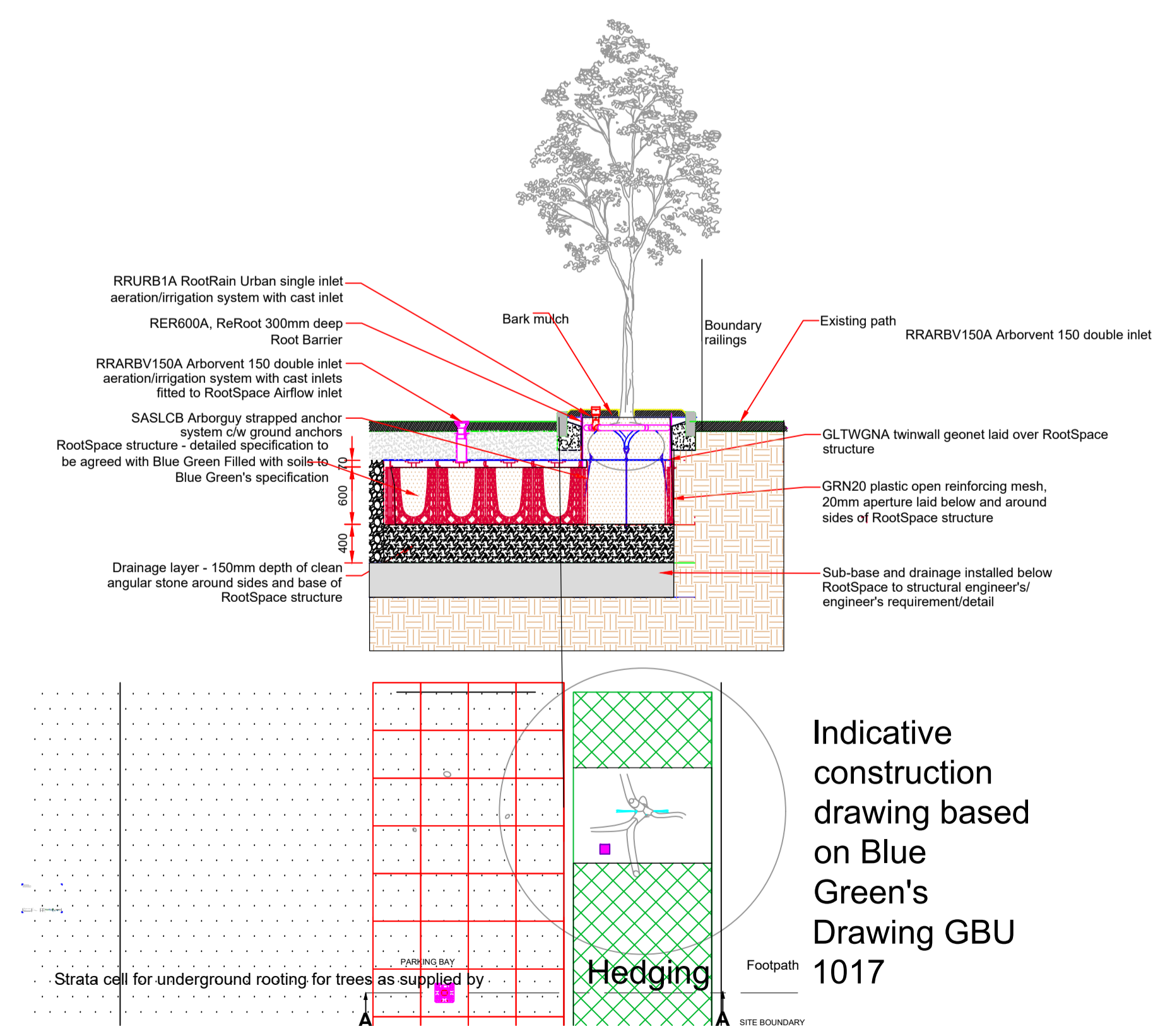

**Indicative specification for roof planters either free standing or solid construction as part of the roof architecture**

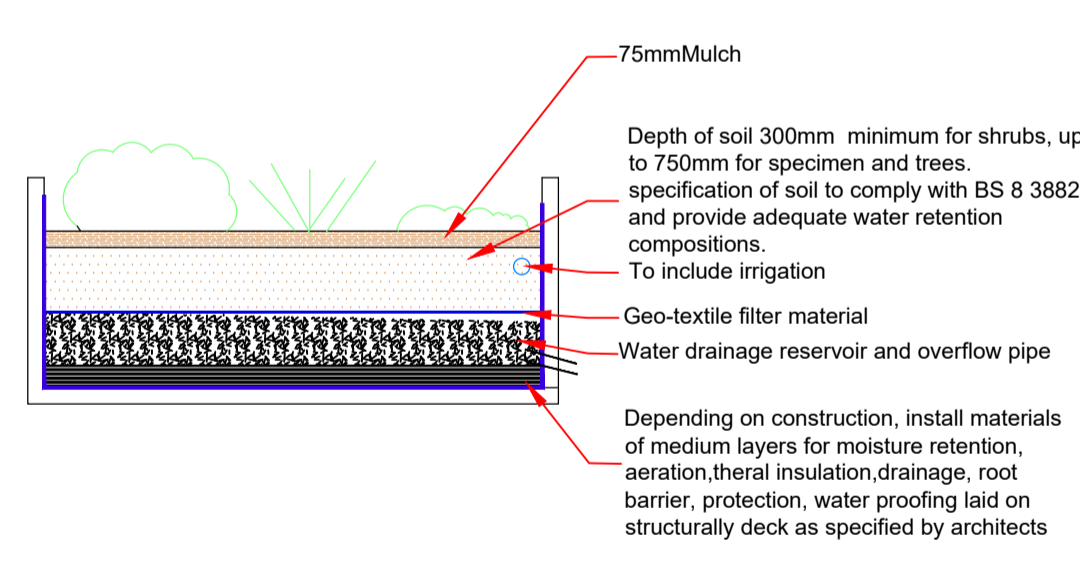

Indicative construction drawing based on Blue Green's Drawing GBU 1017

This drawing is the copyright of Elizabeth Greenwood C.M.L.I., F.Arbor.A and may not be reproduced in whole or in part without written permission



Revision C Amended roof garden specifications and change of tree species Revision B amended to include surfaces, levels, fencing and management Revision A amended to plan Studio 11 Architecture 312.A8.04 revision E	Date 15 May 2018 Date 2 May 2018 Date 19 December 2017
Schema <b>37 Broadwater Road, Welwyn</b>	Date <b>December 2016</b>
Title <b>Landscape Proposals</b>	Drawn by <b>E.J.G</b>
Scale <b>1:200 @ A1 Construction drawings not to scale</b>	Job No <b>687.16</b>
Elizabeth Greenwood C.M.L.I., F.Arbor.A. 10 Knight Street, Sawbridgeworth, Herts, CM21 9AT. Tel 01279 722381 mobile 07746867402, email ms.ejgreenwood@gmail.com	Drawn No <b>687.16.1C</b>