



1 P3(S) - East Section E - Block 10

1 : 100 @A1

NOTES
 CONSULTANTS
 - Refer to highways consultant's drawings for details
 - Refer to landscape consultant's drawings for details
 - Landscaping layout is indicative only

AREAS
 - Refer to area schedule

Rev	Notes	Date	By	Auth
P5	Block 10 & 11 Updated	16-07-2020	RB	
P6	Reduction in Gas Meter Housing	09-02-2021		
P7	Updated NMA to include revised flues	17-12-2021		

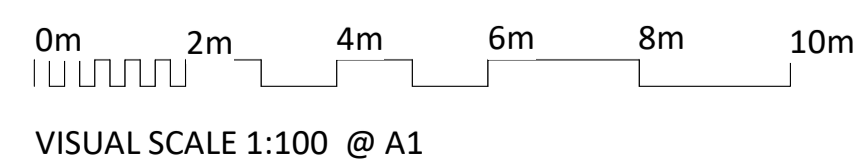
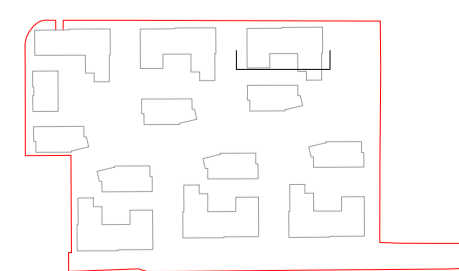

Materials Key:

- | | | |
|---------------------------------------------------|-----------------------------------------------------|---------------------------------------------------------------------|
| 01 Buff Brick - Smooth Texture | 07 Recessed Brick Panel - Smooth Texture Buff Brick | 11 Concrete Canopy Cladded In Reconstituted Stone To Block Entrance |
| 02 Buff Brick - Rough Texture | 08 Reconstituted Stone Banding | 12 Aluminium Composite Window |
| 03 Red Brick | 09 Metal Railing Balustrade - Dark Grey - Type 1 | 13 Glazed Entrance Door |
| 04 Horizontal Projecting Brick Course - Red Brick | 10 Metal Railing Balustrade - Bronze Colour- Type 2 | 14 Fixed Glazing Panel In Aluminium Frame |
| 05 Patten Perforated Metal Cladding | | 15 Metal Louvres |
| 06 Off White Brick | | |

ColladoCollins Architects

17-19 Foley Street
 London W1W 6DW
 T 020 7580 3490
 F 020 7580 2917
 info@colladocollins.com
 www.colladocollins.com

Date: 16/07/2020
 Drawn By: RB
 Checked By: FVB
 Scale @ A1: As indicated
 Scale @ A3: 1 : 200
 CAD File No:

Metropolitan Thames Valley Housing Association

Former Shredded Wheat Factory
 1/100 Elevations Block 10 Int

PLANNING
 16037

P3(S)-135