



1 P3(S) - East Section F - Block 11
 1 : 100 @A1

NOTES
 CONSULTANTS
 - Refer to highways consultant's drawings for details
 - Refer to landscape consultant's drawings for details
 - Landscaping layout is indicative only

AREAS
 - Refer to area schedule

© Copyright Reserved. ColladoCollins Partners LLP

Rev	Notes	Date	By	Auth
P4	CHP to Block 11	18-06-20	CB	
P5	Block 10 & 11 Updated	16-07-2020		RB
P6	Reduction in Gas Meter Housing	09-03-2021		
P7	Updated NMA to include revised flues	17-12-2021		

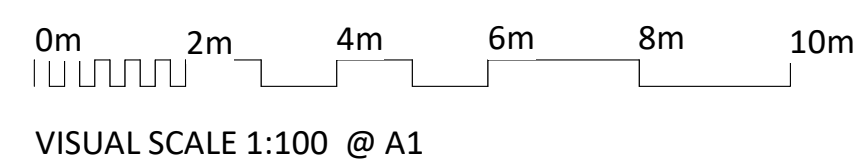
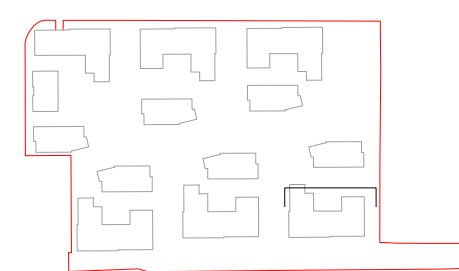

Materials Key:

- 01 Buff Brick - Smooth Texture
- 02 Buff Brick - Rough Texture
- 03 Red Brick
- 04 Horizontal Projecting Brick Course - Red Brick
- 05 Patten Perforated Metal Cladding
- 06 Off White Brick
- 07 Recessed Brick Panel - Smooth Texture Buff Brick
- 08 Reconstituted Stone Banding
- 09 Metal Railing Balustrade - Dark Grey - Type 1
- 10 Metal Railing Balustrade - Bronze Colour- Type 2
- 11 Concrete Canopy Cladded In Reconstituted Stone To Block Entrance
- 12 Aluminium Composite Window
- 13 Glazed Entrance Door
- 14 Fixed Glazing Panel In Aluminium Frame
- 15 Metal Louvres

ColladoCollins Architects

17-19 Foley Street
 London W1W 6DW
 T 020 7580 3490
 F 020 7580 2917
 info@colladocollins.com
 www.colladocollins.com

Date: 12/01/2018
 Drawn By: LB
 Checked By: PM
 Scale @ A1: As indicated
 Scale @ A3: 1 : 200
 CAD File No:

Metropolitan Thames Valley Housing Association
 Former Shredded Wheat Factory
 1/100 Elevations Block 11 Int
PLANNING
 16037 P3(S)-125