

This drawing is the property of Bradley Murphy Design Ltd. Copyright is reserved by them and the drawing is issued on the condition that it is not copied, reproduced, retained nor disclosed to any unauthorized person either wholly or in part without the consent of Bradley Murphy Design Ltd.

- NOTES:
1. THIS DRAWING IS BASED ON BMD DRAWING BMD.17.023.DR.P100 OVERALL GENERAL ARRANGEMENT
 2. THIS DRAWING SHOULD BE READ IN CONJUNCTION WITH ALL OTHER LANDSCAPE DRAWINGS SUBMITTED AS PART OF THE OVERALL APPLICATION
 3. THIS DRAWING IS NOT INTENDED FOR CONSTRUCTION
 4. DO NOT SCALE FROM THIS DRAWING
 5. ANY DISCREPANCIES WITHIN THIS DRAWING OR BETWEEN THIS DRAWING AND ANY OTHER INFORMATION IS TO BE REPORTED TO BMD FOR CLARIFICATION
 6. THIS PLANNING APPLICATION HAS BEEN CO-ORDINATED WITH NETWORK RAIL APPLICATION N6/2013/2305/MA

SITE BOUNDARIES



- HIBERNACULA
- STAG BEETLE LOGGERY
- BAT BOX'S (ATTACHED TO TREES)
- HEDGEHOG DOMES
- BIRD BOXES (ATTACHED TO TREES)
- INVERTEBRATE HOUSING (ATTACHED TO TREES)
- SPARROW TERRACES (ATTACHED TO BUILDINGS)
- SWIFT BOXES (ATTACHED TO BUILDINGS)

NOTES:
THE ECOLOGY ENHANCEMENTS HIGHLIGHTED IN THE PLAN **BMD.219.DR.P704** HAVE BEEN INCORPORATED INTO THE NEW LANDSCAPE PROPOSALS.

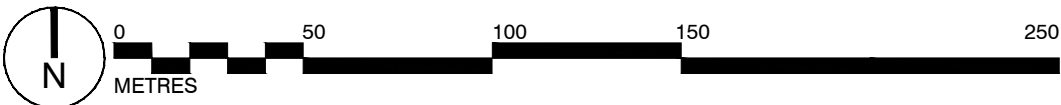
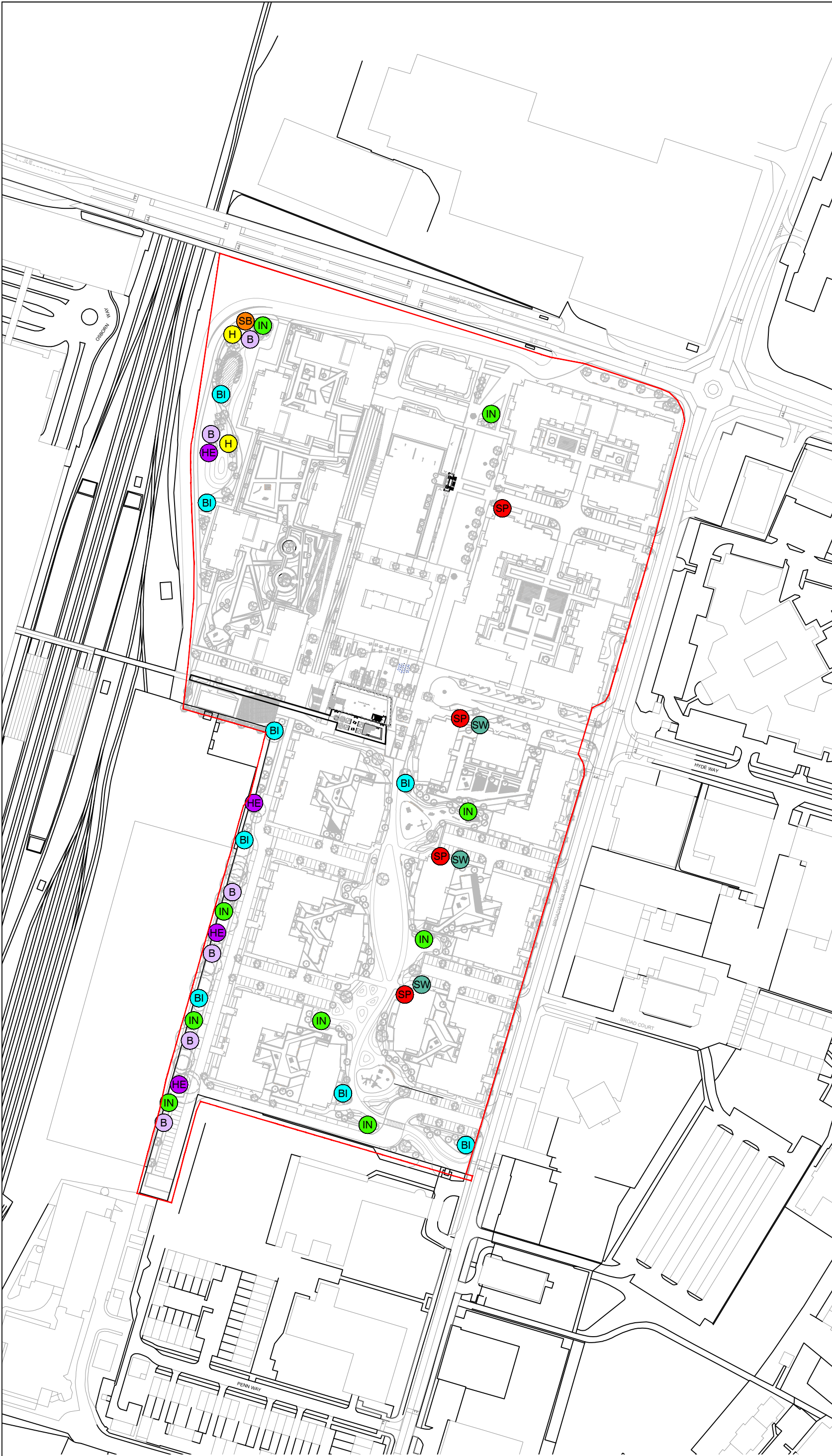

Rev	Description	Date	
Purpose of Issue			
Planning			
Bradley Murphy Design Ltd 1 The Courtyard Hatton Technology Park Dark Lane Hatton Warwickshire CV35 8XB t: 01926 676496 e: info@bradleymurphydesign.co.uk www.bradleymurphydesign.co.uk			
Client			
PLUTUS ESTATES (WGC) LTD & METROPOLITAN HOUSING TRUST			
Project			
Broadwater Road, Welwyn Garden City			
Drawing Title			
Ecology Enhancement Strategy			
Drawn	Checked	Approved	Date
ZL	CC	LB	21/09/2018
Job No.	Scale	Sheet Size	Revision
17.023	1:200	A3	
Drawing Number			
BMD.17.023.ECO.902			

