

Existing site plan
SCALE 1:200 at A3

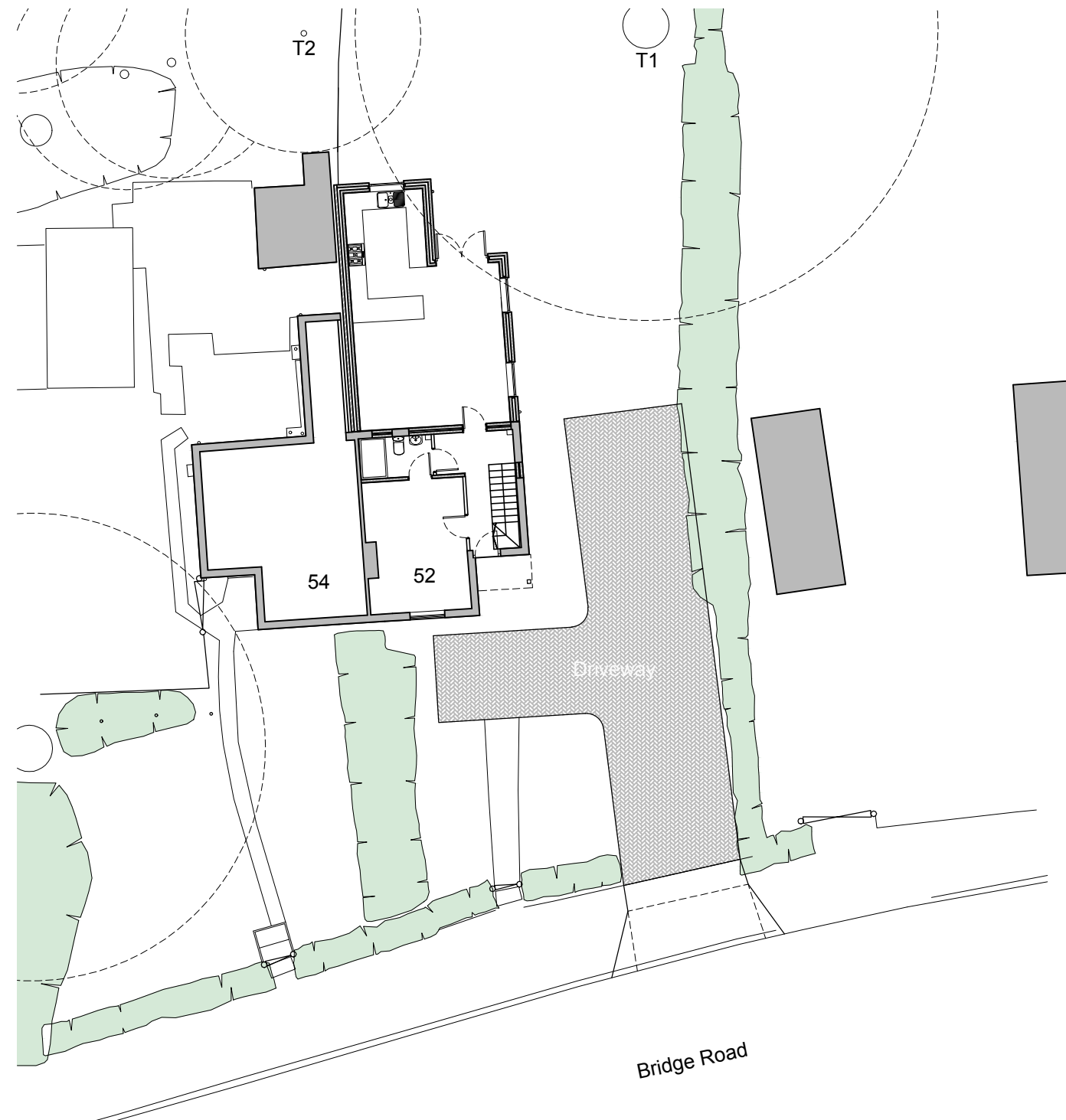

Proposed site plan
SCALE 1:200 at A3

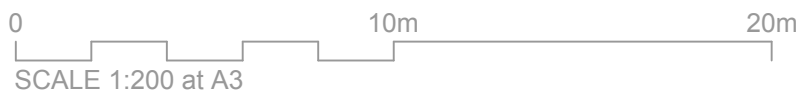

© Inhabit Architecture Ltd
This drawing and its intellectual content are the property of Inhabit Architecture Ltd and is issued on the condition that it is not reproduced, disclosed or copied in part or whole without prior written consent.
This drawing can only be scaled for Planning Application purposes. No construction dimensions are to be scaled from this drawing. All dimensions stated must be verified on site. Any discrepancies or variations are to be notified to the Architects before the affected work commences.
This drawing is to be read in conjunction with all relevant consultants' and/or specialists' design.
All queries relating to design of foundations, floor slabs and any structural elements are to be referred to the structural engineering consultant for resolution. The workmanship of all relevant trades and building operations shall comply with the recommendations of British Standard (BS).
All design and construction is to be in accordance with the Construction, Design and Management Regulations 2015

REV
A 27.11.2017 PLAN UPDATED TO CURRENT DESIGN



inhabitarchitecture

27 Alban Row
Verulam Road
St Albans
Hertfordshire
AL3 4DG

Phone: 01727 866326
www.inhabitarchitecture.co.uk

Company no: 6204820

52 BRIDGE ROAD
WELWYN GARDEN CITY
HERTFORDSHIRE. AL8 6UR

DRAWING TITLE
EXISTING AND PROPOSED SITE PLAN

STATUS	DATE	
PLANNING	22.09.2017	
PROJECT NUMBER	DRAWING NUMBER	REVISION
1203	011	A