

Notes

1. This drawing has been prepared in accordance with the scope of RPS's appointment with its client and is subject to the terms and conditions of that appointment. RPS accepts no liability for any use of this document other than by its client and only for the purposes for which it was prepared and provided.
2. If received electronically it is the recipients responsibility to print to correct scale. Only written dimensions should be used.

Development Key

Coloured hatch identifies area of proposed new development

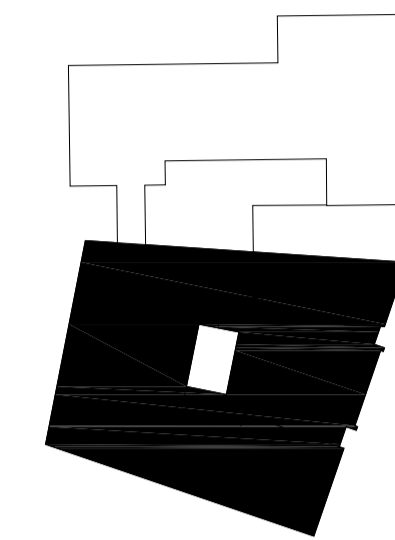
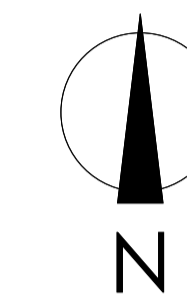

A	Updated to suit Clients requirements.	24/10/13	ACG	
Rev	Description	Date	Initial	Checked

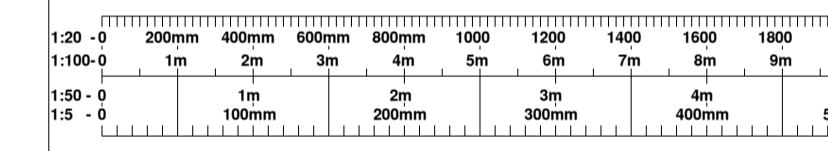

Highfield House, 5 Ridgeway
 Quinton Business Park, Birmingham B32 1AF
 T: +44(0)121 213 5500 E: rpsbm@rpsgroup.com F: +44(0)121 213 5502

Client Welwyn Hatfield Borough Council

Project Campus East

Title Proposed Second Floor Plan

Status	Drawn By	PM/Checked by
Planning	JP-ACG	-
Job Ref	Scale @ A1	Date Created
AAA5172	1:100	09/08/2013

Drawing Number	Rev
AAA5172-A-P1-018	A