

Notes

1. This drawing has been prepared in accordance with the scope of RPS's appointment with its client and is subject to the terms and conditions of that appointment. RPS accepts no liability for any use of this document other than by its client and only for the purposes for which it was prepared and provided.
2. If received electronically it is the recipient's responsibility to print to correct scale. Only written dimensions should be used.

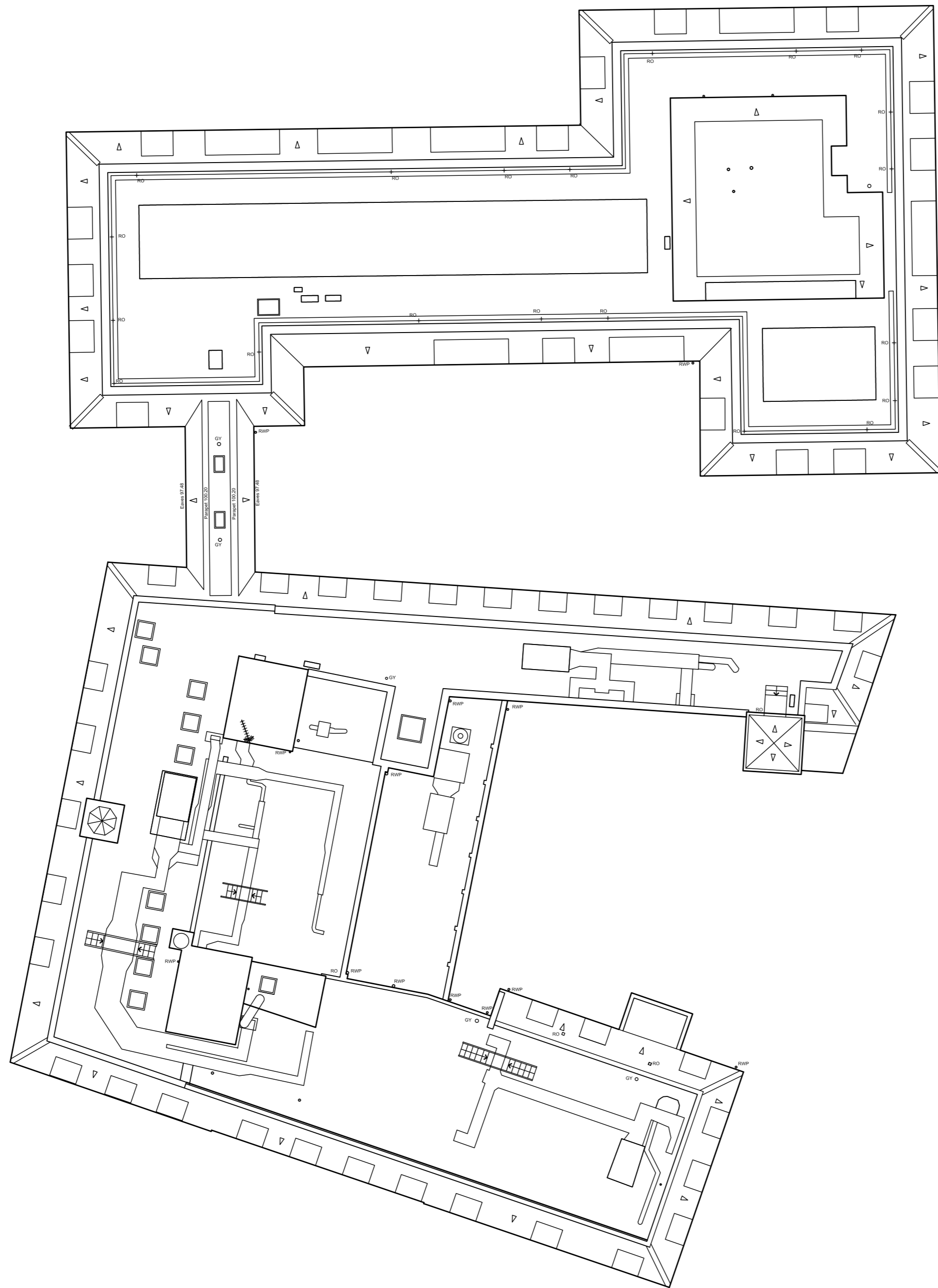

| Rev | Description | Date | Initial | Checked |
|-----|-------------|------|---------|---------|
| | | | | |



Highfield House, 5 Ridgeway
 Quinton Business Park, Birmingham B32 1AF
 T: +44(0)121 213 5500 E: rpsbm@rpsgroup.com F: +44(0)121 213 5502

Client **Welwyn Hatfield Borough Council**

Project **Campus East**

Title **Existing Roof Plan**

| | | |
|----------|------------|---------------|
| Status | Drawn By | PM/Checked by |
| Planning | - | - |
| Job Ref | Scale @ A2 | Date Created |
| AAA5172 | 1:200 | 09/08/2013 |

| | |
|------------------|-----|
| Drawing Number | Rev |
| AAA5172-A-P1-019 | - |