



Topographical Survey

Land surrounding Cuffley Football Club

Sheet 4 of 10
 August 2014
 Scale
 1:200

Horizontal Datum: Supplied by client
 Vertical Datum: Supplied by client
 Units: Metres

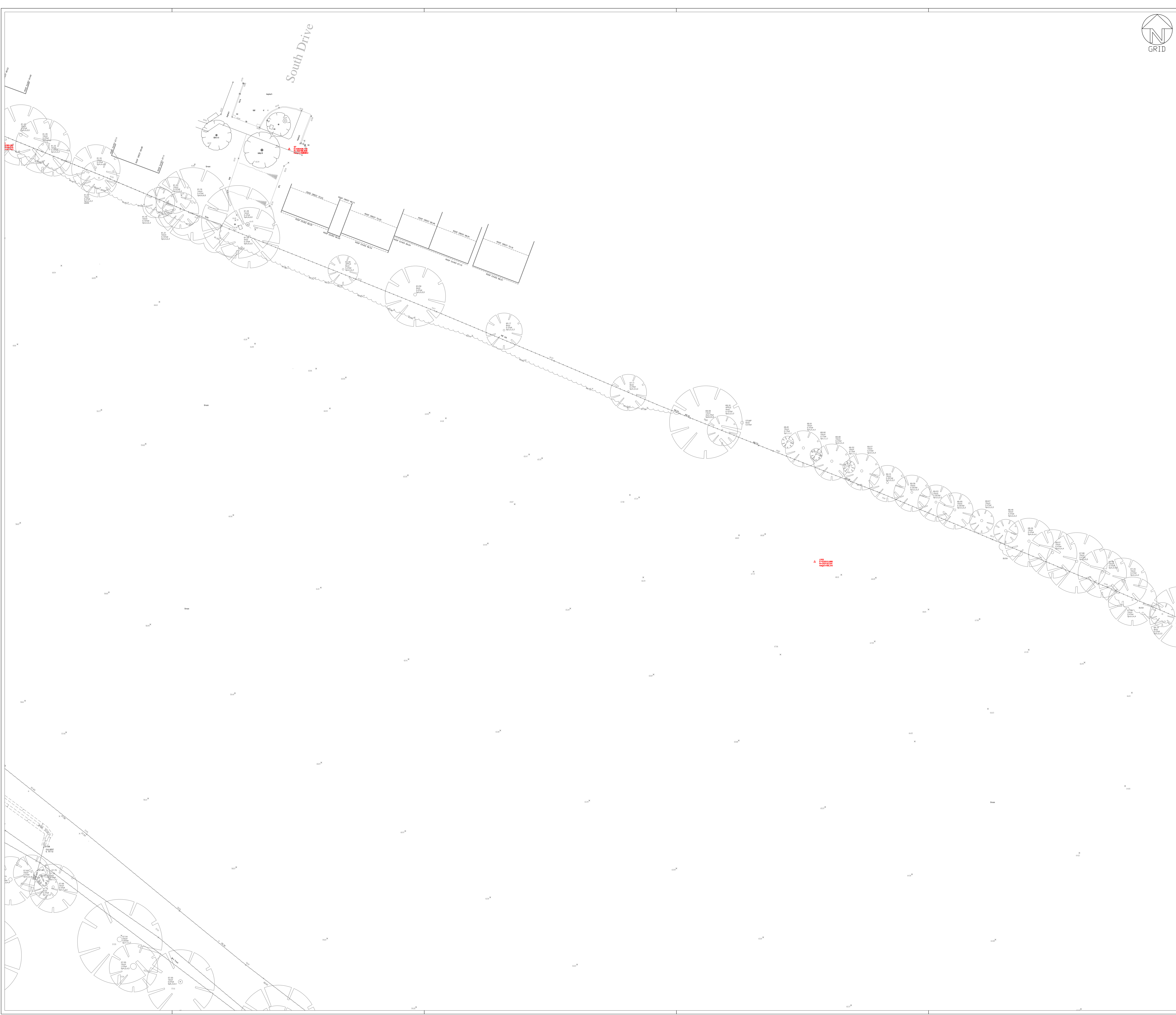
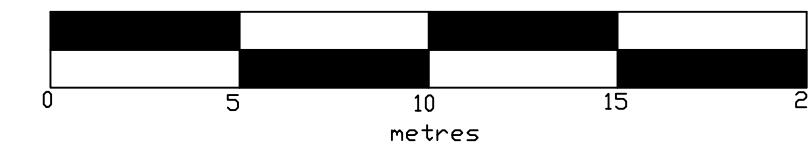

Survey Notes

1) This drawing contains elements from drawing S-06-431-01 as supplied by client.
 2) The survey control is based on the following stations within the above drawing
 S2 E03018.248 N202117.793 Level 62.74
 S3 E63047.144 N202176.436

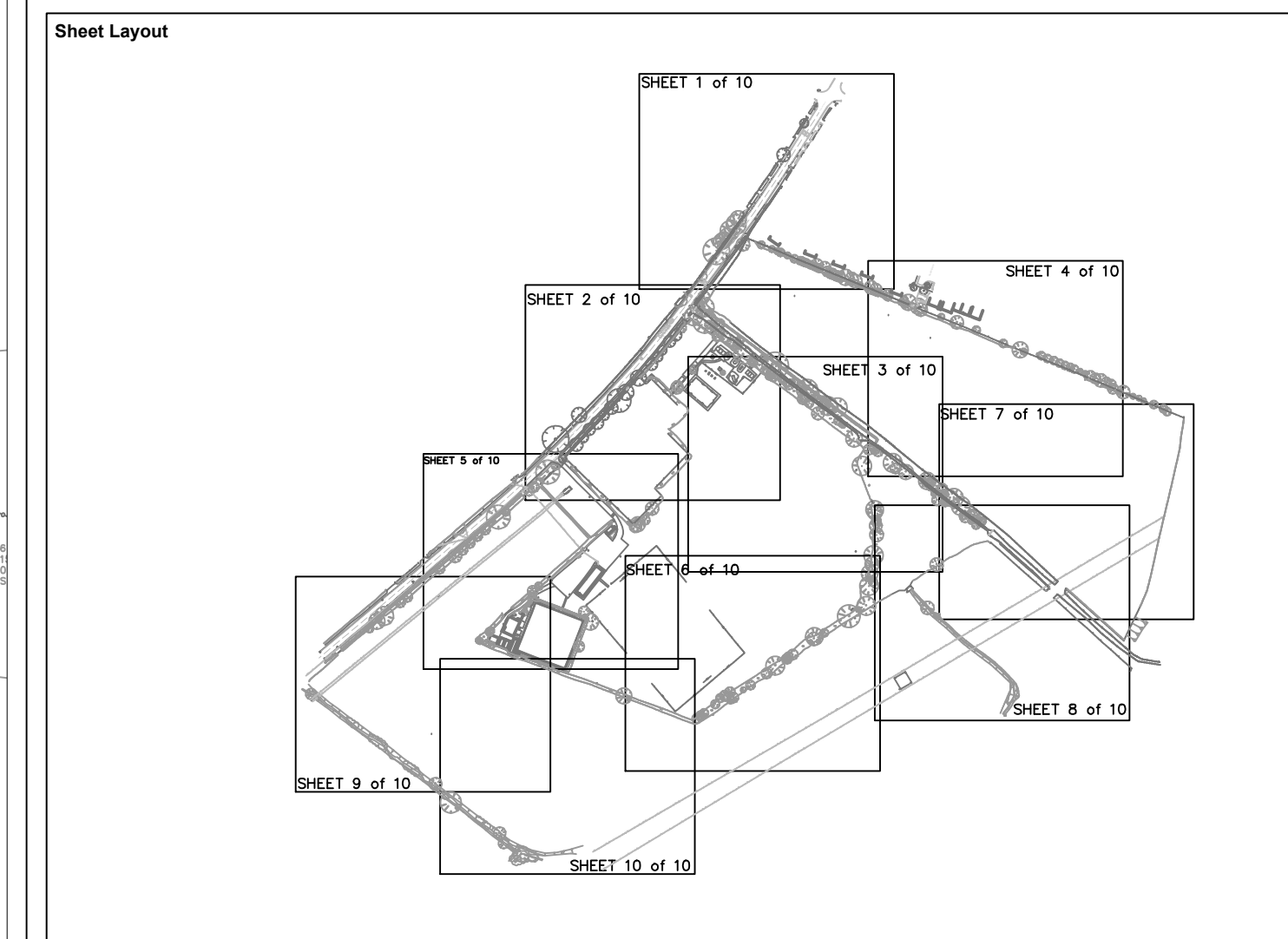

Legend

	Survey Control Station		Tee with elevation, height in metres and spread to scale
	Spot Level		Gate
	N.B. Spot levels at road edge relate to channel line		Top of bank
	Major Contour 1m Interval		Bottom of bank
	Minor Contour 0.5m Interval		Tee Canopy
	Overhead Telecoms		Foliage/Hedge edge
	Overhead Electric		

Abbreviations

PP	Post and Panel Fenceline	ER	Earth Rod	TPO	Telegraph Pole
PR	Post and Rail Fenceline	MW	Monitoring Well	EPO	Electric Pole
PW	Post and Wire Fenceline	CR	Cable-Riser	RS	Road Sign
SM	Post and Steel Mesh Fenceline	EPO	Electric Pole	BO - C	Boilard - Concrete
met	Height in Metres			BO - S	Boilard - Steel
IC	Inspection Cover	GV	Gas Valve	BO - W	Boilard - Wooden
CL	Cover Level	GM	Gas Meter	LB	Liter Bin
G	Gully	GR	Gas Riser	PI	Pillar
DP	Down Pipe	AV	Air Valve	RS	Road Sign
KWP	Rain Water Pipe	WT	Water Tank	TS	Tree Stump
FWP	Foul Water Pipe	WSV	Wash Valve	TCSB	Telephone Call Box
VC	Vent Cover	WM	Water Meter	FP	Flag Pole
RE	Road Edge	WO	Wash Out	TP	Traffic Paving
VP	Vent Pipe	TL	Telephone	FP	Fuel Pump
FWS	Foul Water Sewage	SL	Street Light	LA	Ladder
SWS	Surface Water Sewage	PLM	Pipeline Marker	FB	Flower Bed
		CAB	Street Cabinet	DK	Dropped Kerb

Prepared for: Landis Improvement
 10 Lower Goswoner Place
 London
 ESW1W 6EN

Surveyed by: C. Whiteley, E. Baker
 Date: 14th - 22nd August 2014

Drawing Reference	Rev	Date	Description	Prepared By	Drawn By	Checked By	Approved By
1667_200_4	0	20/08/14	First issue				

This drawing is the copyright of LandScope Engineering Ltd and may not be reproduced or amended except by written permission. No liability will be accepted for amendments made by other persons