

Notes
 © This drawing is copyright and must not be reproduced or copied to any third party without the written permission of Norder Design Associates Ltd.
 All dimensions must be checked on site. Only figured dimensions should be worked from. Discrepancies must be reported to Norder Design Associates before proceeding.

Layout based on archived information and therefore subject to topographical site survey

PLANNING ISSUE

Merit Merrell Technology
 Unit 5, Millerton Court, Northumberland Business Park, Cramlington, NE69 7ET
 Telephone: +44 (0)1632 824414 Fax: +44 (0)1632 824415
 Email: info@merrell.co.uk Web: www.merrell.co.uk

THIS DOCUMENT IS SUPPLIED IN STRICT CONFIDENCE AND MUST NOT BE REPRODUCED OR DISCLOSED TO ANY THIRD PARTY WITHOUT THE WRITTEN CONSENT OF MERIT MERRELL.

REV.	DATE	AMENDMENT	BY

CLIENT
 Merit Process Engineering
 Cramlington
 Northumberland

PROJECT
 Laboratory Project
 Biopark Hertfordshire
 Welwyn Garden City

DRAWING TITLE
 Basement 2 Plan
 Level 80.700
 As Existing

NORDER
 Structural and Civil Engineering Consultants
 Beech Lawn, Green Lane, Belper, Derby DE56 1BY
 Tel: 01773 824414 Fax: 01773 823305
 e-mail: enquiries@norder.co.uk

SCALE 1:100	SHEET SIZE A1
DATE 22.12.09	DRAWN TM CHECKED LO

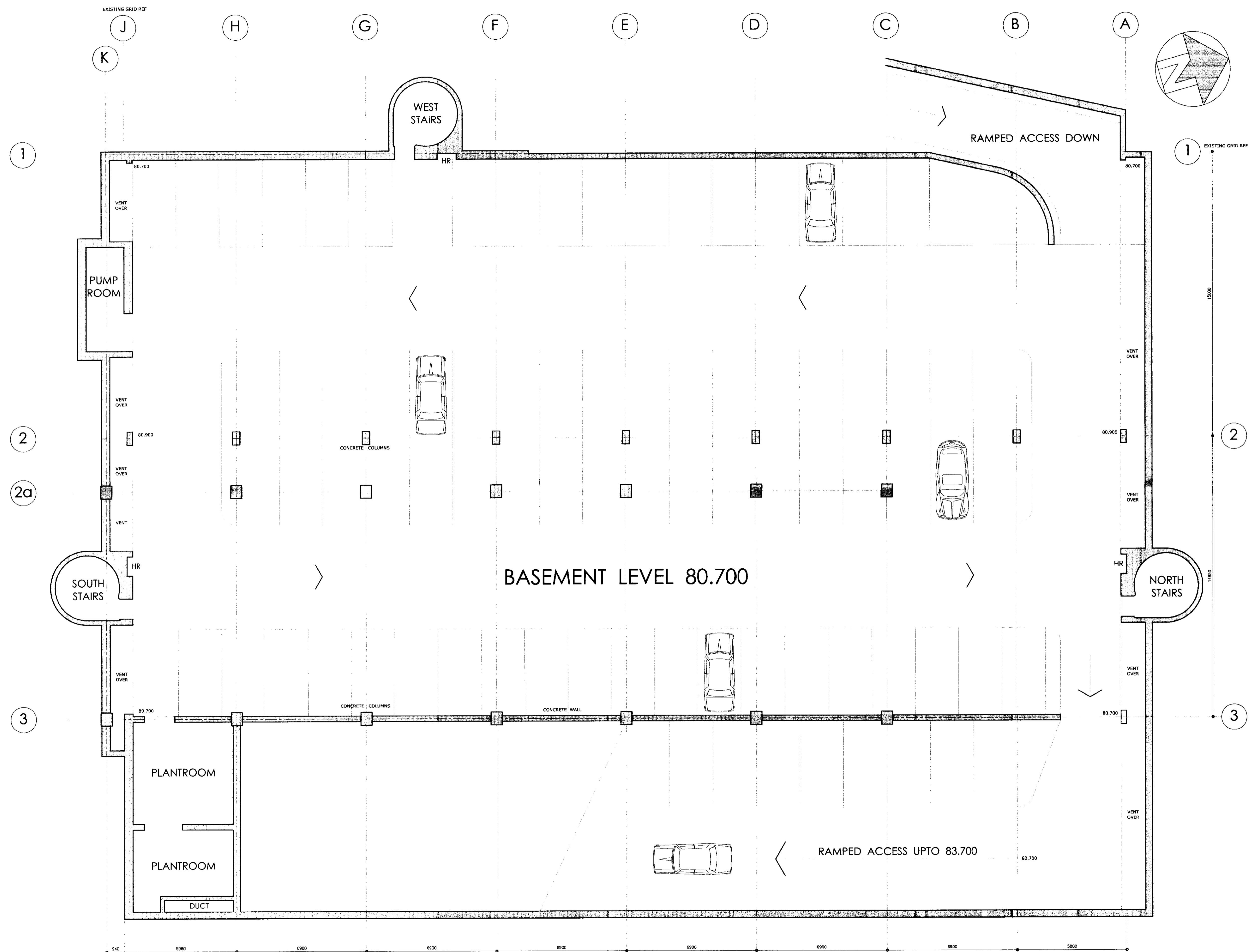

1:100
 2010/263