



Front Street Elevation Extract 1:100



Front Street Elevation Extract 1:100



This document is © Gardner Stewart Architects.

This drawing is to be read in conjunction with drawings prepared by the architects, structural engineers and service consultants and all other relevant details and information.

Any relevant or discrepancies must be reported immediately to the architect.

Do not scale: use figured dimensions only.

All dimensions must be verified by the main contractor before the commencement on site of any item of work or the preparation of shop drawings for their own work or that of sub-contractor or suppliers.

MATERIALS KEY

-  SLATE EFFECT ROOF
-  CLAY EFFECT ROOF
-  TILE HANGING
-  RED FACING BRICK
-  DARK RED DETAIL BRICK
-  CASEMENT WINDOWS, WHITE
-  FASCIAS AND BARGEBOARD: WHITE
-  GUTTERS AND DOWNPIPES: BLACK

Rev	Description	Drawn	Date
P07	Planning Issue	AG	26/09/2024

KEY PLAN

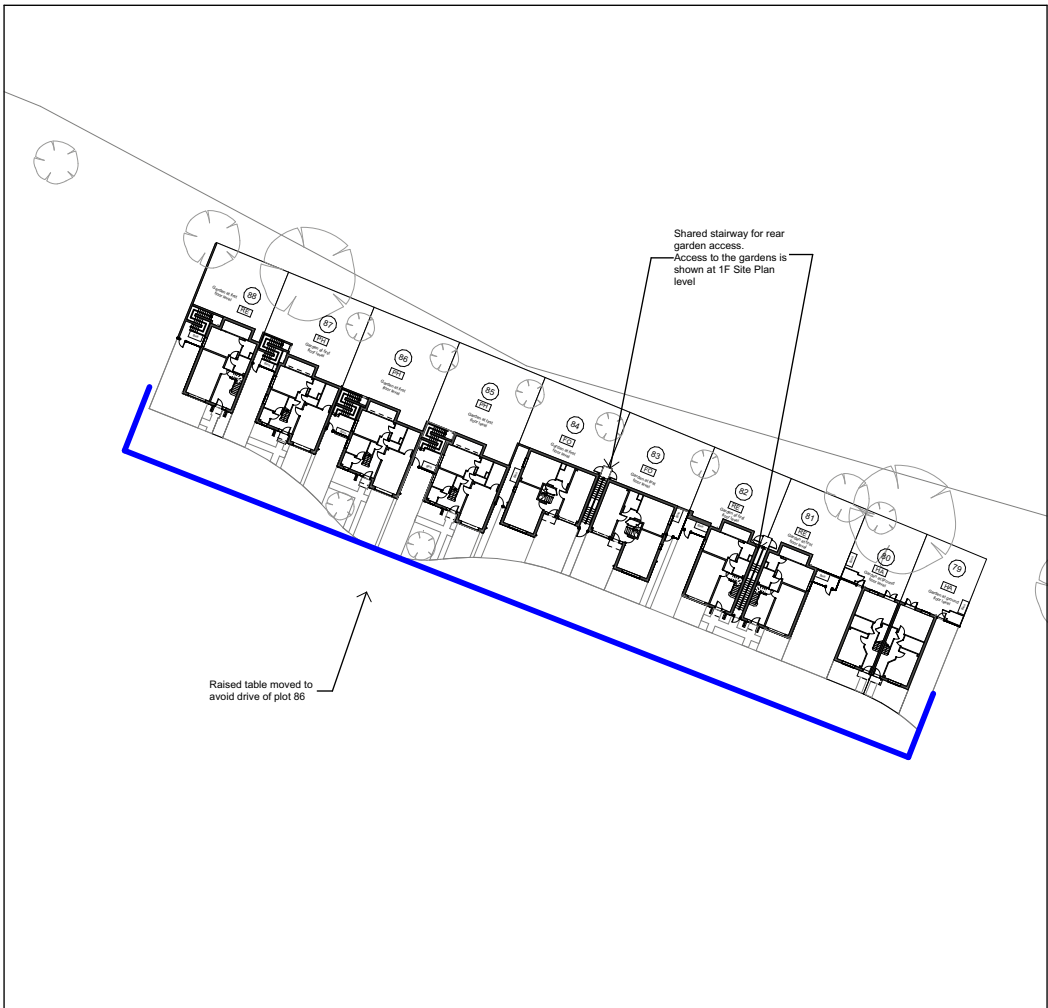

GSA

5.1.2 The Leather Market, Weston Street,
London, Southwark, SE1 3ER, UK

T: 0207 620 6255
E: info@gsa-studios.com
W: www.gsa-studios.com

Bellway

Northaw Road East
Cuffley

Illustrative Street Elevation - Front

Originator project ref 1404	Purpose of Issue For Planning	Checked By RS
Scale(s) 1:100:1000	Drawn By MS	Revision description Planning
Paper size A1		

project	originator	volume	level	type	role	number	revision
1404	GSA	-	ZZ	-	DR	-A-3101	P07

Notes: North: Cuffley, Site, Master