

This document is © Gardner Stewart Architects.
 This drawing is to be read in conjunction with drawings prepared by the architects, structural engineers and service consultants and all other relevant details and information.
 Any relevant or discrepancies must be reported immediately to the architect.
 Do not scale: use figured dimensions only.
 All dimensions must be verified by the main contractor before the commencement on site of any item of work or the preparation of shop drawings for their own work or that of sub-contractor or suppliers.

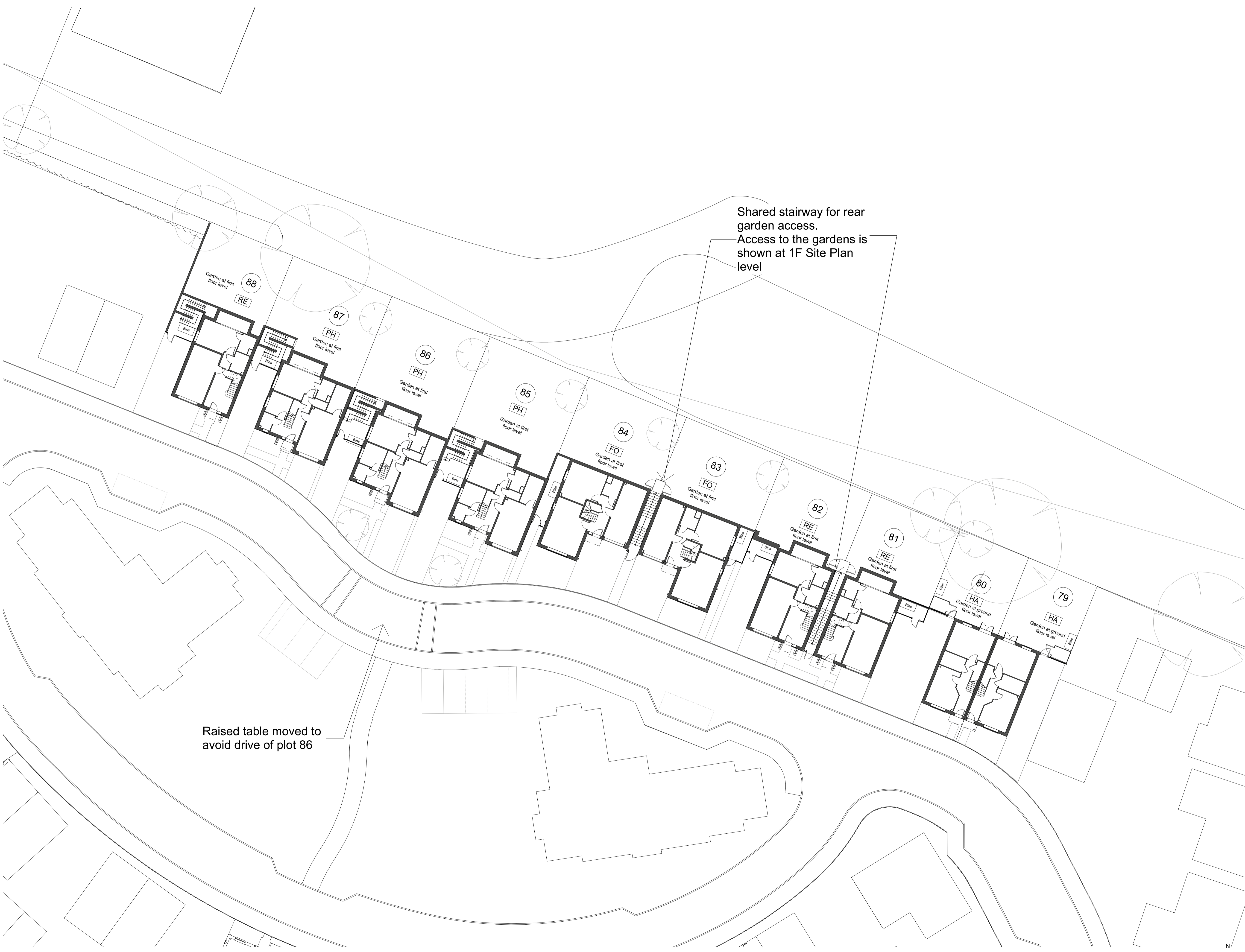

Shared stairway for rear garden access.
 Access to the gardens is shown at 1F Site Plan level

Raised table moved to avoid drive of plot 86

Rev	Description	Drawn	Date
P11	Planning Issue	AG	26/09/2024

GSA
 5.1.2 The Leather Market, Weston Street,
 London, Southwark, SE1 3ER, UK
 T: 0207 620 6255
 E: info@gsa-studios.com
 W: www.gsa-studios.com

Bellway
 Northaw Road East
 Cuffley

GF Site Plan	
Originator project ref 1404	Purpose of Issue For Planning
Scale(s) 1:200	Drawn By AG
Paper size A1	Checked By RS
	Revision description Planning Issue
project originator volume level type role number 1404-GSA-SW-00-DR-A-1300	revision P11