

© Crown Copyright and database rights 2023 OS 100047474

1 38 Barleycroft Road  
OS plan 1:1250

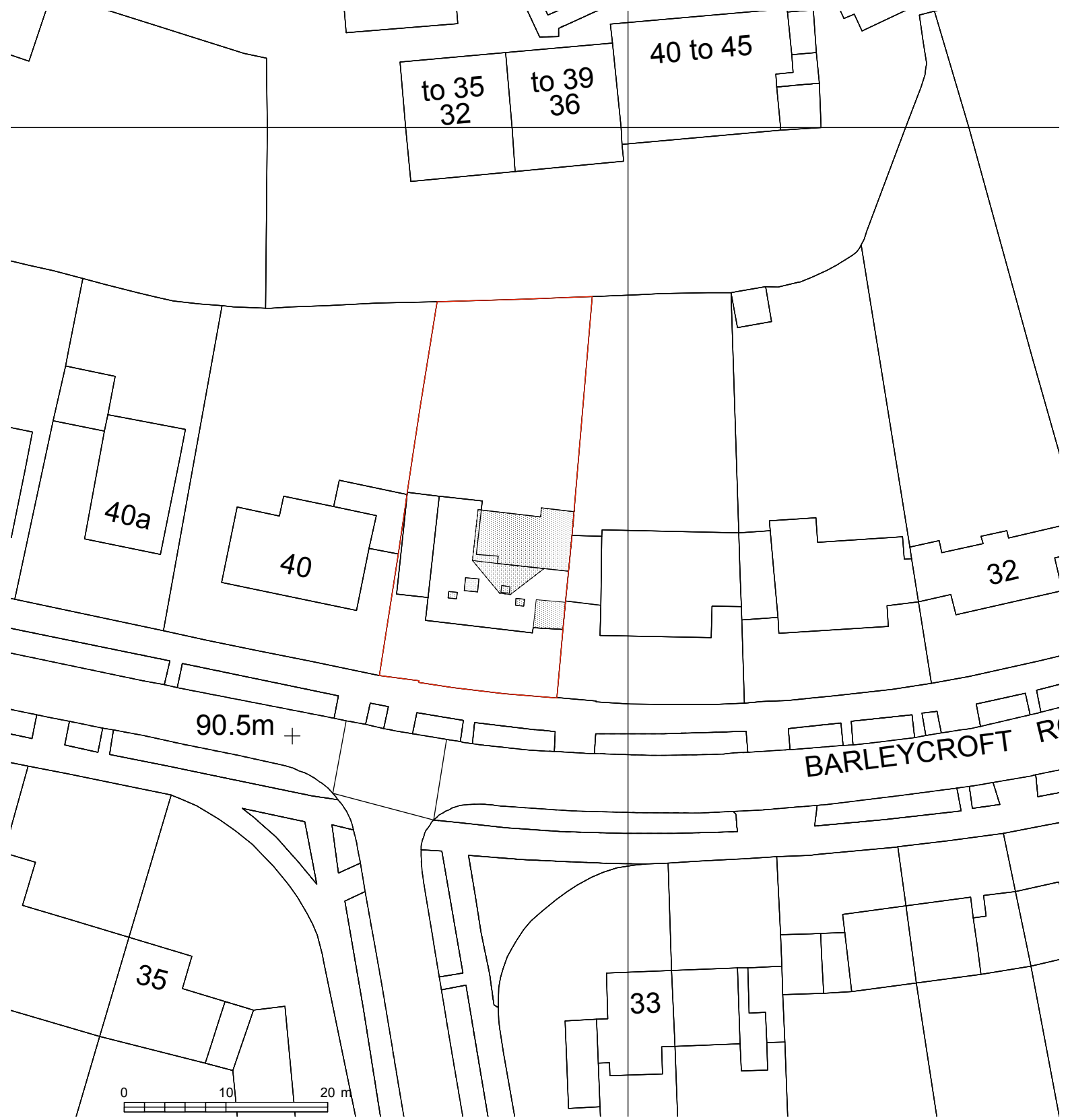

2 38 Barleycroft Road  
Block plan 1:500

**Notes**

ALL DIMENSIONS ARE TO BE CHECKED ON SITE  
THIS DRAWING IS TO BE READ IN CONJUNCTION WITH ALL CONSULTANTS' INFORMATION  
MOHNS & SANDERS RETAIN THE COPYRIGHT OF ALL INFORMATION WITHIN THIS DRAWING

Rev	Description	Date	Client	Drawing Status	Job Number	Scale	Drawn By
			Tom & Jo Shipperlee 38 Barleycroft Road WGC AL8	FOR APPROVAL	0869	1:1250/500 @ A3	
					Barley	Date 10/23	Checked By
				EXISTING & PROPOSED LOCATION PLANS	Drawing No 0869/01/115		Rev

**MOHNS & SANDERS**  
Unit G West  
1 - 3 Coate Street  
London E2 9AG  
m: 07931290408  
f: 020 7739 1818  
e: miriam@mohnsanderson.com