

S278 KEY LEGEND

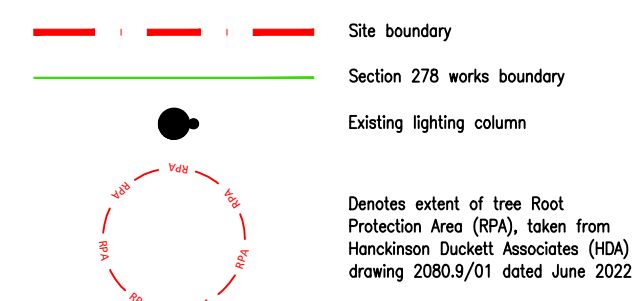

EXTERNAL FINISHES

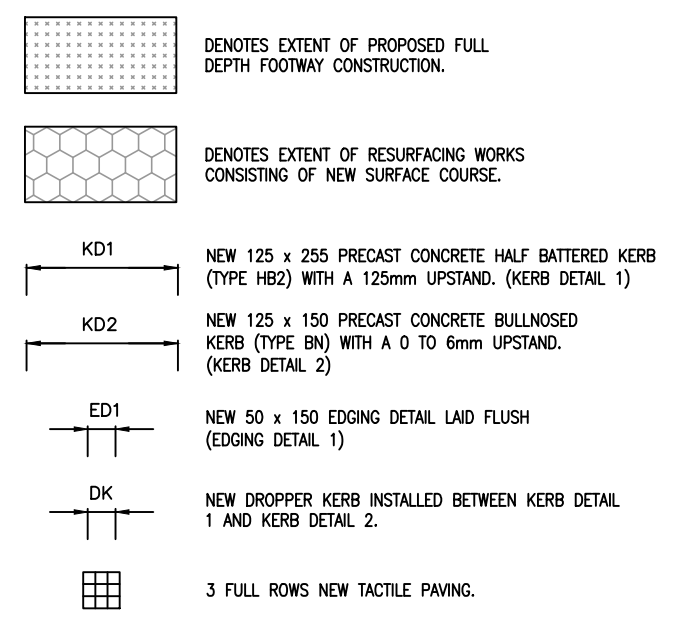

NOTES

THIS DRAWING IS TO BE READ IN CONJUNCTION WITH ALL RELEVANT DRAWINGS, DOCUMENTS AND SPECIFICATIONS. DIMENSIONS NOT TO BE SCALED.

ALL WORKS SHALL COMPLY & BE CARRIED OUT IN ACCORDANCE WITH HERTFORDSHIRE COUNTY COUNCIL'S DESIGN GUIDES.

UNLESS NOTED OTHERWISE, CLAUSES REFER TO THE SPECIFICATION FOR HIGHWAY WORKS, VOLUME 1 OF THE MANUAL OF CONTRACT DOCUMENTS FOR HIGHWAY WORKS.

CARRIAGEWAY CONSTRUCTION AND DEPTH OF CAPPING LAYER IS BASED ON A CBR VALUE OF 2-3%, RECOMMENDED BY GEO ENVIRONMENTAL GROUP.

REPORT TITLE: PHASE II GEO-ENVIRONMENTAL ASSESSMENT INTERPRETATIVE REPORT
REPORT NUMBER: KOV-SE2-2015-001
DATED: JUNE 2015

CAPPING AND SUB-BASE THICKNESS IN ACCORDANCE WITH HERTFORDSHIRE COUNTY COUNCIL'S DESIGN GUIDES. CBR VALUES TO BE CONFIRMED BY CONTRACTOR PRIOR TO ANY CONSTRUCTION COMMENCING AND REPORTED BACK TO THE ENGINEER.

BITUMINOUS MATERIAL TO BE IN ACCORDANCE WITH BS EN 13108-1:2006.

IF SURFACE COURSE IS NOT CONSTRUCTED WITHIN 3 DAYS OF BASE COURSE THEN BASE COURSE MUST BE CLEANED AND BOND COATED PRIOR TO LAYING.

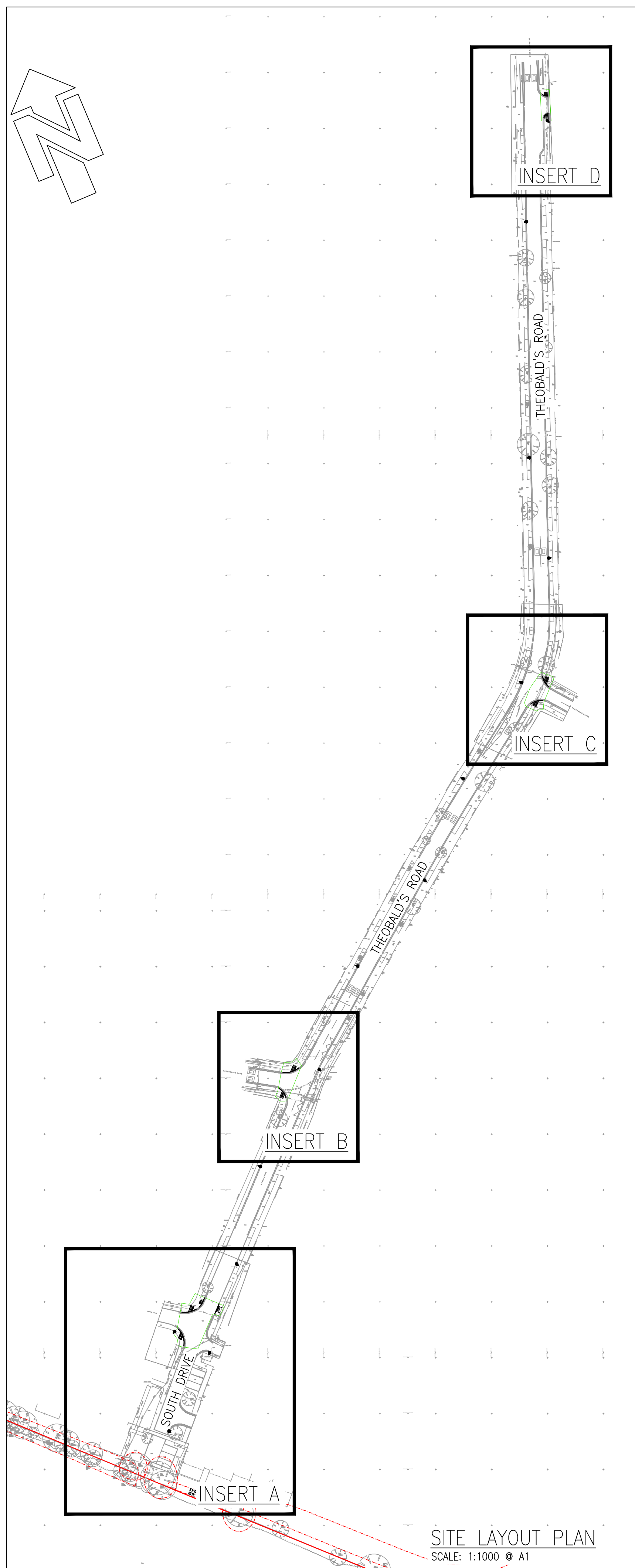
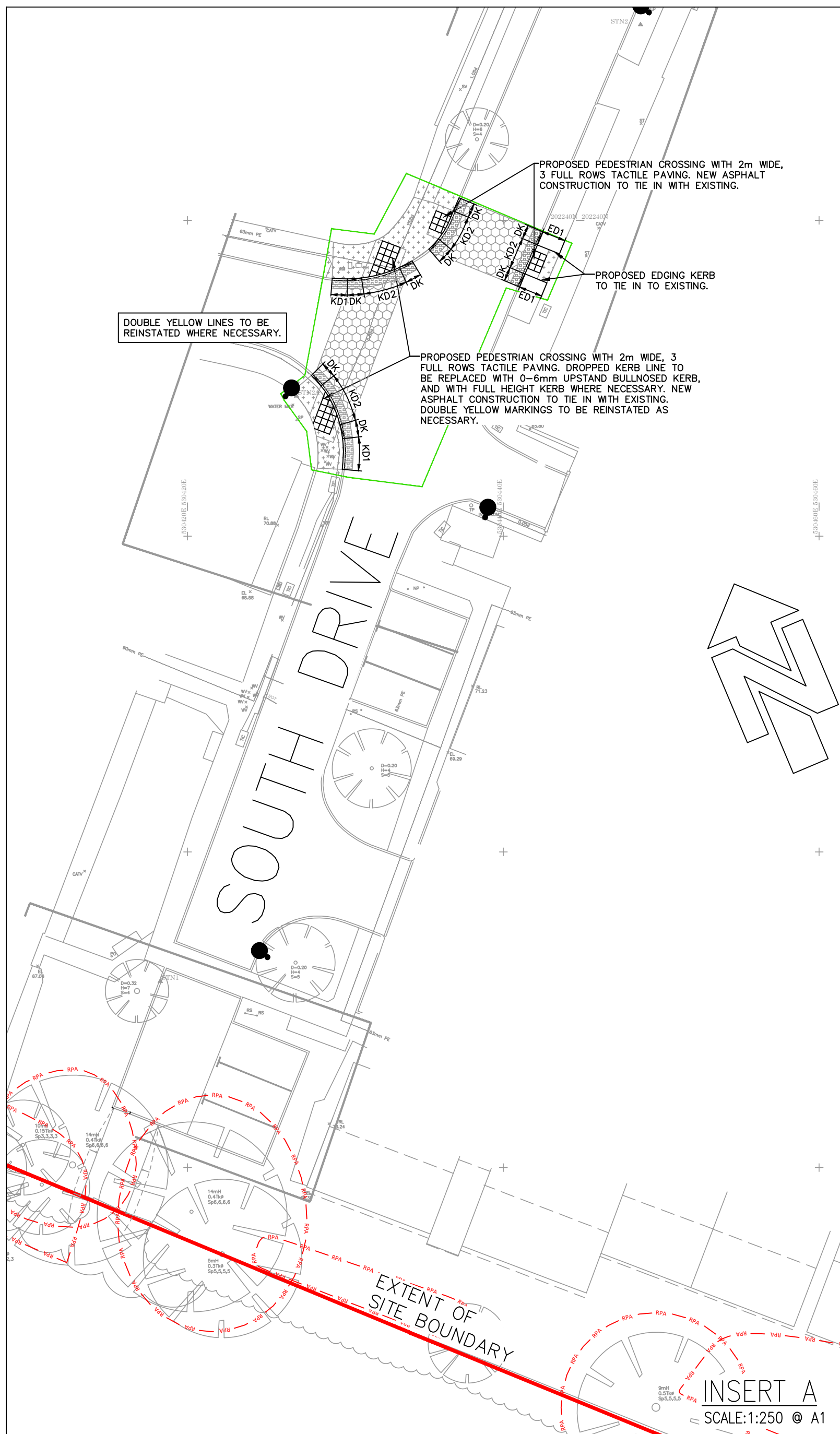
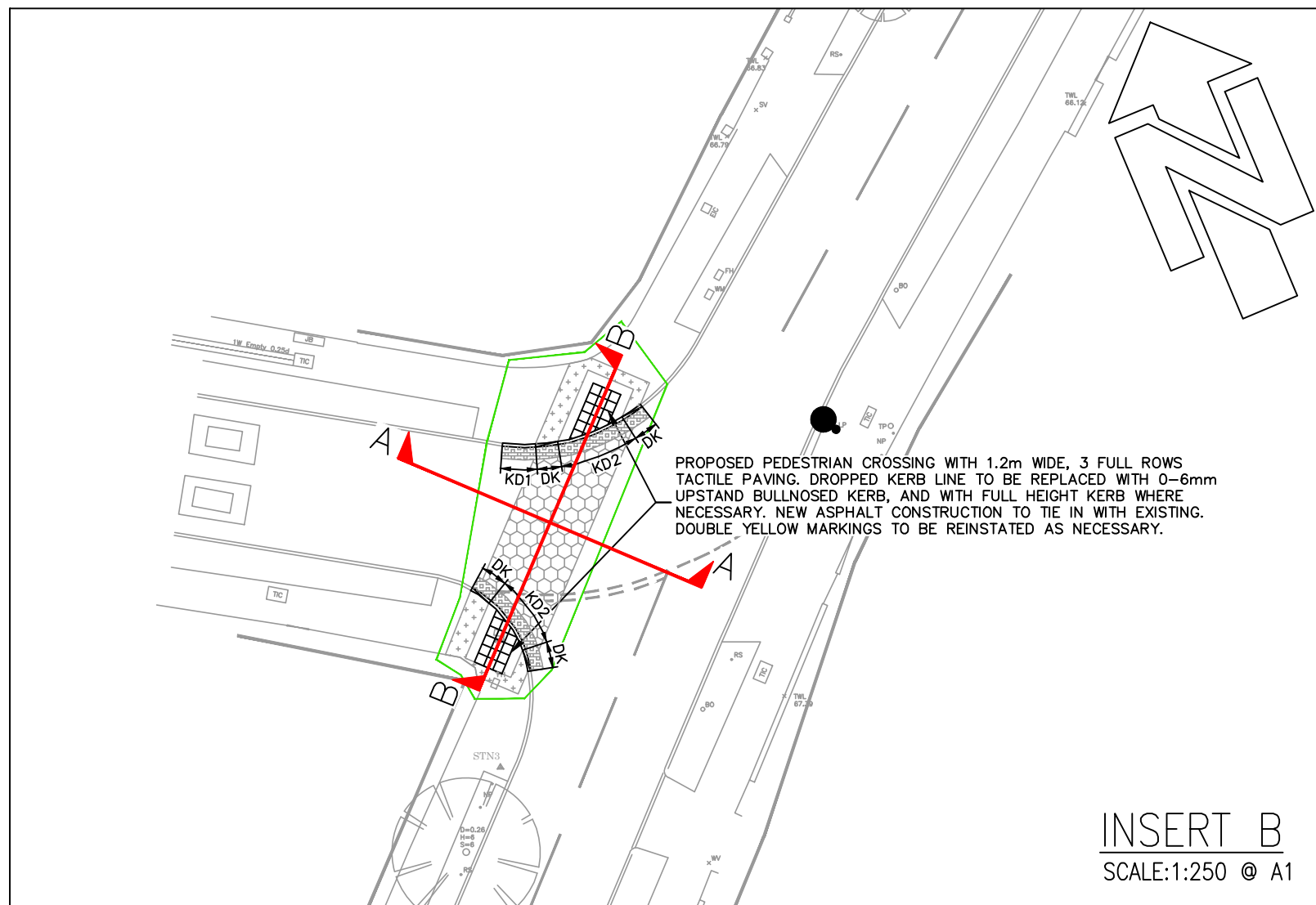
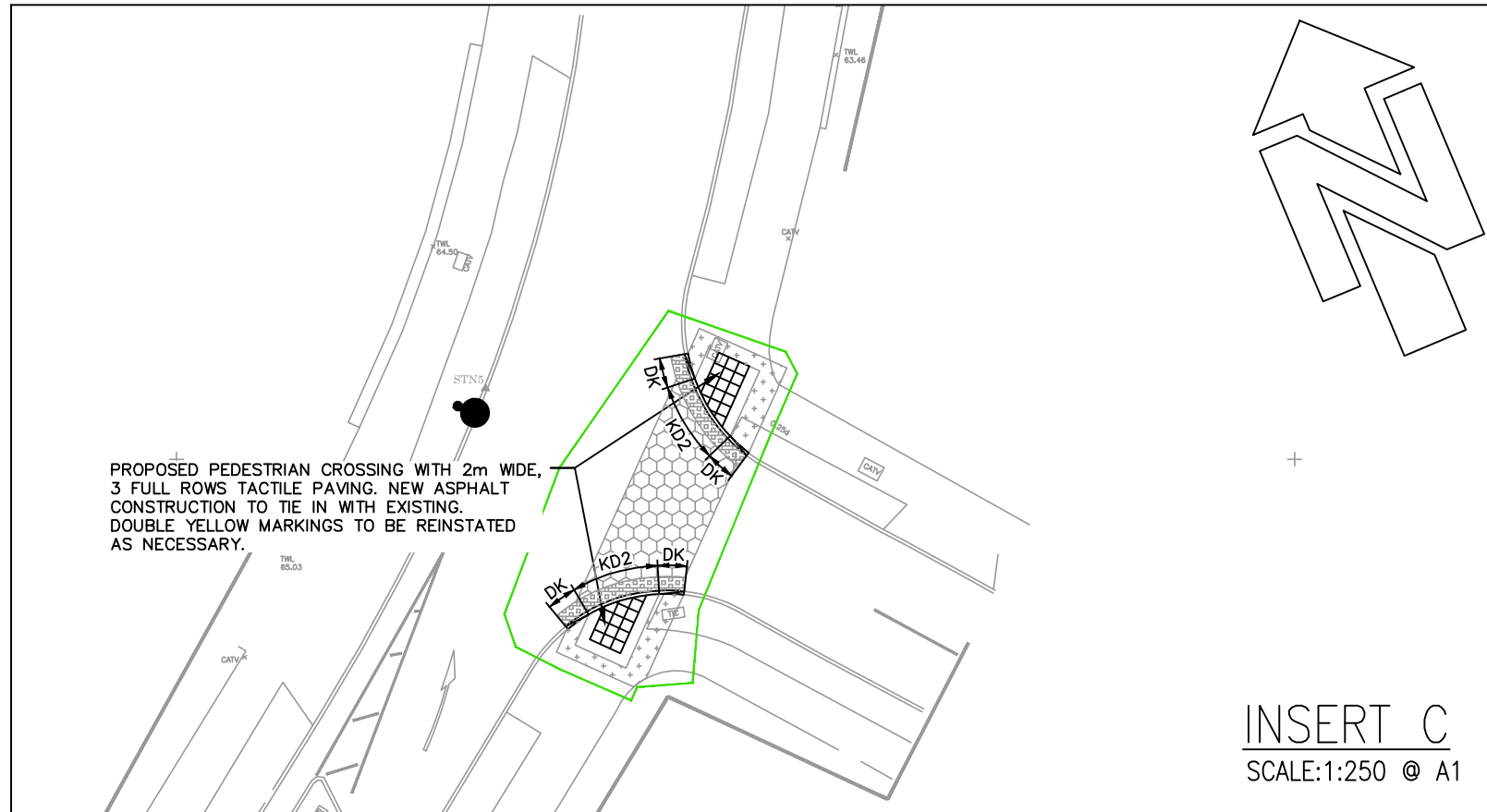
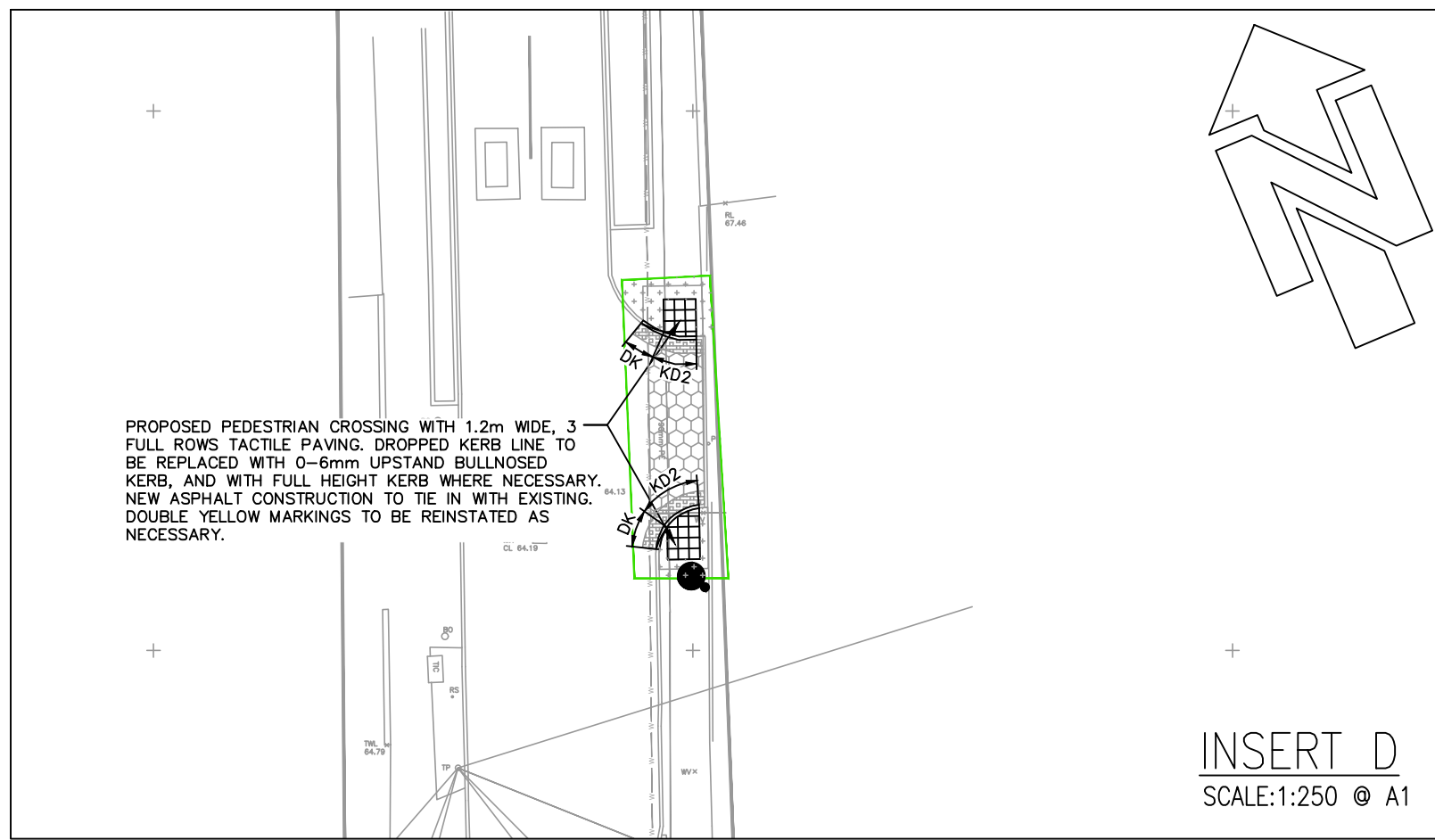

NO	REVISION	BY	DATE
C	DRAWING UPDATED TO SUIT LATEST HCC COMMENTS	JL	15.04.24
B	S278 BOUNDARY UPDATED	AJM	03.02.23
A	CYCLEPATH LINK REMOVED	AJM	06.01.23
-	INITIAL ISSUE	EL	30.11.22

DRAWING STATUS
APPROVAL

DRAWING TITLE
S278 THEOBALD'S ROAD - SURFACE FINISHES PLAN

PROJECT
NORTHAW ROAD EAST, CUFFLEY

Unit B10
Elmbridge Court Business Park
Gloucester, GL3 1JZ
T: 01452 309 727
E: mail@simpsoneng.com
W: www.simpsoneng.com

London, Henley-on Thames and Gloucester

Drawn	Chkd	Scale	Date
EL	AU	1:250 UNO	JAN 2023

Purpose of Issue
FOR APPROVAL

Project Number	Drawing Number	Revision
P22-772	71	C