

# AIRBORNE FIBRE SAMPLING & ANALYSIS CERTIFICATE



**Client** Daleraven Ltd

**Address** 11 Elder Way, Slough, Berks, SL3 6EP

**Site address** Borne Group, Campus West Car Park, The Campus, Welwyn, AL8 6BX

**Analysis Location** Site \*

**Report No:** 220804/969134/JE/15072  
0221524

**Attention of:** N/A

**Sample Date:** 15/07/22

**Analysis Date:** 15/07/22

**Issue Date:** 15/07/22

Microscope ID	01068	Service due	25/11/22	Exposed filter diameter (mm)	22	NPL band resolution	5	Graticule diam (µm)	98	Page	1
Flowmeter S/N	04200   04201	Timer S/N	04805	Counter S/Ns	04161   04163	NPL test slide no.	04162	Stage mic. S/N	04160	of	2
Cal due	06/09/22   06/09/22	Cal due	25/11/22	Check due	25/11/22   25/11/22	Cal due	25/11/22	Cal due	25/11/22		

Sample No.	Test Type*	Location	Pump No.	Cowl No.	Time			Indicated flow rate (L/min)			Intermediate		Volume (litres)	Fibres	Fields	Calculated Result f/ml	Reported result f/ml
					Start	Finish	Total	Start	Finish	Mean	Time	Flow					
01	FB	Field Blank	N/A	00031	12:58	N/A	N/A	N/A	N/A	N/A	N/A	N/A	N/A	not required as no elevated fibre levels.			
02	R	campus west Car park	04931	02142	13:00	13:32	32.0	15.0	15.0	15.0	N/A	N/A	480.0	3.0	200	0.002	<0.01
03	R	campus west Car Park	04940	00201	13:01	13:33	32.0	15.0	15.0	15.0	N/A	N/A	480.0	2.0	200	0.001	<0.01

No more tests

\*Test type L=Leak, R=Reassurance, C=Clearance, B=Background, P=Personal, N=Near source static, F=Far source /Perimeter, FB=Field Blank

**ISSUING OFFICE:** romford MF200BG      **ANALYST:** James Emmings      **SIGNATURE:**

**SOCOTEC Asbestos Limited, Bretby Business Park, Ashby Road, Burton upon Trent, Staffordshire, DE15 0Y; Tel: 01283 554499**      **AAM-Air V02 Oct-17**

Sampling and analysis carried out following internal procedures SCI/ASB/005 for airborne fibre sampling and SCI/ASB/006 for airborne fibre counting based on the main procedural points of HSE guidance document HSG248 'Asbestos: The analysts' guide for sampling, analysis and clearance procedures. The opinions and interpretations indicated are outside the scope of our UKAS accreditation.

# AIRBORNE FIBRE SAMPLING SITE DIAGRAM



<b>Clearance Details:</b>	Asbestos Type	N/A	Number of test required	2	Enclosure area (m2)	0	Dust disturbance method	N/A
	Enclosure volume	0 m3	Enclosure intact?	N/A	Enclosure dry?	N/A	Dust disturbance duration	0 min

**Description of Work:** Reassurance air monitoring following the excavation of suspect asbestos cement debris

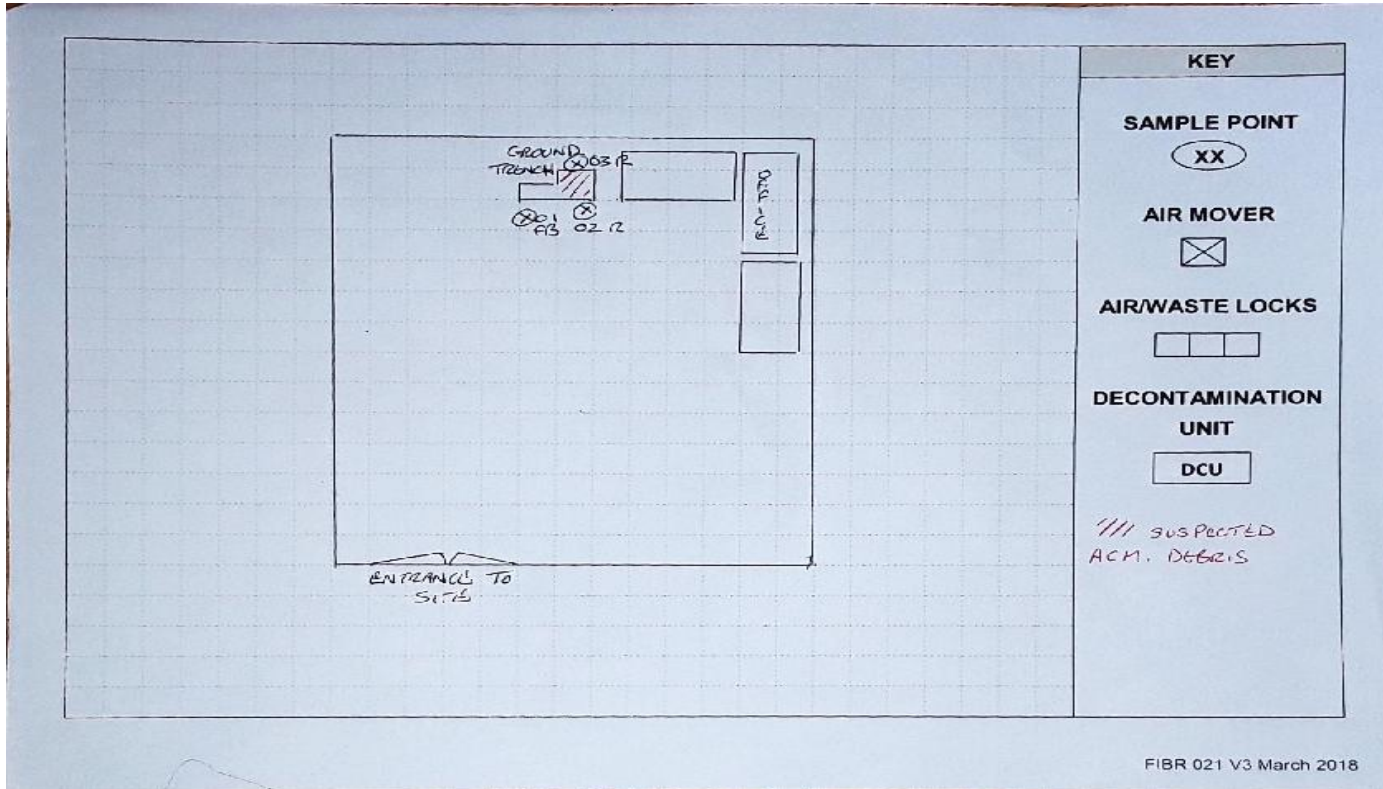

Contractor: N/A

Analyst: James Emmings

**NOTE: DIAGRAM NOT TO SCALE**

AAM-Air V02 Oct-17

This document shall not be reproduced except in full, without written approval of SOCOTEC Asbestos Ltd  
 SOCOTEC Asbestos Limited, Bretby Business Park, Ashby Road, Burton upon Trent, Staffordshire, DE15 0YZ

Tel: 01283 554499