

DWL 03

# Proposed Block Plan

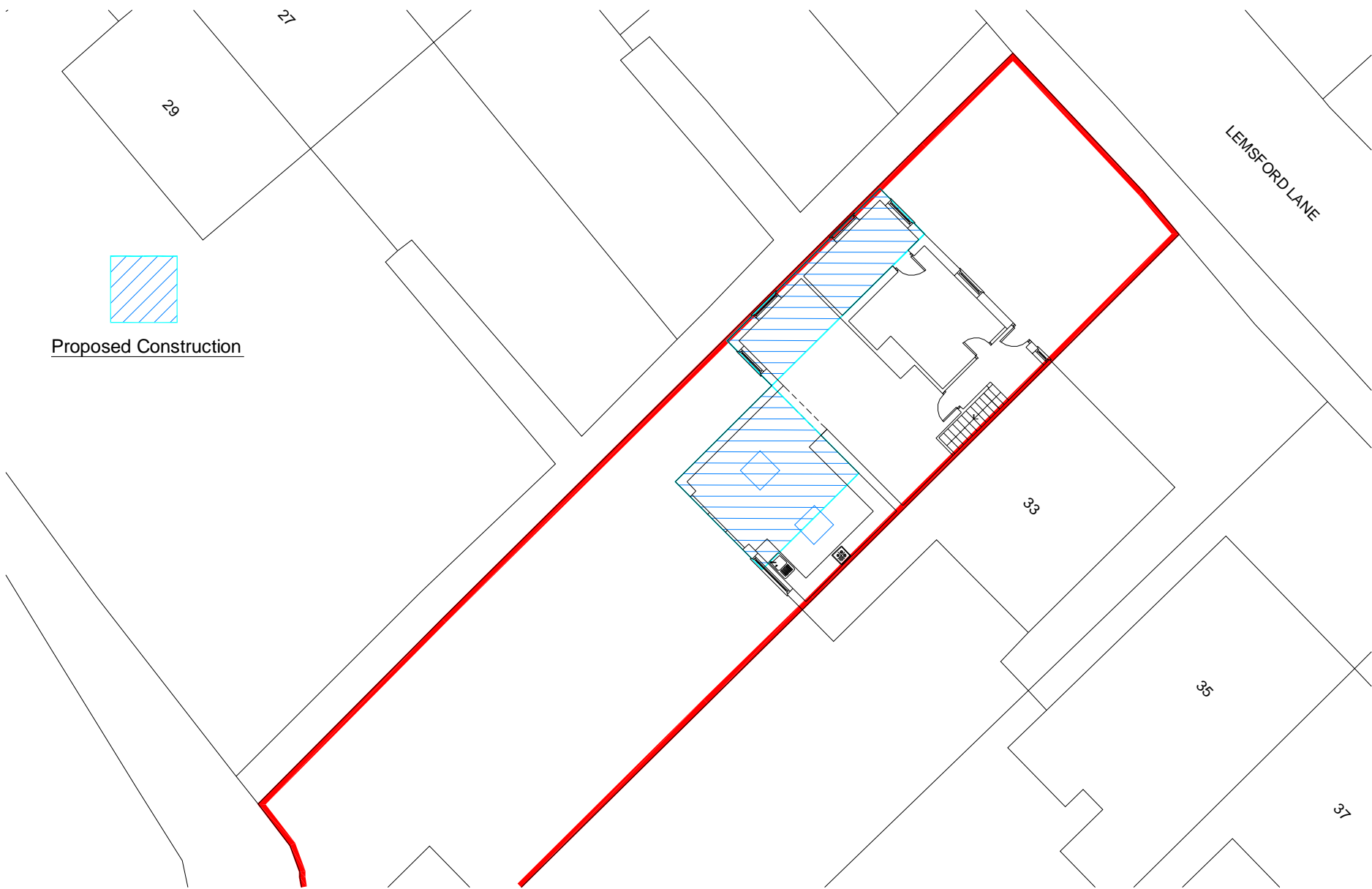
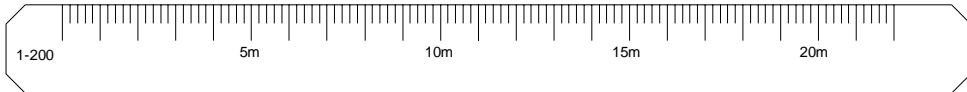

01273 311229  
[www.justplans.net](http://www.justplans.net)

e: [joseph@justplans.net](mailto:joseph@justplans.net)  
 e: [james.smith@justplans.net](mailto:james.smith@justplans.net)  
 e: [info@justplans.net](mailto:info@justplans.net)

Terms of Service relating to Just Plans and its clients:

The precise positioning of any structures, boundaries, easements or rights of way described within any plan we produce should be checked by the owner or the grantor of the rights or their authorised agents. The accuracy of any lines drawn within any plan provided by JustPlans, including boundary lines pertaining to any physical structures, private land, publicly maintained land and rights of way, is strictly subject to the clear and direct provision of such information by the client or their solicitors or agents. In the event of error, or in the event of no such provision, JustPlans accepts no liability for loss arising as a result of any inaccurate or incorrect description of the positioning of physical structures or routes of any such boundaries, easements or rights of way.

Just Plans is a trading name of Just Plans Limited, company number 10113657.

31 Lemsford Lane  
 Welwyn Garden City  
 AL8 6YN

N



Scale 1-200

Paper Size: A4

Rev - J O'Neill