

FIRST FLOOR
Gross Internal Floor Area

86 m² /
935 sq.ft

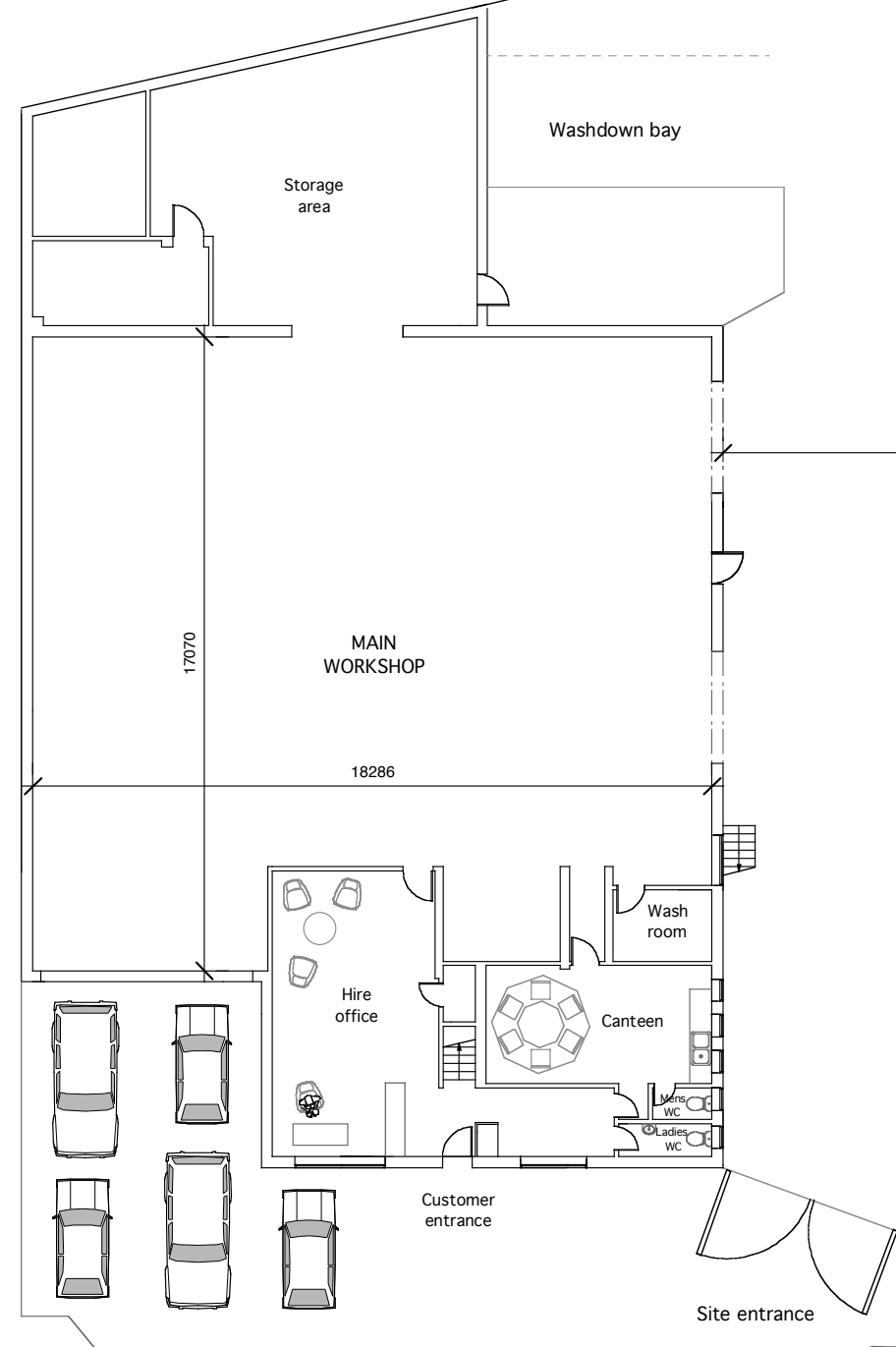

GROUND FLOOR
Gross Internal Floor Area

457 m² /
4,919 sq.ft

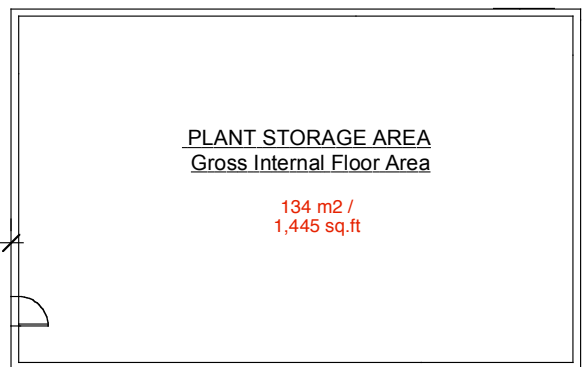

PLANT STORAGE AREA
Gross Internal Floor Area

134 m² /
1,445 sq.ft

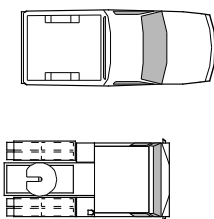

Staff / Customer parking area

Commercial vehicles parking area

YARD

YARD

Public highway

SITE PLAN

Site Area = 2,342 Sq Metres
0.58 Acres

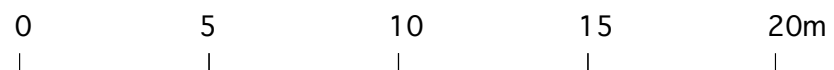

Scale bar

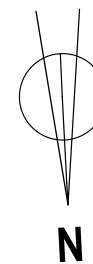

ADDRESS	12 Southfield Little Burrow Welwyn Garden City AL7 4ST
SCALE	1 : 200 /A3
DATE	April 2021
DRAWING NO	SFD/03