

Scale 1:750

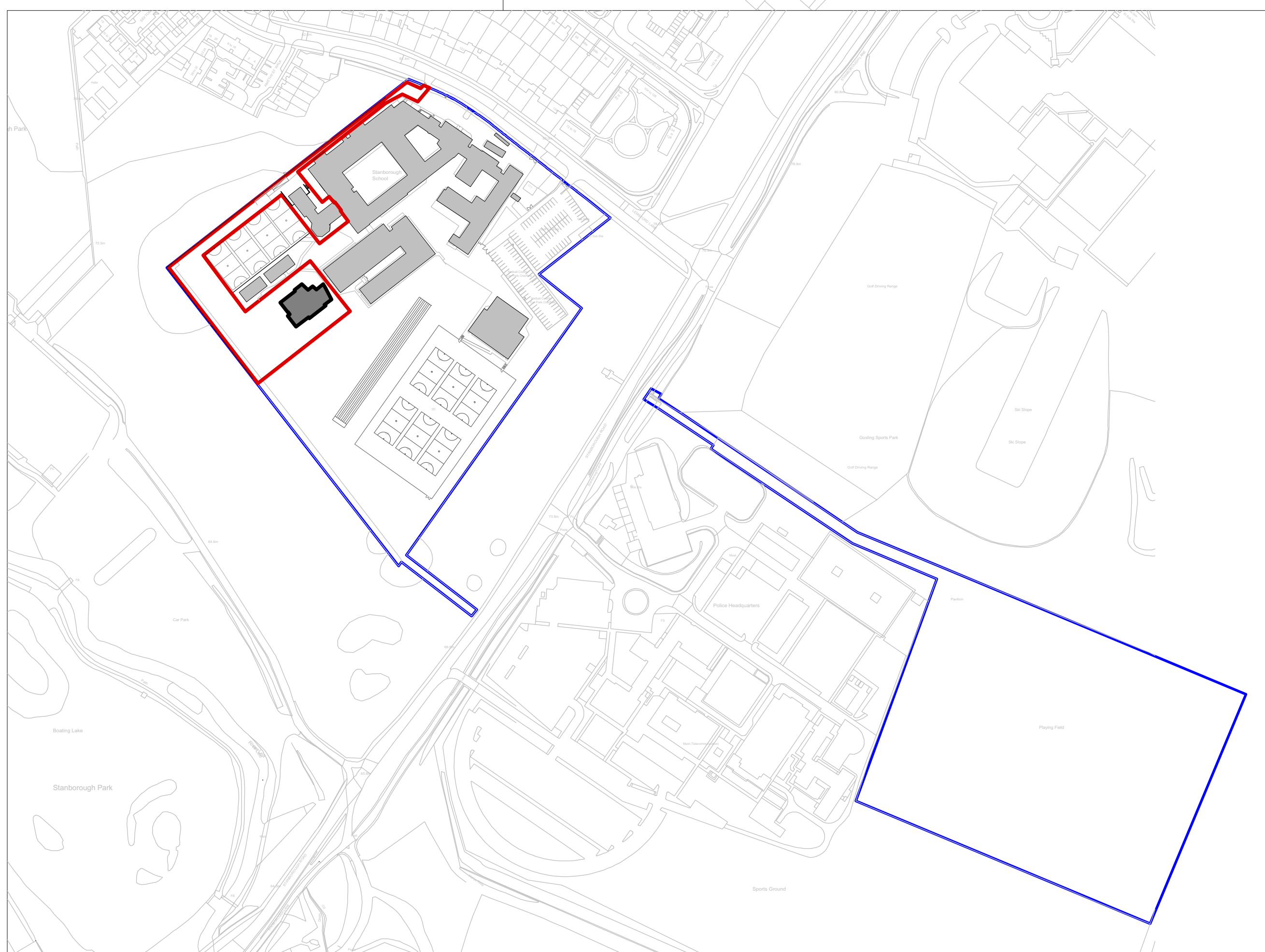

Scale 1:2500

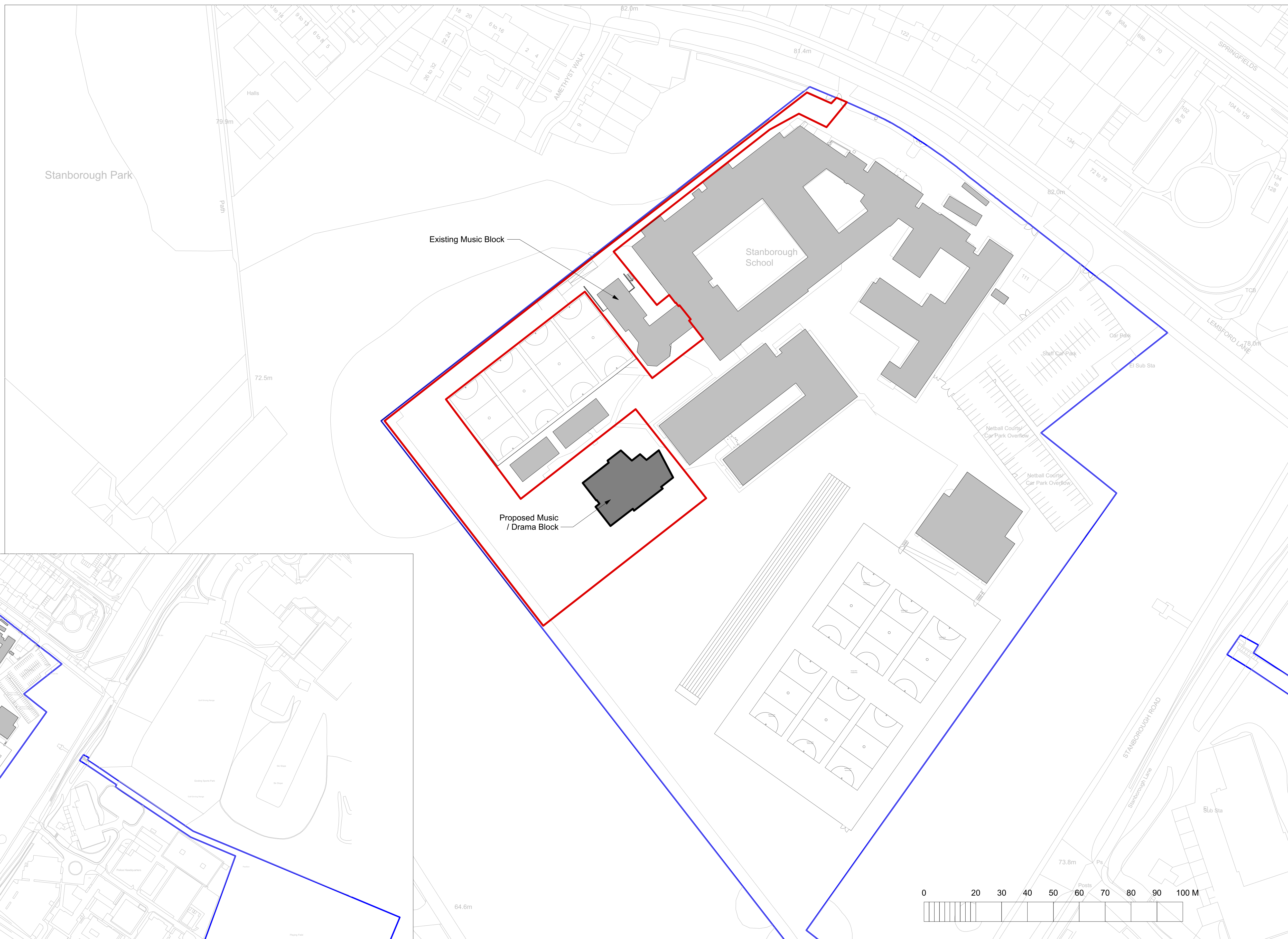
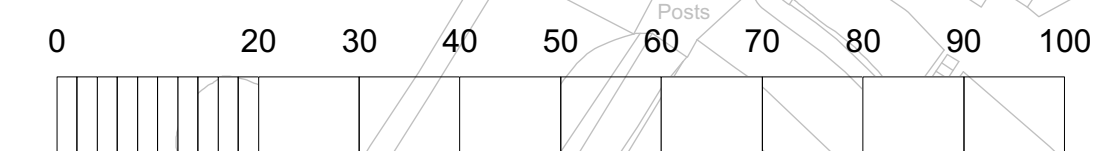

Rev.	Date	Notes	By	Chk
A	Oct '19	Scales revised to WHBC requirements	SB	SB
-	Oct '19	Issued for S73 Approval	-	-

Clouded Areas Indicate revisions since last issue

Lyster Grillet & Harding

Architect
 1 Pemberton Place
 Cambridge CB2 1XB
 01223 351626
 01223 366604

admin@lgharchitects.com
 www.lgharchitects.com
 Copyright © 2017 Lyster Grillet & Harding Ltd All rights reserved.

job title
**Stanborough School
 ESFA CIF BID 19/20**

date	drawn	scales	scales@A3
Nov '18	JC	1:750 @ A1	1:1500 @ A3
		1:2500 @ A1	1:5000 @ A3

client
Governors of Stanborough School

building + drawing title
**Proposed Music & Drama Block
 Location Plan**

work stage
**Technical Design
 Approval**

drawing status
2142 / 04 / 0001

job no. + work stage + building + drawing no.

revision
A