

Rev. No.	Date	Amendment	Initial
Rev C1	07.05.19	Construction Issue	PJH
Rev C2	21.05.19	Acoustic insulation added to relevant partitions.	GC
Rev C3	30.07.19	Condensate pipe drainage to boilers noted and living room electrics adjusted as client requirements.	GC
Rev C4	12.08.19	LivingKitchen/dining to plot 22 revised to move boiler to kitchen, cavity fire stops changed to T shape and flat entrance doors aligned with inner face of wall. Downlights removed from plot 22 bathroom.	GC
Rev C5	29.08.19	Cooker space indicated with gas point & switched fused spur, in accordance with the clients requirements.	PJH
Rev C6	20.09.19	Weather compensator note added adjacent to boiler locations. Air leakage rate adjusted.	GC
Rev C7	12.11.19	Boiler cupboard dimensions added to Plots 21 & 22.	GC
Rev C8	19.11.19	Radiator positions & thermostats updated to accord with heating designs.	PJH
Rev C9	08.01.20	Communal electrics removed and noted added to refer to heating designs.	PJH
Rev C10	28.07.20	Canopy indicated over communal entrance.	PJH

SYMBOL	DESCRIPTION
13 AMP/TWIN SWITCHED SOCKET OUTLET	
13 AMP/TWIN SWITCHED SOCKET OUTLET WITH USB OUTLET	
13 AMP SWITCHED SOCKET OUTLET	
13 AMP SOCKET OUTLET	
13 AMP/TWIN SWITCHED SOCKET OUTLET ABOVE WORKTOP	
13 AMP/TWIN SWITCHED SOCKET OUTLET ABOVE WORKTOP WITH USB OUTLET	
13 AMP SWITCHED SOCKET OUTLET ABOVE WORKTOP	
13 AMP SOCKET OUTLET ABOVE WORKTOP	
MULTI GRID SWITCH ABOVE WORKTOP CONTROLLING UNLOCKED SOCKETS BELOW WORKTOP & FAN ROOST SWITCH	
13 AMP SPUR UNIT	
13 AMP SWITCHED SPUR UNIT	
ONE WAY SWITCH	
TWO WAY SWITCH	
TELEPHONE POINT	
TELEVISION POINT	
FIBRE OPTIC ENTRY POINT	
COOKER SWITCH (DOWN ABOVE FFL)	
CONSUMER SERVICE LINE, SEM RECESSED WHERE REQUIRED (SWITCHES POSITIONED BETWEEN 1350-1450MM ABOVE F.F.L.)	
SHOWER POINT AS SITE SPEC	
CEILING LIGHTING POINT - PENDANT TYPE WITH ENERGY EFFICIENT LAMP	
CEILING LIGHTING POINT - BATTEN TYPE WITH ENERGY EFFICIENT LAMP	
RECESSED SPARSHOOF ENERGY EFFICIENT DOWNLIGHTER OR LED, REFER TO 'M' SPECIFICATION	
DOWN LIGHTERS, ENERGY EFFICIENT OR LED, REFER TO 'M' SPECIFICATION	
WALL MOUNTED LIGHTING POINT	
WALL MOUNTED LIGHTING POINT WITH FIRE SENSOR	
LED OR LEDV PO DRAW LIGHT FITTING ON MOTION SENSORS	
SPARSHOOF IP60 FITTING WITH ENERGY EFFICIENT LAMP (TO BE IP65 ABOVE BATHS & SHOWERS)	
CENTRAL HEATING PROGRAMMER & DIM TIMER (Cylinder Only)	
PROGRAMMER TEMPERATURE SENSOR (Cylinder Only)	
PROGRAMMABLE ROOM THERMOSTAT	
DECENTRALISED CONTINUOUS RUNNING EXTRACT FAN	
RECYCLING COOKER HOOD	
3 POLE ISOLATOR SWITCH FOR EXTRACT MARKED WITH FAN SYMBOL	
CENTRAL HEATING WIRING JUNCTION BOX	
RADIATOR	
SMOKE DETECTOR	
HEAT DETECTOR	
CO ALARM TO BE WALL MOUNTED, AT A HEIGHT GREATER THAN THE HEIGHT OF ANY DOOR OR WINDOW OPENING, BUT AT LEAST 150mm FROM THE CEILING, AT A HORIZONTAL DISTANCE OF BETWEEN 1-3m FROM THE EDGE OF THE FUEL BURNING APPLIANCE, ALARM NOT TO BE FITTED IN A STORE/CLOSET, DIRECTLY ABOVE A SINK/COVER OR NEXT TO A DOOR/FAN/DOOR OR ANYWHERE THAT COULD BE AFFECTED BY DRAUGHTS. NOTE: ALL SMOKE DETECTORS TO BE ADJUSTED WITH THE GAS SAFE REGISTERED ENGINEER.	
SOC POINT	
SHOWER HEAD	
LOOKABLE TAP TO BIN STORE	
AUDIO ENTRY SYSTEM TO SPECIALIST DESIGN	
LEGEND	
CEILING MOUNTED EXTRACT FAN	BER = BOILER
CL = GAS METER	E = ELECTRIC METER
SW = FAN WATER PIP	SVP = SOL VENT PIPE
AW = AIR EXHAUST VALVE	VP = 75 DRIP VENT PIPE
APPROVED DOCUMENT PART C (2009) EDWARDS	
(1) THERMOSTATIC MIXING VALVE DEVICE TO BE FITTED TO BATH IN ACCORDANCE WITH APPROVED DOCUMENT C (Apr 2010)	
(2) WATER USAGE WILL NOT EXCEED 125 LITRES PER PERSON PER DAY TO COMPLY WITH APPROVED DOCUMENT C (Apr 2010)	
PLEASE REFER TO:	
SECTION 03 - EXTERNAL WALLS (FULL FILL)	
SECTION 05 - INTERNAL WALLS	
FROM THE 'M' NATIONAL CONSTRUCTION SPECIFICATION FOR HOUSES & LOW RISE APARTMENTS	
VENTILATION REQUIREMENTS	
SYSTEM 3 TO BE VIA DECENTRALISED CONTINUOUS MECHANICAL EXTRACT FAN/EXTRACT COOP FAN TO COMPLY WITH APPROVED DOCUMENT C, PART 5.19, AIR EXHAUST PIPES TO BE SET AT A DETAIL OF 4m <sup>3</sup> /h/m <sup>2</sup> of floor area.	
NOTE: IN A BATHROOM/EN-SUITE (no window) - BOOST VIA LIGHT SWITCH WITH BUILT IN HUMIDISTAT & TIMER.	
NOTE: IN BATHROOM/EN-SUITE (with window) - BOOST VIA BUILT IN HUMIDISTAT & TIMER PLUS MANUAL BOOST SWITCH/NOV LIGHT SWITCH.	

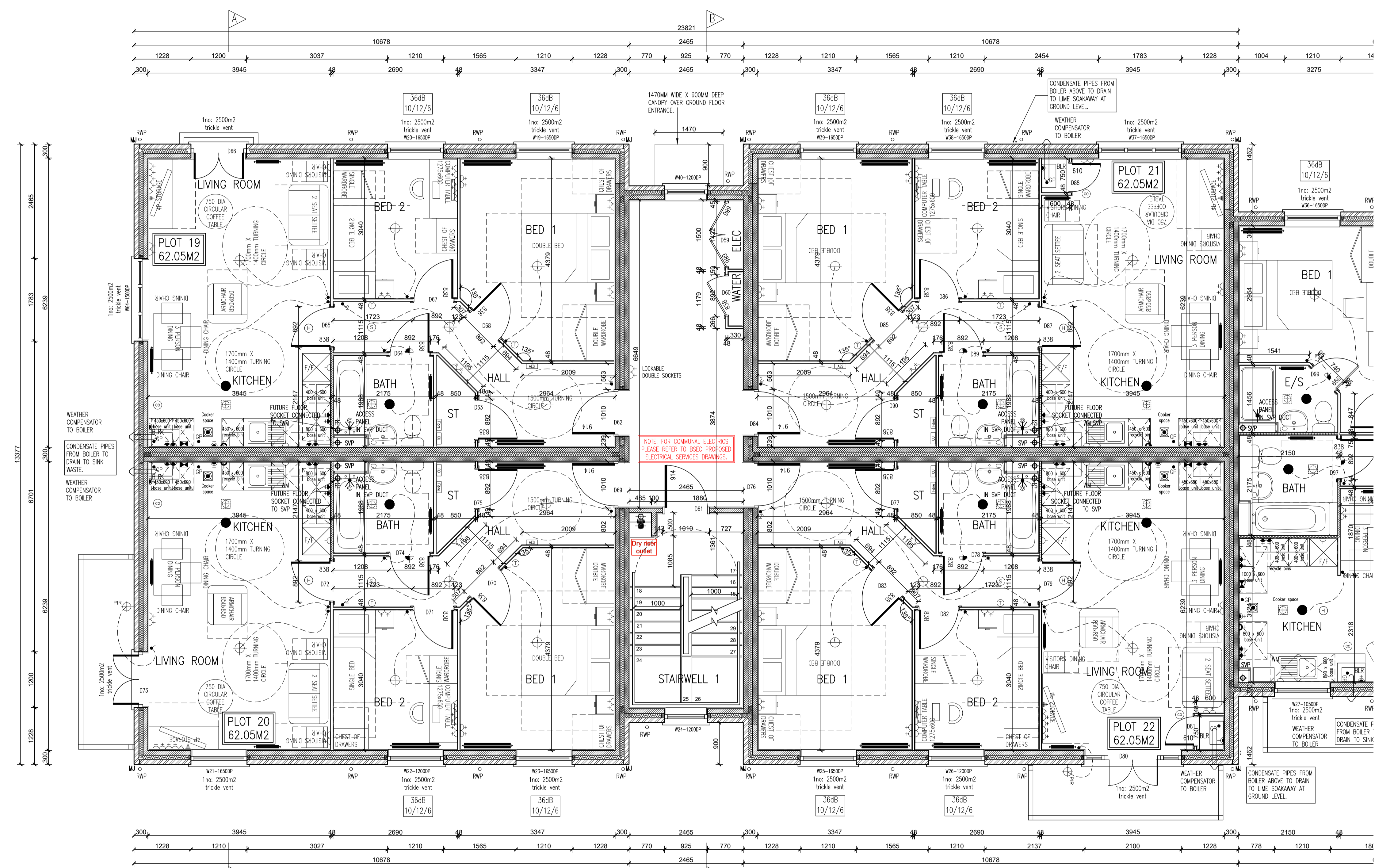

FIRST FLOOR PLAN

BRICK/BLOCKWORK LEGEND	STUDWORK LEGEND
External Walls	STUD PARTITION - 80MM OVERALL THICKNESS COMPRISING 63.5MM TWISTED STUD WITH 12.5MM PLASTERBOARD EITHER SIDE - WHEN REFERRED TO METAL STUD REFER TO 'M' No. 01/14/01/14 FOR METAL STUD SETTING OUT GUIDANCE
103mm FACING BRICKWORK	BATTRESS STUD PARTITION - 125MM OVERALL THICKNESS COMPRISING 75x25MM TWISTED STUD WITH 12.5MM PLASTERBOARD EITHER SIDE & FINISHED WITH 12.5MM PLASTERBOARD (SEE STD DETAIL M13-08-18)
100mm BLOCKWORK - 7.5N/m <sup>2</sup> ABOVE BLOCKWORK TO GROUND FLOOR, 3.0N/m <sup>2</sup> ABOVE BLOCKWORK TO 1ST & 2ND FLOORS DENSITY TO BE IN ACCORDANCE WITH THE CONSTRUCTION SPECIFICATION / STRUCTURAL ENGINEERS DETAILS.	ACOUSTIC STUD PARTITION (TO 'M' PART SPECIFICATION)
Party Walls	HALF HOUR FIRE RESISTANCE TO STUD PARTITION

- NOTES:
- THIS DRAWING MUST NOT BE SCALED
  - THIS DRAWING IS TO BE READ IN CONJUNCTION WITH ALL OTHER PROJECT DRAWINGS
  - ALL DETAILS AND DRAWINGS MUST BE READ IN CONJUNCTION WITH THE 'M' NATIONAL CONSTRUCTION SPECIFICATION FOR HOUSES & LOW RISE APARTMENTS.

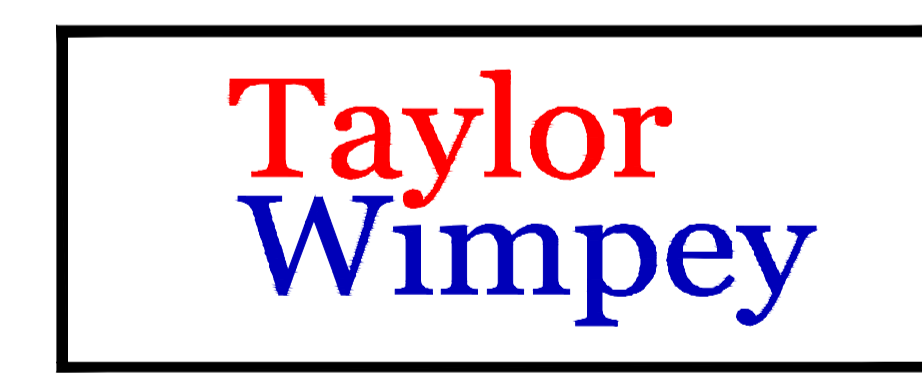

**INNOVATE**  
architectural services

Client:  
TAYLOR WIMPEY NORTH THAMES

Project:  
CHEQUERSFIELD  
WELWYN GARDEN CITY

Drawing:  
BLOCK B  
FIRST FLOOR PLAN  
SHEET 1 OF 2

Scale: 1:50 @ A1  
Date: APRIL 2018  
Checked By: GC  
Drawing No: 21188-BlockB-23  
Rev. No: C10

Taylor Wimpey	
Health, Safety & Environmental Information	
Extracted from the Significant Risk Register of the Taylor Wimpey A&Z Product Risk Assessment Document	
1. Increased risk of fall when temporary boarding & joints are removed from boarded openings when fitting glazing.	
NOTE: Contractors to discuss all risk with the Site Manager in conjunction with the TMSSE Manual before commencing work	
All works must be carried out by a competent contractor working to an agreed safe system of work which reflects the controls highlighted above	

THIS DRAWING IS A COPYRIGHT  
All dimensions to be checked on site or in the workshop before work commences.  
Only figured dimensions to be worked to. Any discrepancies to be reported to the Architect.