

Rev. No.	Date	Amendment	Initial
Rev C1	07.05.19	Construction Issue	PJH
Rev C2	21.05.19	Acoustic insulation added to relevant partitions.	GC
Rev C3	30.07.19	Condensate pipe drainage to boilers noted and living room electrics adjusted as client requirements.	GC
Rev C4	12.08.19	Living/Kitchen/dining to plot 28 revised to move boiler to kitchen, cavity fire stops changed to T shape and flat entrance doors aligned with inner face of wall.	GC
Rev C5	29.08.19	Cooker space indicated with gas point & switched boiler spur, in accordance with the clients requirements.	PJH
Rev C6	20.09.19	Weather compensator note added adjacent to boiler locations. GC Air leakage rate adjusted.	GC
Rev C7	12.11.19	Boiler cupboard dimensions added to Plots 27 & 28.	GC
Rev C8	19.11.19	Radiator positions & thermostats updated to accord with heating designs.	PJH
Rev C9	08.01.20	Communal electrics removed and noted added to refer to BSEC electrical designs.	PJH

SYMBOL	DESCRIPTION
	13 AMP TWIN SWITCHED SOCKET OUTLET
	13 AMP TWIN SWITCHED SOCKET OUTLET WITH USB OUTLET
	13 AMP SWITCHED SOCKET OUTLET
	13 AMP SOCKET OUTLET
	13 AMP TWIN SWITCHED SOCKET OUTLET ABOVE WORKTOP
	13 AMP TWIN SWITCHED SOCKET OUTLET ABOVE WORKTOP WITH USB OUTLET
	13 AMP SWITCHED SOCKET OUTLET ABOVE WORKTOP
	MULTI GRID SWITCH ABOVE WORKTOP CONTROLLING UNSWITCHED SOCKETS BELOW WORKTOP & FAN BOOST SWITCH
	13 AMP SPUR UNIT
	13 AMP SWITCHED SPUR UNIT
	ONE WAY SWITCH
	TWO WAY SWITCH
	TELEPHONE POINT
	FIBRE OPTIC ENTRY POINT
	COOKER SWITCH (1100MM ABOVE FFL)
	CONSUMER SERVICE UNIT, SWM RECESSED WHERE REQUIRED (SWITCHES POSITIONED BETWEEN 1350-1450MM ABOVE FFL)
	SHOWER POINT AS SITE SPEC
	CEILING LIGHTING POINT - PENDENT TYPE WITH ENERGY EFFICIENT LAMPS
	CEILING LIGHTING POINT - BATTEN TYPE WITH ENERGY EFFICIENT LAMPS
	RECESSED SPREADER/ENERGY EFFICIENT DOWNLIGHTER OR LED, REFER TO TM SPECIFICATION
	DOWN LIGHTERS, ENERGY EFFICIENT OR LED, REFER TO TM SPECIFICATION
	WALL MOUNTED LIGHTING POINT
	WALL MOUNTED LIGHTING POINT WITH PIR SENSOR
	LOW ENERGY 2D DRUM LIGHT FITTING ON MOTION SENSORS
	SPLASHPROOF IPRO FITTING WITH ENERGY EFFICIENT LAMP (TO BE FITTED ABOVE SINKS & SHOWERS)
	CENTRAL HEATING PROGRAMMER & DHW TIMER (Cylinder Only)
	PROGRAMMER TEMPERATURE SENSOR (Cylinder Only)
	PROGRAMMABLE ROOM THERMOSTAT
	DECENTRALISED CONTINUOUS RUNNING EXTRACT FAN
	RECALCULATING COOKER HOOD
	3 POLE ISOLATOR SWITCH FOR EXTRACT MARKED WITH FAN SYMBOL
	CENTRAL HEATING WIRING JUNCTION BOX
	RADIATOR
	SMOKE DETECTOR
	HEAT DETECTOR
	CO ALARM TO BE WALL MOUNTED AT A HEIGHT GREATER THAN THE HEIGHT OF ANY DOOR OR WINDOW OPENING, BUT AT LEAST 1500mm FROM THE CEILING, AT A HORIZONTAL DISTANCE OF BETWEEN 1-5m FROM THE EDGE OF THE FUEL BURNING APPLIANCE, ALARM NOT TO BE FITTED IN A SINK/SPLASHPROOF DIRECTLY ABOVE A SINK/COOKER OR NEXT TO A DOOR/PANIC OR ANYWHERE THAT COULD BE AFFECTED BY DRAUGHTS, NOTE: IN ALL CASES LOCATIONS TO BE AGREED WITH THE GAS SAFE REGISTERED ENGINEER.
	SHOWER HEAD
	GAS POINT
	LOCKABLE TAP TO BIN STORE
	AUDIO ENTRY SYSTEM TO SPECIALIST DESIGN
LEGEND	
	CEILING MOUNTED EXTRACT FAN
	BOILER
	GAS METER
	ELECTRIC METER
	RWP - RAIN WATER PIPE
	SWP - SWM WASTE PIPE
	AV - AIR ADMITTANCE VALVE
	WP - 75 DRY VENT PIPE
APPROVED DOCUMENT PART 2 (2009) EDIFICATION REQUIREMENTS:	
a) THERMOSTATIC MIXING VALVE DEVICE TO BE FITTED TO BATH IN ACCORDANCE WITH APPROVED DOCUMENT G (Apr 2010)	
b) WATER LEAKAGE WILL NOT EXCEED 125 LITRES PER PERSON PER DAY TO COMPLY WITH APPROVED DOCUMENT G (Apr 2010)	
PLEASE REFER TO:	
SECTION 03 - EXTERNAL WALLS (FULL FILL)	
SECTION 08 - INTERNAL WALLS	
FROM THE '16 NATIONAL CONSTRUCTION SPECIFICATION FOR HOUSES & LOW RISE APARTMENTS	
VENTILATION REQUIREMENTS	
SYSTEM 3 TO BE VIA DECENTRALISED CONTINUOUS MECHANICAL EXTRACT ENGINEERING/COOP TYPE TO COMPLY WITH APPROVED DOCUMENT F, TABLE 5.1% AIR LEAKAGE RATES TO BE SET AT A DEFAULT OF 4m ³ /hour/room.	
NOTE: INC & BRUSHWOOD/VENTS (no window) - BOOST VIA LIGHT SWITCH WITH BUILT IN HUB/SMART & TIMER.	
INC & BRUSHWOOD/VENTS (with window) - BOOST VIA BUILT IN HUB/SMART & TIMER PLUS MANUAL BOOST SWITCH (NOT LIGHT SWITCH).	

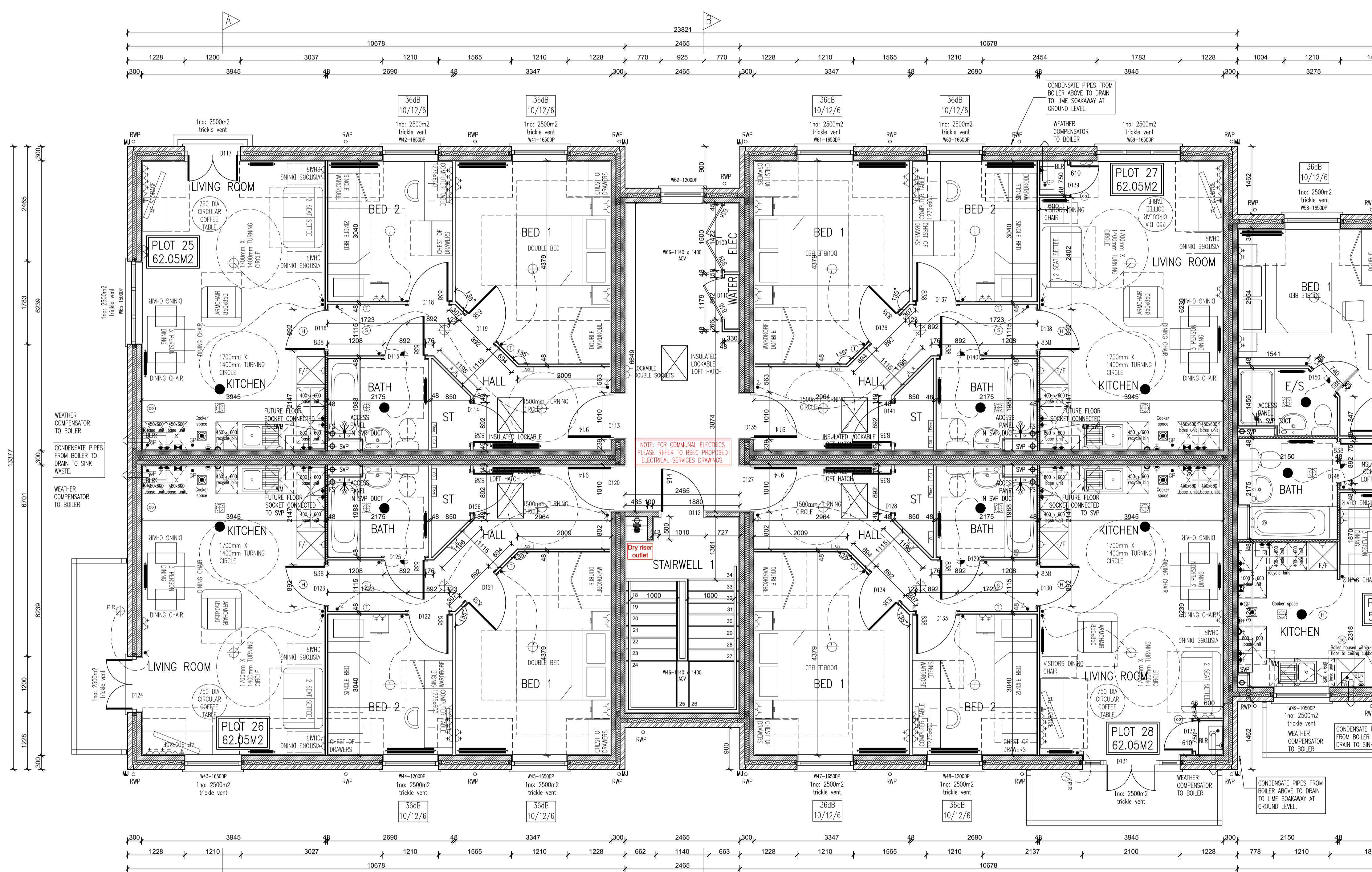

SECOND FLOOR PLAN

BRICK/BLOCKWORK LEGEND	
	External Walls
	100mm Facing Brickwork
	100mm Blockwork - 7.0N/m2
	100mm Blockwork - 3.0N/m2
	Party Walls

STUDWORK LEGEND	
	STUD PARTITION - 89MM OVERALL THICKNESS
	STUD PARTITION - 125MM OVERALL THICKNESS
	ACOUSTIC STUD PARTITION
	HALF HOUR FIRE RESISTANCE

- NOTES:
- THIS DRAWING MUST NOT BE SCALED
 - THIS DRAWING IS TO BE READ IN CONJUNCTION WITH ALL OTHER PROJECT DRAWINGS.
 - ALL DETAILS AND DRAWINGS MUST BE READ IN CONJUNCTION WITH THE '16 NATIONAL CONSTRUCTION SPECIFICATION FOR HOUSES & LOW RISE APARTMENTS'.

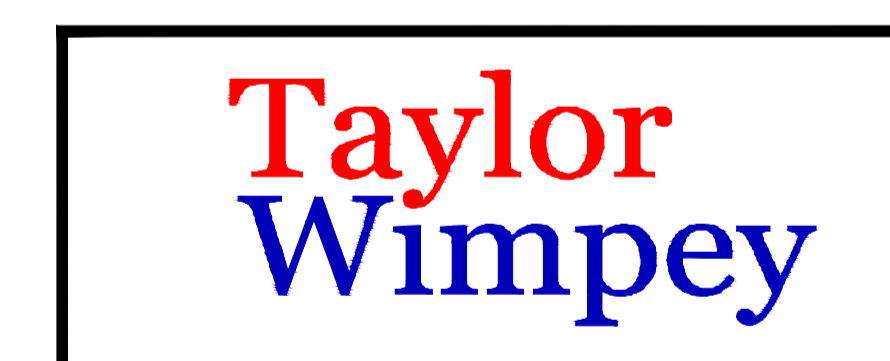

INNOVATE
architectural services

Client:
TAYLOR WIMPEY NORTH THAMES

Project:
CHEQUERSFIELD
WELWYN GARDEN CITY

Drawing:
BLOCK B
SECOND FLOOR PLAN
SHEET 1 OF 2

Scale:
SCALE 1:50 @ A1

Date:
APRIL 2018

Checked By:
GC

Drawing No:
21188-BlockB-25

Rev. No:
C9

GC Ref:
C:\TAYLOR WIMPEY NORTH THAMES\CHEQUERSFIELD

Taylor Wimpey
Health, Safety & Environmental Information
Extracted from the Significant Risk Register of the Taylor Wimpey A&Z Product Risk Assessment Document

1. Increased risk of fall when temporary boarding & joints are removed from raised openings when filling openings.

NOTE: Contractors to discuss above risk with the Site Manager in conjunction with the TMSSE Manual before commencing work.

All works must be carried out by a competent contractor working to an agreed safe system of work which reflects the controls highlighted above.

THIS DRAWING IS A COPYRIGHT
All dimensions to be checked on site or in the workshop before work commences.
Only figured dimensions to be worked to. Any discrepancies to be reported to the Architect.