

GENERAL NOTES

1. THIS DRAWING IS TO BE READ IN CONJUNCTION WITH ALL RELEVANT ARCHITECTS, ENGINEERS AND SPECIALIST DRAWINGS AND SPECIFICATIONS
2. DO NOT SCALE FROM THIS DRAWING IN EITHER PAPER OR DIGITAL FORM. USE WRITTEN DIMENSIONS ONLY
3. ALL HIGHWAY WORKS TO BE IN ACCORDANCE WITH HERTFORDSHIRE COUNTY COUNCIL SPECIFICATION
4. FOR KERBS AND SURFACING LAYOUT REFER TO DRAWING 171116-X-XX-DR-C-3400

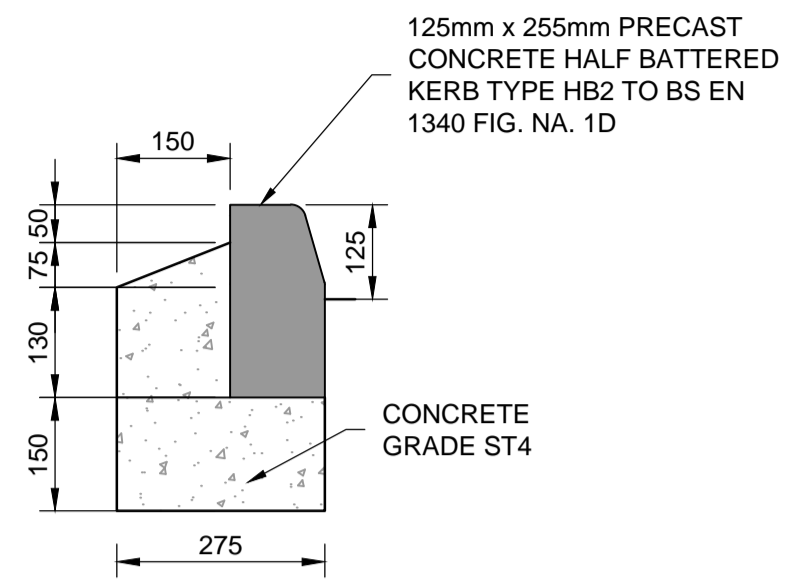

1 HB2 KERB DETAIL (HB)
Scale: 1:10

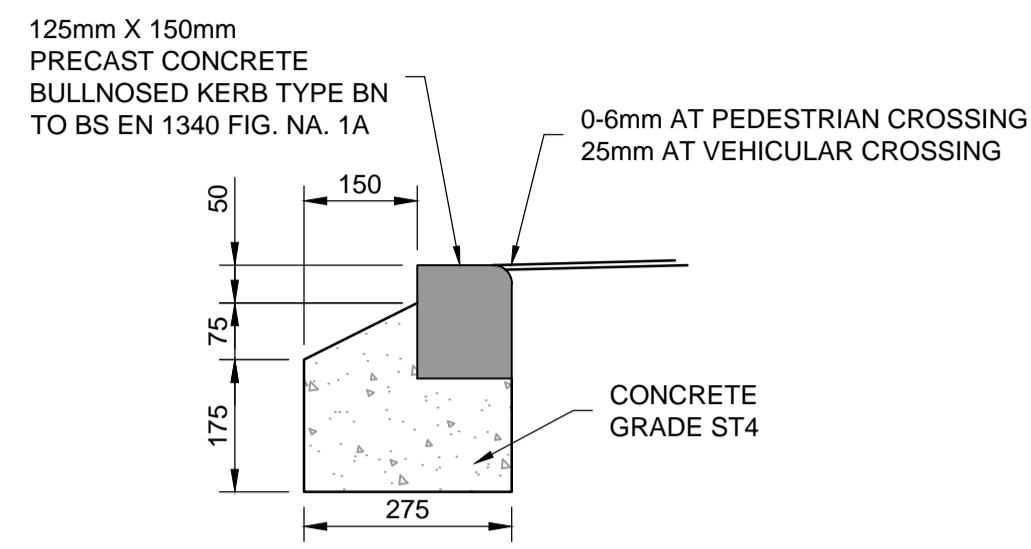

2 DROPPED KERB DETAIL (DK)
Scale: 1:10

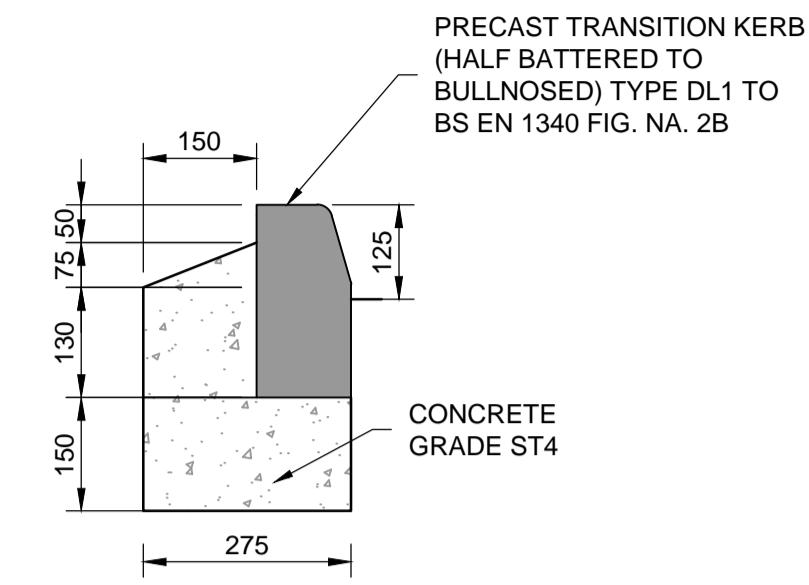

3 TRANSITION KERB DETAIL (TK)
Scale: 1:10

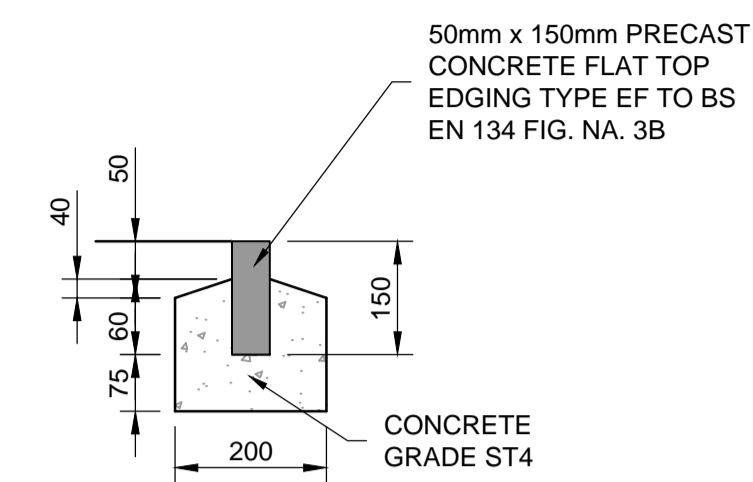

4 FOOTWAY EDGING DETAIL (EF)
Scale: 1:10

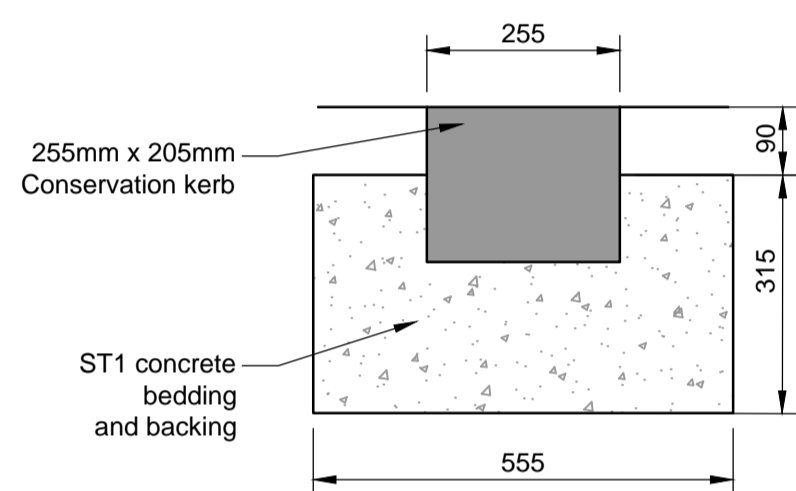

5 CONSERVATION CHANNEL DETAIL (CC)
Scale: 1:10

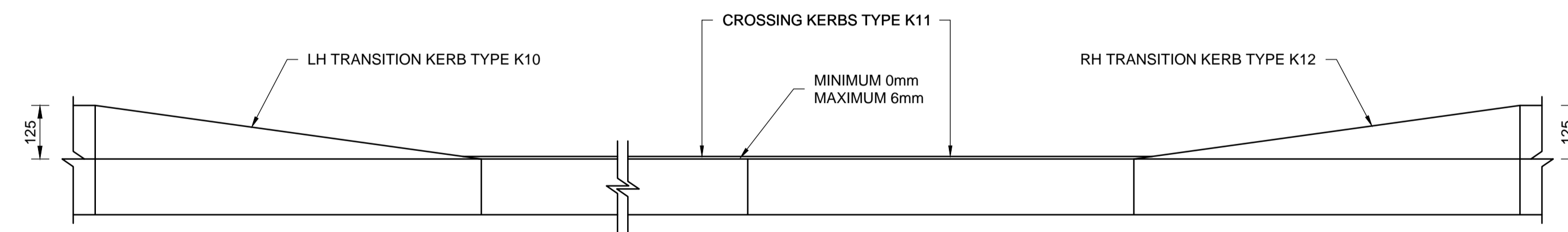
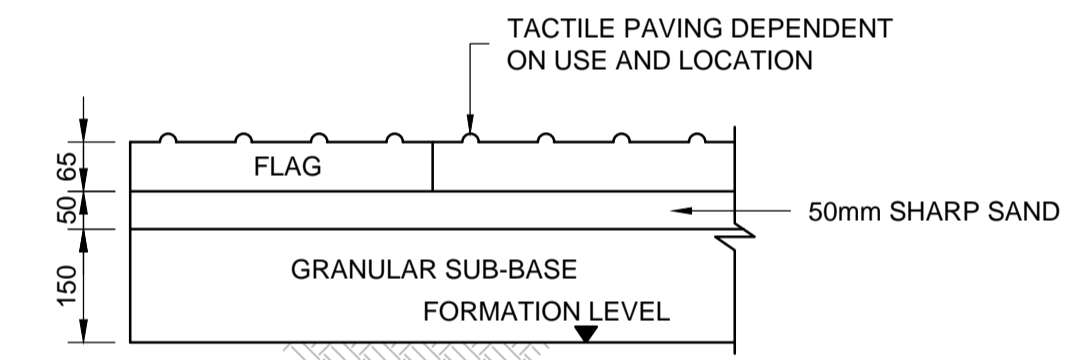
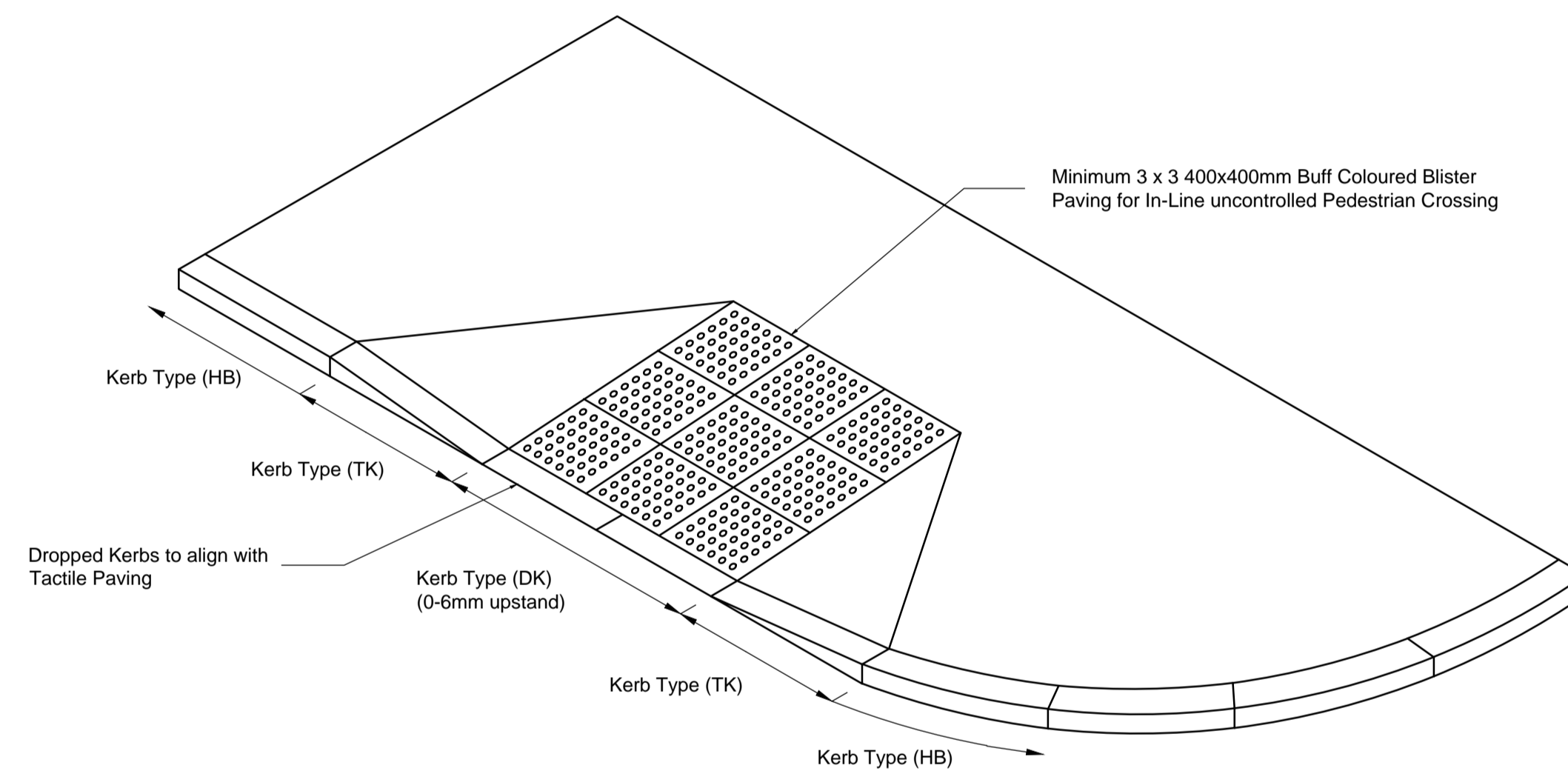

6 TYPICAL IN-LINE UNCONTROLLED PEDESTRIAN CROSSING TACTILE PAVING DETAIL
NTS

Tactile paving arrangement to be in accordance with DfT 'Guidance on the use of Tactile Paving Surfaces'

C1	21.07.20	CONSTRUCTION ISSUE	MS	JW
Rev	Date	Description	Drawn	Check

conisbee Consulting Structural Engineers
Consulting Civil Engineers

London • Cambridge • Norwich
1-5 Offord St London N1 1DH
Telephone 020 7700 6666
www.conisbee.co.uk

Drawing Status		CONSTRUCTION	
Project	STANBOROUGH PARK SPLASHLANDS	Date	MAR 2020
Scale	AS SHOWN@A1	Drawn	MS
Title	HIGHWAY CONSTRUCTION DETAILS - SHEET 1 OF 2	Engineer	JW
Project No	171116	Revision	C1
Drawing No	171116-X-XX-DR-C-3460		