

NOTES FOR HYDROBRAKE :

- HYDRO-BRAKE TYPE = MD4
- MAX DESIGN OUTFLOW = 5 L/S
- DESIGN HEAD = 1.70
- CHAMBER TO BE LOCATED AS DETAILED WITH 1200mm DIA. PC RINGS.
- PIPE ENTERING HYDRO-BRAKE TO BE 150mm DIA
- HYDROBRAKE TO HAVE EYE BRACKET AND PULL HANDLE PROVIDED FOR BYPASS DOOR OPERATING ROPE. HANDLE TO BE LOCATED BELOW AND ADJACENT MANHOLE COVER.
- ACCESS TO BE POSITIONED DIRECTLY ABOVE HYDRO-BRAKE.
- REFER TO SPECIALIST SUPPLIER AND MANUFACTURER FOR FINING AND SEALING DETAILS.

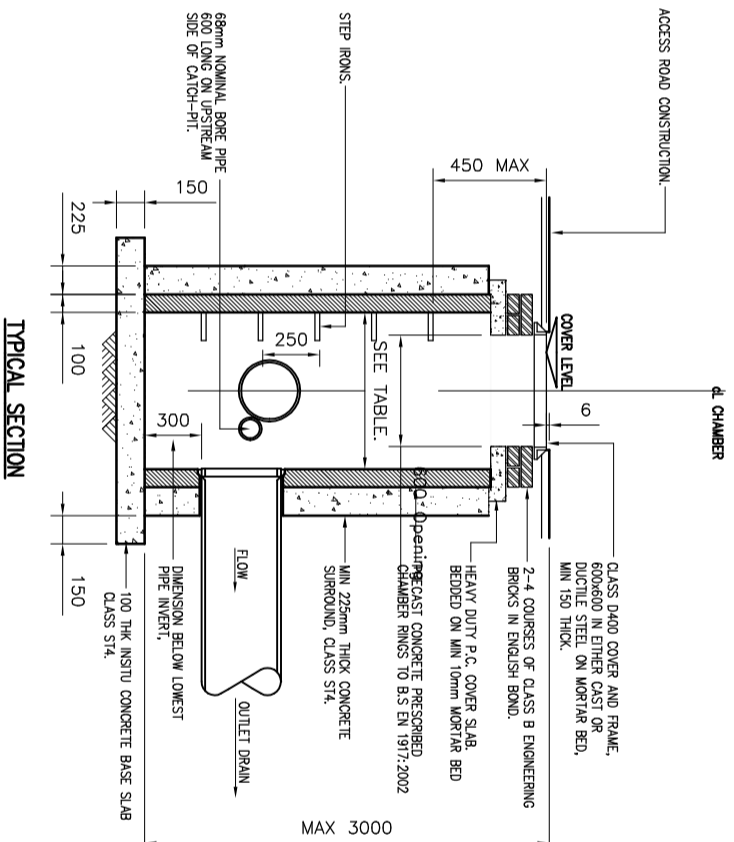

PRECAST CONCRETE CATCHPIT MANHOLE (CP) ADOPTABLE TYPE WITHIN CARRIAGEWAY.

ADDITIONAL NOTATION :-

1. MORTAR SHALL BE DESIGNATION (i) TO S.H.W. 2400 SERIES.
2. PRES SHALL BE GROUTED INTO CATCH-PITS WITH MORTAR.
3. 68mm DIA PRES, 600mm LONG SHALL BE BUILT INTO CATCHPITS TO DRAIN THE SUMP OF TRENCHES ON UPSTREAM CONNECTIONS. PIPES SHALL BE POSITIONED ABOVE ANY CONCRETE FILTER DRAIN BEDS.
4. BOTH CHAMBER TOP AND STEP RINGS SHALL BE POSITIONED SO THAT ACCESS WILL ALLOW PERSONS TO FACE ONCOMING TRAFFIC WITH S14 IN S04 SERIES.
5. FLEIBLE JOINTS ADJACENT TO PIPE CONNECTIONS SHALL COMPLY WITH S14 IN S04 SERIES.
6. PRECAST CONCRETE CATCHPIT RINGS SHALL BE OF A TYPE MANUFACTURED TO COMPRISE SULPHATE RESISTING CEMENT TO BS 4027:1996
7. THE CHAMBER TOP SHALL BE SET AS DIMENSIONED BELOW THE ADJACENT :
 a) HARD SHOULDER OF HARD-STRIP AND
 b) FINISHED GROUND LEVEL IN ALL OTHER CARRIAGEWAY LOCATIONS.
8. PRE-CAST CONCRETE CHAMBER RINGS SHOULD BE SEALED AND JOINED WITH A PROPRIETARY BITUMEN. ALL RINGS SHOULD BE SULPHATE RESISTANT.

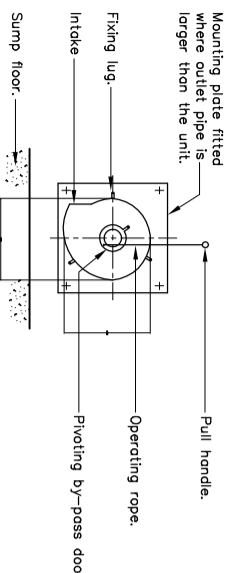
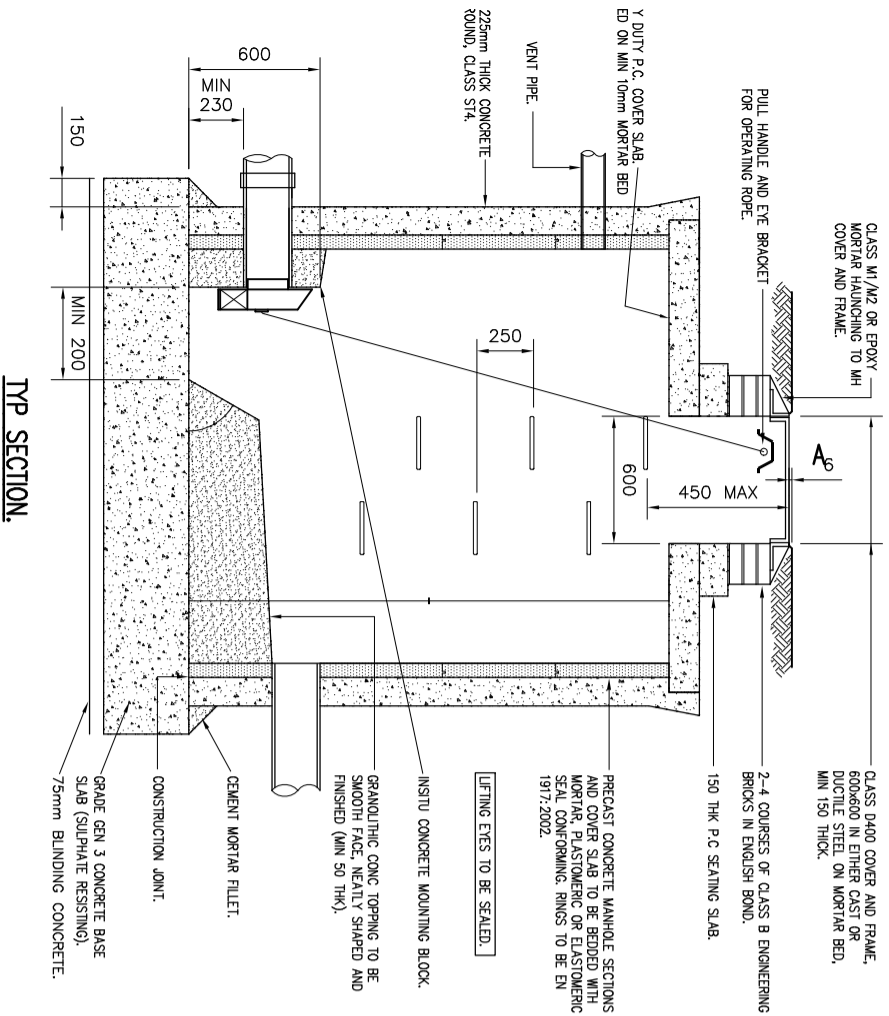

TYP ELEVATION ON HYDRO-BRAKE ORIENTATION, TYPICAL HYDRO-BRAKE MANHOLE CHAMBER DETAIL

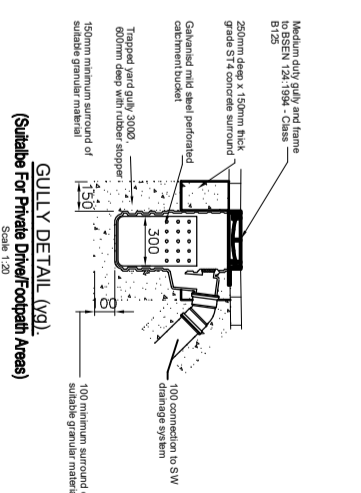
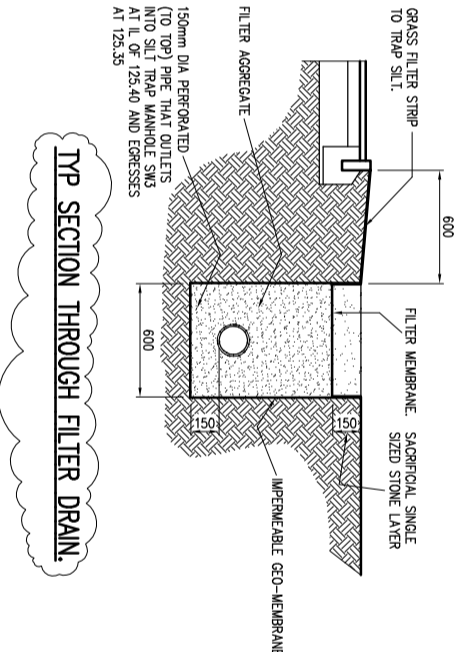

NOTES

1. FOR GENERAL NOTES REFER TO DRAWING 20-6690/300.

FOR EXTERNAL WORKS LAYOUT AND EXTENT OF SURFACE FINISHES REFER TO ARCHITECTS DRAWINGS.

NO.	REVISIONS	BY	CHKD.	DATE
A	FILTER DRAIN DETAIL ADDED.	AS	KAR	11.8.20

KEN RUSH ASSOCIATES
 STRUCTURAL & CIVIL ENGINEERS
 Bovornin House, 191 South Street
 Birmmham, Essex, CM7 2QB.
 T: 01576 325789 Fax: 01576 342711

ARCHITECT: COLBET

LYSTER GRILLET & HARDING/
 T. J. LEVRS LTD.

PROJECT
NEW SPORTS HALL BUILDING TO CHANCELLOR'S SCHOOL PINE GROVE, BROOKMANS PARK, HATFIELD, AL9 7BN.

TITLE
MISCELLANEOUS DRAINAGE DETAILS - SHEET 2.

SCALE: 1:20

DESIGNED	AS	DATE	FEB' 2020
CHECKED	KAR		

JOB NO.	20-6690	DWG NO.	302
REVISION	A		

© COPYRIGHT RESERVED AND NOT TO BE USED WITHOUT AUTHORS CONSENT.