

Rev. No.	Date	Amendment	Initial
Rev. T1	20.07.18	Tender Issue	GC
Rev. T2	19.09.18	Block strengths updated to accord with the Structural Engineers comments.	PJH
Rev. T3	27.11.18	Balcony removed from Plot 13 and replaced with Juliette balcony. Lobbies added to Plots 13 - 16. Fibre optic entry point indicated. Window added to Plot 13 Living room.	PJH

SYMBOL	DESCRIPTION
	13 AMP MIN SWITCHED SOCKET OUTLET
	13 AMP MIN SWITCHED SOCKET OUTLET WITH USB OUTLET
	13 AMP SWITCHED SOCKET OUTLET
	13 AMP SOCKET OUTLET
	13 AMP MIN SWITCHED SOCKET OUTLET ABOVE WORKTOP
	13 AMP SWITCHED SOCKET OUTLET ABOVE WORKTOP WITH USB OUTLET
	13 AMP SWITCHED SOCKET OUTLET ABOVE WORKTOP
	13 AMP MIN SWITCH ABOVE WORKTOP CONTROLLING UNSWITCHED SOCKETS BELOW WORKTOP & FAN BOOST SWITCH
	13 AMP SPUR UNIT
	13 AMP SWITCHED PUR UNIT
	ONE WAY SWITCH
	TWO WAY SWITCH
	TELEPHONE POINT
	TELEVISION POINT
	FIBRE OPTIC ENTRY POINT
	COOKER SWITCH (100MM ABOVE FFL)
	CONSUMER SERVICE UNIT, SEM RECESSED WHERE REQUIRED (SWITCHES POSITIONED BETWEEN 150-150MM ABOVE FFL)
	SHOWER POINT AS SITE SPEC
	CEILING LIGHTING POINT - PENDANT TYPE WITH ENERGY EFFICIENT LAMPS
	CEILING LIGHTING POINT - BATTEN TYPE WITH ENERGY EFFICIENT LAMPS
	RECESSED SPLASHPROOF ENERGY EFFICIENT DOWNLIGHTER OR LED, REFER TO THE SPECIFICATION
	WALL MOUNTED LIGHTING POINT
	WALL MOUNTED LIGHTING POINT WITH PIR SENSOR
	CEILING MOUNTED BULKHEAD FITTING
	SPLASHPROOF FROG FITTING WITH ENERGY EFFICIENT LAMP (TO BE FITS ABOVE BATHS & SHOWERS)
	PROGRAMMER TEMPERATURE SENSORS (Cylinder Only)
	PROGRAMMABLE ROOM THERMOSTAT
	RECYCLED/CONTINUOUS RUNNING EXTRACT FAN
	REGRATING COOKER HOOD
	3 PILE PERSONAL SWITCH FOR EXTRACT MAPPED WITH FAN SYMBOL
	CENTRAL HEATING WIRING JUNCTION BOX
	RADIATOR
	SMOKE DETECTOR
	HEAT DETECTOR
	CO ALARM TO BE WALL MOUNTED AT A HEIGHT GREATER THAN THE HEIGHT OF ANY DOOR OR WINDOW OPENING BUT AT LEAST 150MM FROM THE CEILING, AT A HORIZONTAL DISTANCE OF BETWEEN 1-3m FROM THE EDGE OF THE FUEL BURNING APPLIANCE. ALARM NOT TO BE FITTED IN A STONE/CONCRETE DIRECTLY ABOVE A SINK/COOKER OR NEXT TO A DOOR/WINDOW OR ANYWHERE THAT COULD BE AFFECTED BY SMOKE. NOTE: IN ALL CASES, LOCATIONS TO BE AGREED WITH THE GAS SAFE REGISTERED ENGINEER.
	SMOKE HEAD
	GAS POINT
	LOCKABLE EXTERNAL TAP
	AUDIO ENTRY SYSTEM TO SPECIALIST DESIGN
LEGEND	
CEM = CEILING MOUNTED EXTRACT FAN	BLR = BOLLER
G = GAS METER	E = ELECTRIC METER
RWP = RAIN WATER PIPE	SVP = SOIL VENT PIPE
AW = AIR AMBIVANCE VALVE	VP = 75 DRY VENT PIPE
APPROVED DOCUMENT PART G (2009) EXTERNAL REQUIREMENTS:	
a) THERMOSTATIC WIRING SHALL BE FITTED TO BATHS IN ACCORDANCE WITH APPROVED DOCUMENT G (Apr 2010)	
b) WATER USAGE WILL NOT EXCEED 120 LITRES PER PERSON PER DAY TO COMPLY WITH APPROVED DOCUMENT G (Apr 2010)	
PLEASE REFER TO:	
SECTION 03 - EXTERNAL WALLS (FULL FILL)	
SECTION 08 - INTERNAL WALLS	
FROM THE UK NATIONAL CONSTRUCTION SPECIFICATION FOR HOUSES & LOW RISE APARTMENTS	
VENTILATION REQUIREMENTS	
SYSTEM 4 TO BE IN RECYCLED/CONTINUOUS MECHANICAL EXTRACT FAN/GREENWELL (COSP) TYPE TO COMPLY WITH APPROVED DOCUMENT F, TABLE 5.10, AIR LEAKAGE RATES TO BE SET AT A RATE OF 10/100m³/h	
NOTE: WC & BATHROOM/ENSUITE (no window) - BOOST VIA LIGHT SWITCH WITH BUILT IN HANDSET AT TAIL	
WC & BATHROOM/ENSUITE (with window) - BOOST VIA LIGHT SWITCH WITH BUILT IN HANDSET AT TAIL	
WC & BATHROOM/ENSUITE (with window) - BOOST VIA BUILT IN HANDSET AT TAIL PLUS MANUAL BOOST SWITCH (NOT LIGHT SWITCH)	

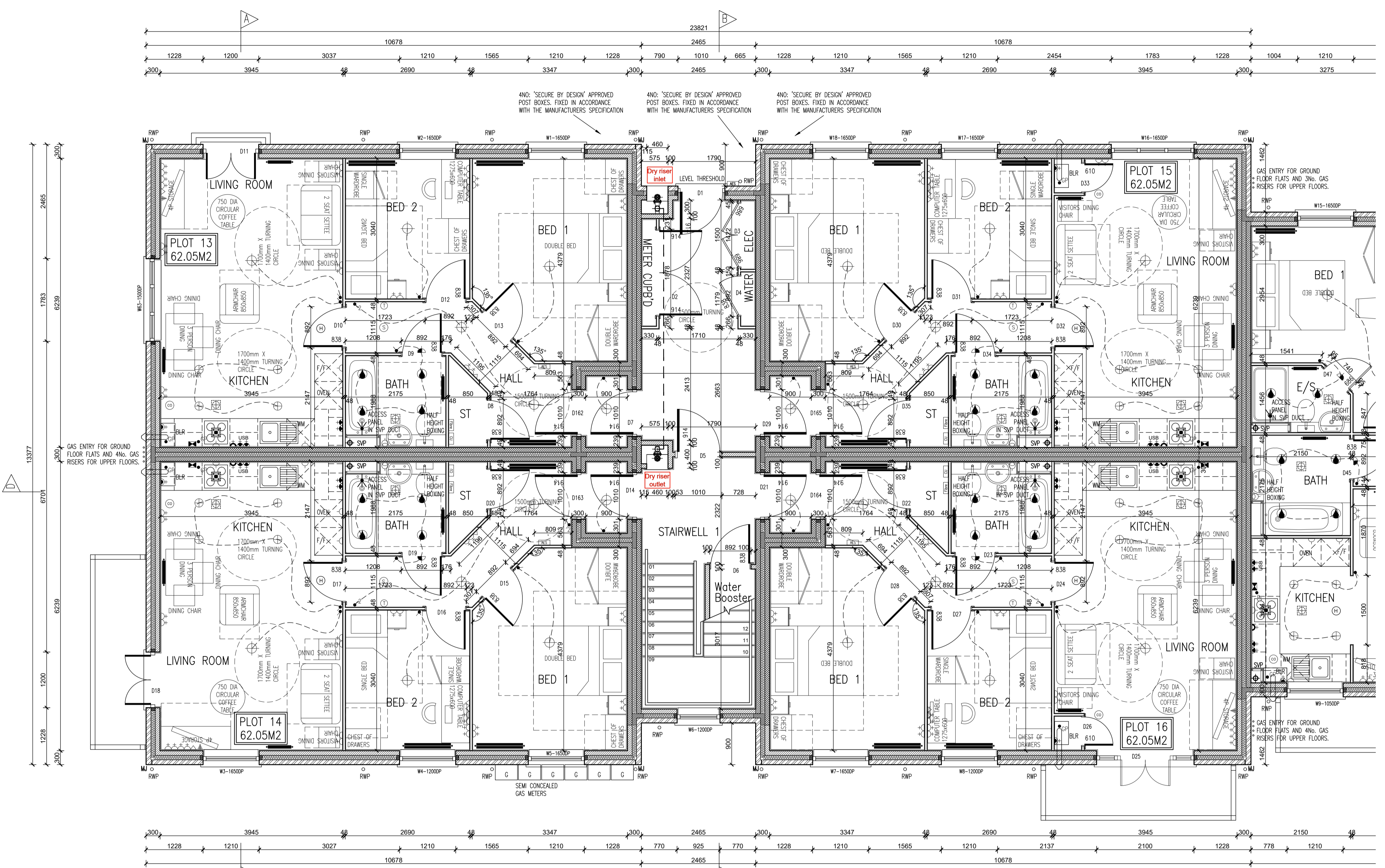

GROUND FLOOR PLAN

BRICK/BLOCKWORK LEGEND	STUDWORK LEGEND
External Walls	STUD PARTITION - 80MM OVERALL THICKNESS COMPRISING 63.5MM TAPER STUD WITH 12.5MM PLASTERBOARD EITHER SIDE - MATCH ROOFING TO MEKA. STUB REFER TO T.B. No. 014/04/14 FOR METAL STUD SETTING OUT GUIDANCE.
103mm FACING BRICKWORK	BUTTRESS STUD PARTITION - 125MM OVERALL THICKNESS COMPRISING 75.0MM TAPER STUD WITH 12.5MM PLYWOOD EITHER SIDE & FINISHED WITH 12.5MM PLASTERBOARD (SEE STD DETAIL W13-05-18)
100mm BLOCKWORK - 7.0A/mm MEDIUM DENSE SOLID BLOCKWORK TO GROUND FLOOR. 3.0A/mm LIGHTWEIGHT CONCRETE BLOCKWORK TO 1ST & 2ND FLOORS. CONSIST TO BE IN ACCORDANCE WITH THE CONSTRUCTION SPECIFICATION / STRUCTURAL ENGINEERS DETAILS.	ACOUSTIC STUD PARTITION (TO TAYLOR WIMPEY SPECIFICATION)
Party Walls	100mm BLOCKWORK - 7.0A/mm (GROUND FLOOR) & 3.0A/mm (ABOVE GROUND FLOOR) MORTARE (800-800kg/m³) FOR 1-10M-30. PLEASE REFER TO ROBERT SHAWNEE DETAILED & STRUCTURAL ENGINEERS SPECIFICATION.
	1/2 HOUR FIRE RESISTANCE TO STUD PARTITION

- NOTES:
- THIS DRAWING MUST NOT BE SCALED
 - THIS DRAWING IS TO BE READ IN CONJUNCTION WITH ALL OTHER PRODUCT DRAWINGS
 - ALL DETAILS AND DRAWINGS MUST BE READ IN CONJUNCTION WITH THE UK NATIONAL CONSTRUCTION SPECIFICATION FOR HOUSES & LOW RISE APARTMENTS.

Taylor Wimpey
Health, Safety & Environmental Information
Extracted from the Significant Risk Register of the Taylor Wimpey AA12 Product Risk Assessment Document

1. Increased risk of fall when temporary boarding & joists are removed from stairwell opening when filling staircase

NOTE: Contractors to discuss above risk with the Site Manager in conjunction with the TMSSE Manual before commencing work

All works must be carried out by a competent contractor working to an agreed safe system of work which reflects the controls highlighted above

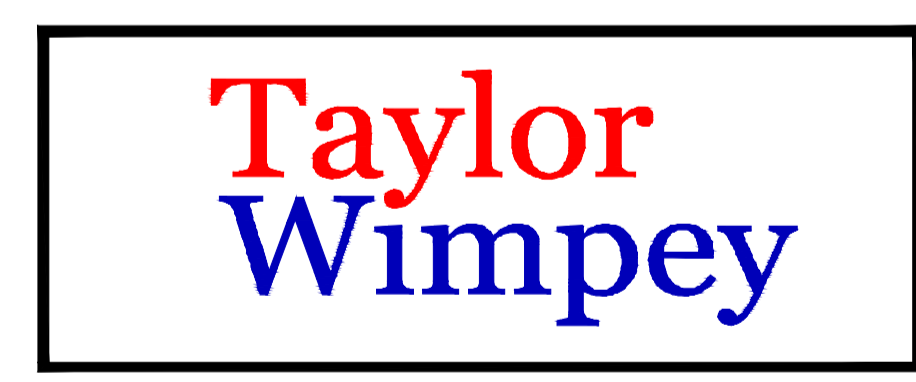

INNOVATE
architectural services

Client:
TAYLOR WIMPEY NORTH THAMES

Project:
CHEQUERSFIELD
WELWYN GARDEN CITY

Drawing:
BLOCK B
GROUND FLOOR PLAN
SHEET 1 OF 2

Scale:
SCALE 1:50 @ A1

Date:
APRIL 2018

Drawn By: GC
Checked By: GC
Drawing No: 21188-BlockB-21
Rev. No: T3

CAD Ref:
C:\TAYLOR WIMPEY NORTH THAMES\CHEQUERSFIELD

THIS DRAWING IS A COPYRIGHT
All dimensions to be checked on site or in the workshop before work commences.
Only figured dimensions to be worked to. Any discrepancies to be reported to the Architect.