

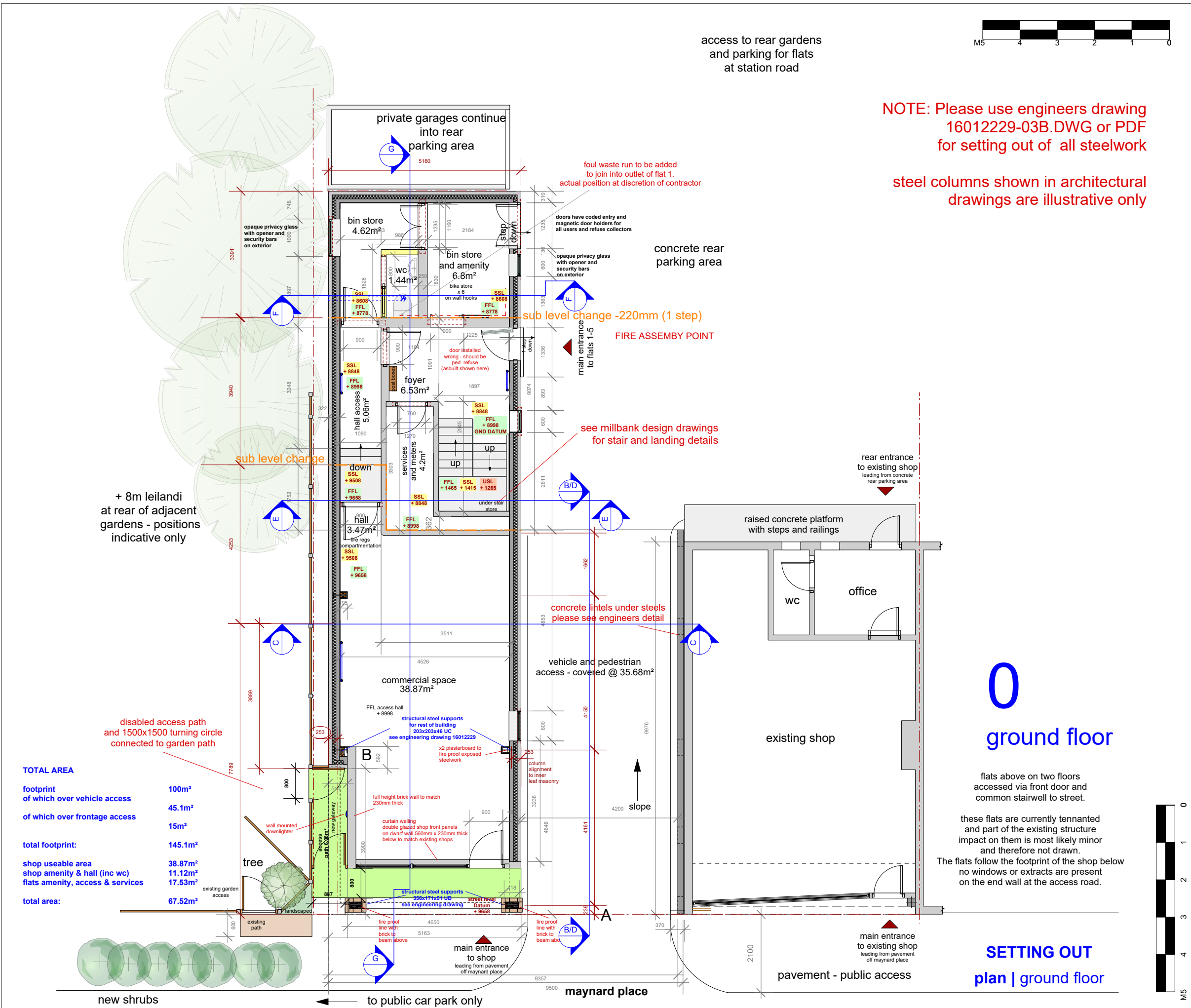

NOTE: Please use engineers drawing
16012229-03B.DWG or PDF
for setting out of all steelwork

steel columns shown in architectural
drawings are illustrative only



TOTAL AREA

| | |
|--|---------------------|
| footprint of which over vehicle access | 100m ² |
| of which over frontage access | 45.1m ² |
| total footprint: | 145.1m ² |
| shop useable area | 38.87m ² |
| shop amenity & hall (inc wc) | 11.12m ² |
| flats amenity, access & services | 17.53m ² |
| total area: | 67.52m ² |

| | | |
|----------------|---|------------------|
| project / site | maynard place, cuffley, herts | |
| client | willow city estates plc | |
| orientation | | |
| type | Construction Plan - GROUND FLOOR | |
| status | for client approval / planning / building control | |
| Revisions | Rev A1: SH - 31/may/2016 layout changes, final layout with numerous details Rev A2: SH - 6/jan/2017 setting out details and simplifications Rev: A3: SH - 8/jan/2017 north side access change, changes to ground floor shop frontage and south side wall. Rev A4: SH - 30th/03/2017 ammend rear slab level height Rev A5: SH - 28th/07/2017 ammend disable wc wall to accomadate asbuilt larger steels for access. Notes on steel under steps to overcroft Rev A6: SH - 20th/08/2017 remove disabled wc, new wc to rear Rev A8: SH - 15th/10/2017 addition of supply services and runs Rev A12: SH - 22/mar/2018 - sync to other drawings Rev A13: SH - 14/may/2018 - alter shop frontage add disabled access way | |
| drawn by | Stuart Hancock RIBA BSc (Hons) Architecture | |
| scale | 1:100 @ A3 | date 31 may 2016 |
| dwg no | 0/A100/CN/001 | rev A13 |