

**GENERAL NOTES**

All rights are Reserved by the company. No part of this work covered by the copyright hereon may be reproduced or used in any form or by any means- graphic, electronic or mechanical, including photocopying, recording, taping or information storage and retrieval systems- with explicit permission of the company proprietor.

All dimensions to be checked on site and any discrepancy to be notified to the supervising officer.

No dimension to be scaled from the drawings for construction purposes unless otherwise indicated. All work is to comply with Building Regulations including amendments made in April 2002.

Party Wall etc. Act 1996 would apply and contractor is to assure that no work is commenced until this formality is completed.

The sole purpose of this drawing is the procurement of Planning Permission and Building Regulation approval and work is NOT to commence before such approvals.

Where this drawing is used for the works, contractor should request at the time of tender, from the tenderer, full specification and schedule of work. To avoid any disputes, this schedule of works in conjunction with the drawings would be used to resolve matters.

Where this drawing is used for the works full specifications should be agreed with the tenderer to include Heating, Plumbing & other services where required.

Contractor to assure and satisfy himself that necessary Planning permission and Building Regulations are approved before tendering or commencement of works.

REVISION	DESCRIPTION	BY	DATE
P0	preliminary issue	IC	02-03-17

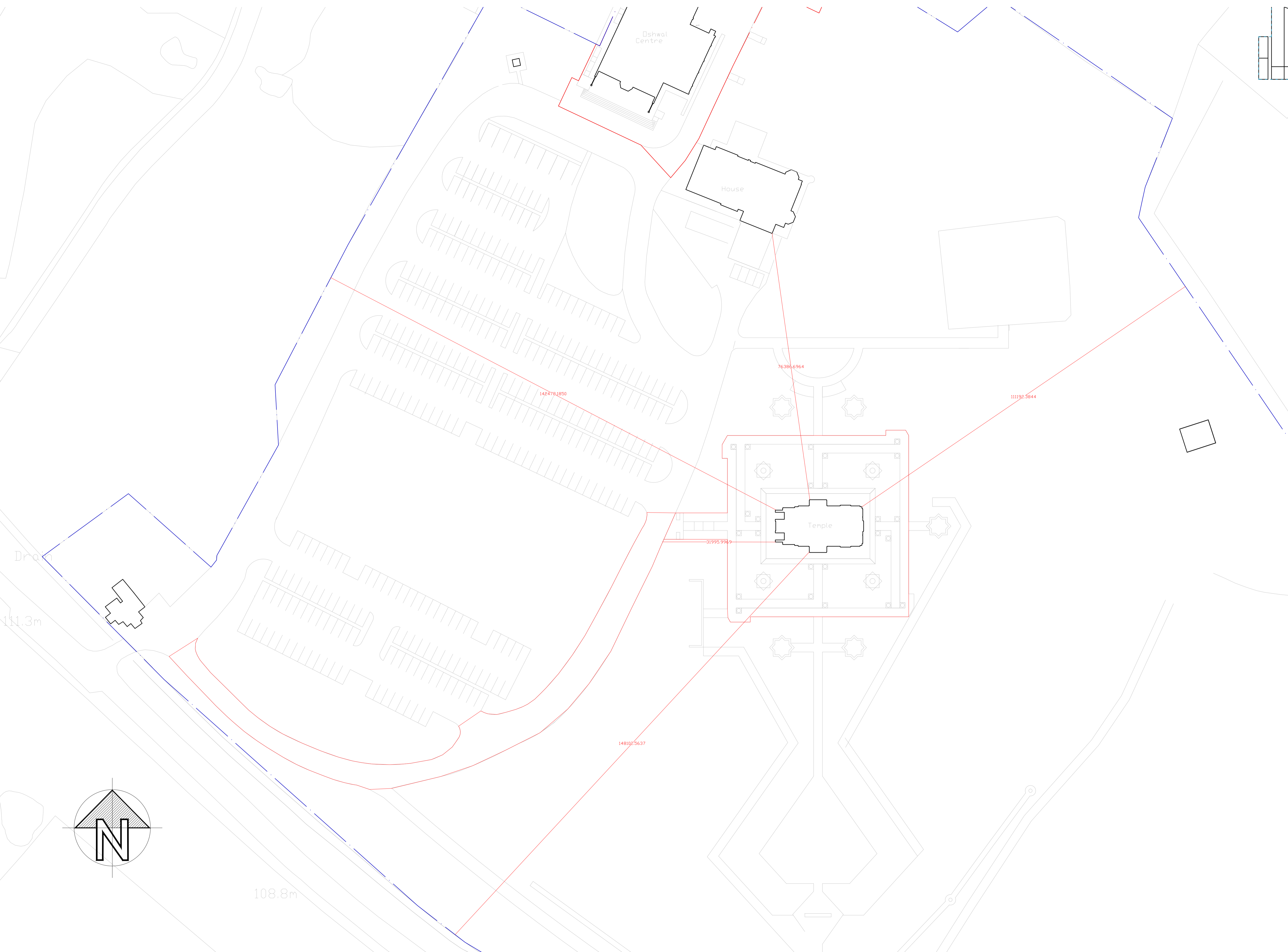

**SITE PLAN**

**PLANNING**

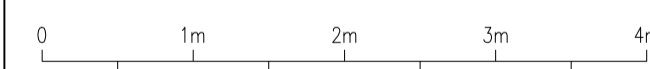
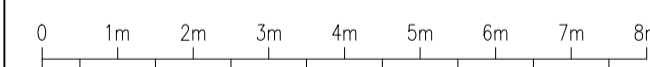

**Saloria**  
 CHARTERED ARCHITECTS  
 Unit 26 Cygnus Business Centre, Dalmeyer Road NW10 2XA  
 Tel: +44 (020) 8451 7833 +44 (020) 8459 9600  
 Fax: +44 (020) 8451 3370  
 Email: l.vekaria@saloria.co.uk website: www.saloria.co.uk

PROJECT  
**OSHWAL CENTRE - THE TEMPLE**

DRAWING TITLE <b>SITE PLAN AND PROPOSED DEVELOPMENTS</b>	
DATE 02-03-17	DRAWN BY IC
SCALE 1:500@A1	CHECKED BY PL

DRAWING NO. **6842-05-P0**