

H.M. LAND REGISTRY		TITLE NUMBER		
		<b>HD45363</b>		
ORDNANCE SURVEY PLAN REFERENCE	COUNTY	SHEET	NATIONAL GRID	SECTION
	HERTFORDSHIRE		TL 3002	A
Scale: 1/1250 Enlarged from 1/2500 WELWYN HATFIELD DISTRICT			©Crown copyright 1982	

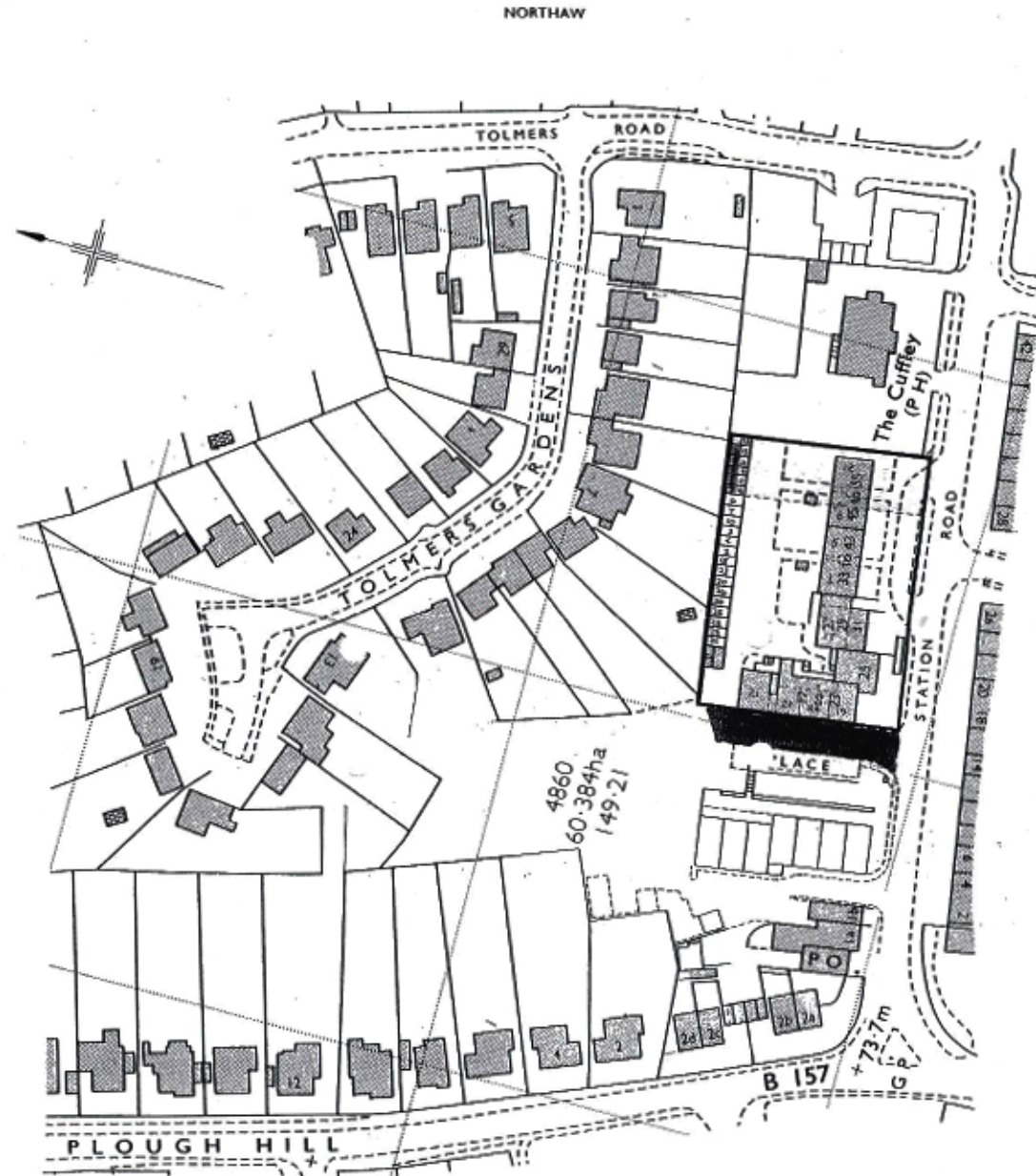

hancock  
architecture

eco-design and development  
in the built environment

t: 07742 644587

e: stuart@hancockarchitecture.co.uk

Hancock Architecture Ltd  
1st Floor Offices, Unit 47  
The Shipyard Estate  
Brightlingsea  
Essex CO7 0AR

project / site

maynard place, cuffley, herts

client

willow city estates plc

orientation



type

location plan - title plan

status

for client approval / planning / building control

revisions

drawn by

Stuart Hancock  
RIBA BSc (Hons) Architecture

scale

1:1250 @ A3

date

27 Feb 2015

dwg no

0/A000/LP/001A

rev

Ordnance Survey Licence No: 100056376  
Copyright OS & Crown Copyright Observed.