

LEMSFORD LANE, WELWYN PLANTING SCHEDULE

Key	Species	M	No/M	No	Size
Trees					
Ag	Alnus glutinosa			3	10-12 cms girth, root balled
Bp	Betula pendula			7	10-12 cms girth, root balled
Cb	Carpinus betulus			4	10-12 cms girth, root balled
Pa	Prunus avium			1	10-12 cms girth, root balled
PsA	Prunus subhirtella 'Autumnalis'			1	10-12 cms girth, root balled
Hedging					
Bse	Buxus sempervirens	148	5	740	30-40 cms, pot grown, single line
Pce	Prunus cerasifera (green form)	31	4	124	40-60 cms, bare root, double line
HM	Hedge Mix comprising	65	4		40-60 cms, bare root, double line
	20% Acer campestre			52	
	40% Crataegus monogyna			104	
	40% Prunus cerasifera (green)			104	
Natural Shrub Mix					
NSM	Native Shrub Mix	65	1		
	20% Corylus avellana			13	40-60 cms, bare root
	30% Crataegus monogyna			20	40-60 cms, bare root
	10% Ilex aquifolium			6	40-60 cms, pot grown
	20% Prunus cerasifera			13	40-60 cms, bare root
	20% Prunus spinosa			13	40-60 cms, bare root
Ornamental Shrubs					
AJP	Accuba japonica 'Picturata'	25	2	50	40-60 cms, 3 lt pots
CAB	Ceanothus 'Autumnal Blue'	5	2	10	40-60 cms, 3 lt pots
CBM	Ceanothus 'Blue Mound'	11	3	33	40-60 cms (D), 3 lt pots
Csp	Chaenomeles speciosa	9	2	18	40-60 cms, 3 lt pots
CWG	Cornus 'White Gold'	22	3	66	40-60 cms, 3 lt pots
Cst	Cotoneaster simonsii	14	2	28	40-60 cms, 3 lt pots
Cse	Cytisus scoparius	12	2	24	40-60 cms, 3 lt pots
Emm	Elaeagnus macrophylla	14	2	28	40-60 cms, 3 lt pots
EBG	Eucalyptus 'Emerald & Gold'	7	6	42	30-40 cms (D), 2 lt pots
Hrn	Hebe rakienis	23	4.5	104	30-40 cms, 2 lt pots
HhH	Hedera helix 'Hibernica'	19	4	76	30-40 cms (D), 2 lt pots
Hca	Hypericum calycinum	44	6	264	2 lt pots
Laf	Lavandula angustifolia 'Hidcote'	4	6	24	30-40 cms, 2 lt pots
Maq	Mahonia aquifolium	23	5	115	30-40 cms, 2 lt pots
Oha	Olearia x haastii	19	3	57	40-60 cms, 3 lt pots
Rsa	Ribes sanguineum	16	2	32	40-60 cms, 3 lt pots
Sjr	Skimmia japonica rubella	20	3	60	40-60 cms, 3 lt pots
All planted areas 50 mm bark mulch					
No peat based products to be used					
All pots/containers to be recycled					
Grass					

Key

Tree protection fencing: 1.8 m Heras fencing mounted firmly on scaffold poles. To be erected before any construction and retained until external works. Fixed with signs 'Construction Exclusion Zone-Keep Out'.

BS5837:2005 'Trees in Relation to Construction Recommendations' Fig 3 scaffolding

FOR PLANTING IN 2006

Pce Prunus cerasifera (green form) 25 m PD 4/m 100 no at 60-80 cms, bare root (50 mm bark mulch or biodegradable mulch roll, protect with temporary fencing)

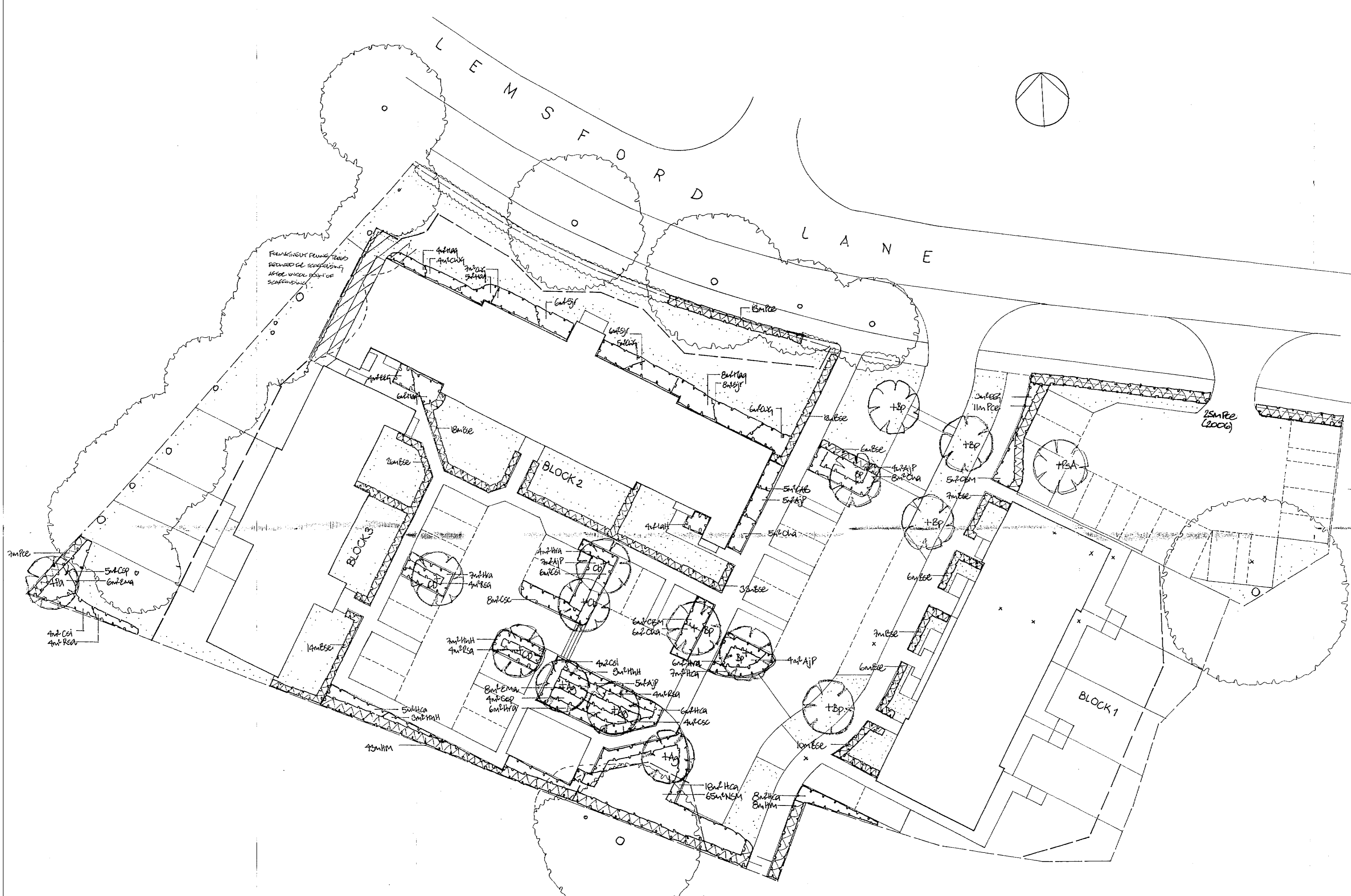

NB INCOMPLETE SERVICES INFORMATION CONTRACTOR TO CHECK BEFORE PLANTING

Rev C: Replacement hedge planting 1/11/06
 Rev B: Hedge retained, trees added 28/9/06
 Rev A: Tree protection key added 14/6/06

Caroline Hay ASSOCIATES
 LANDSCAPE ARCHITECTS

2 High St George St, Wellingham, Cambs CB4 9ES
 Tel/fax 01954 266500

Project
LEMSFORD LANE WELWYN GARDEN CITY

Drawing Title
PLANTING PLAN

Scale 1:200 Drawn by CJH Date 21/5/09
 Dig No 596.2 Rev C