

LEMSFORD LANE, WELWYN PLANTING SCHEDULE

Key	Species	No	Size
<b>Trees</b>			
Ag	Alnus glutinosa	3	10-12 cms airrh, root balled
Bp	Betula pendula	7	10-12 cms airrh, root balled
Cb	Carpinus betulus	4	10-12 cms airrh, root balled
Pa	Prunus avium	1	10-12 cms airrh, root balled
PaA	Prunus subhirtella 'Autumnalis'	1	10-12 cms airrh, root balled
<b>Hedging</b>			
	M	No/M	
Bse	Buxus sempervirens	148	5 740 30-40 cms, pot grown, single line
Pee	Prunus cerasifera (green form)	31	4 124 40-60 cms, bare root, double line
HM	Hedge Mix comprising	65	4 40-60 cms, bare root, double line
	20% Acer campestre		52
	40% Crataegus monogyna		104
	40% Prunus cerasifera (green)		104
<b>NSM Native Shrub Mix</b>			
	Sq M	No/Sq M	
	65	1	
	20% Corylus avellana		13 40-60 cms, bare root
	30% Crataegus monogyna		20 40-60 cms, bare root
	10% Ilex aquifolium		6 40-60 cms, pot grown
	20% Prunus cerasifera		13 40-60 cms, bare root
	20% Prunus spinosa		13 40-60 cms, bare root
<b>Ornamental Shrubs</b>			
AJP	Asarum japonica 'Picturata'	25	2 50 40-60 cms, 3 lt pots
CAB	Ceanothus 'Autumnal Blue'	5	2 10 40-60 cms, 3 lt pots
CBM	Ceanothus 'Blue Mound'	11	3 33 40-60 cms (D), 3 lt pots
Csp	Chaenactis speciosa	9	2 18 40-60 cms, 3 lt pots
CWG	Cornus 'White Gold'	22	3 66 40-60 cms, 3 lt pots
Csi	Cotoneaster simonsii	14	2 28 40-60 cms, 3 lt pots
Csc	Cytisus scoparius	12	2 24 40-60 cms, 3 lt pots
Ema	Eleagnus macrophylla	14	2 28 40-60 cms, 3 lt pots
EEG	Euonymus 'Emerald & Gold'	7	6 42 30-40 cms (D), 2 lt pots
Hra	Hedera rakensis	23	4.5 104 30-40 cms, 2 lt pots
HhH	Hedera helix 'Hibernica'	19	4 76 30-40 cms (D), 2 lt pots
Hca	Hypericum calycinatum	44	6 264 2 lt pots
Laf	Lavandula angustifolia 'Hidcote'	4	6 24 30-40 cms, 2 lt pots
Mag	Monarda aquifolium	23	5 115 30-40 cms, 2 lt pots
Oha	Olearia x haastii	19	3 57 40-60 cms, 3 lt pots
Rsa	Ribes sanguineum	16	2 32 40-60 cms, 3 lt pots
Sjr	Skimmia japonica rubella	20	3 60 40-60 cms, 3 lt pots
All planted areas 50 mm bark mulch			
No peat based products to be used			
All pots/containers to be recycled			
Grass			

**Key**  
 Tree protection fencing 1.8 m Heras fencing mounted firmly on scaffold poles. To be erected before any construction and retained until external works. Fixed with signs 'Construction Exclusion Zone-Keep Out'.  
 BS5837:2005 'Trees in Relation to Construction Recommendations' Fig 3 scaffolding

**FOR PLANTING IN 2006**  
 Pee Prunus cerasifera (green form) 25 m PD 4/m 100 no at 60-80 cms, bare root (50 mm bark mulch or biodegradable mulch roll, protect with temporary fencing)

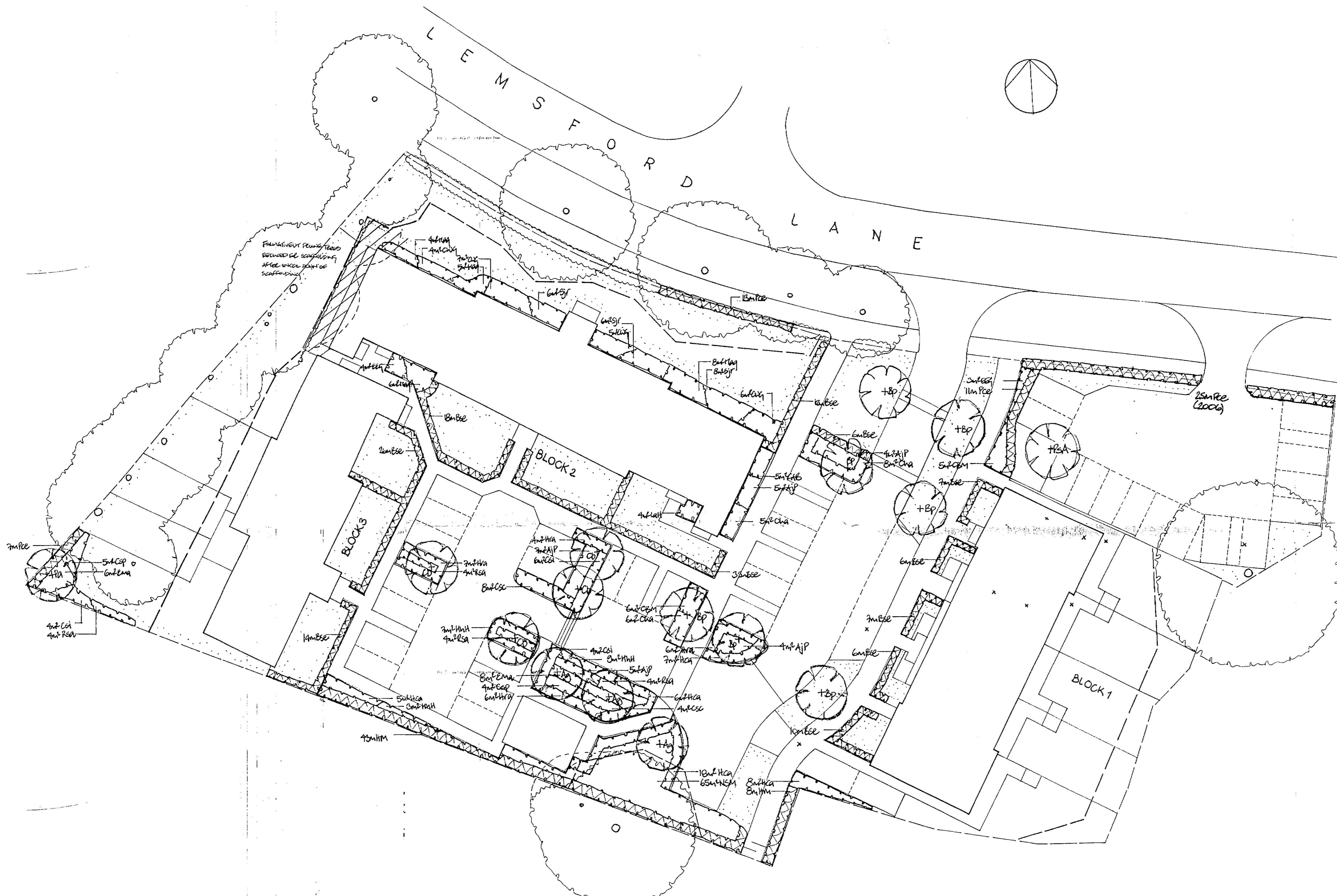

**NB INCOMPLETE SERVICES INFORMATION CONTRACTOR TO CHECK BEFORE PLANTING**  
 Rev C: Replacement hedge planting 17/1/06  
 Rev B: Hedge retained, trees added 28/9/06  
 Rev A: Tree protection key added 14/6/06

**Caroline Hay ASSOCIATES LANDSCAPE ARCHITECTS**  
 2 High St, George St, Welwyn, Cambs CB4 5EJ  
 Tel: 01564 260500

**Project**  
 LEMS F O R D L A N E  
 WELWYN GARDEN CITY

**Drawing Title**  
 PLANTING PLAN

**Scale** 1:200 **Drawn by** CJH **Date** 21/5/09  
**Dwg No** 596.2 **Rev** C