

Key	Species	No	Size
Trees			
Ag	Alnus glutinosa	3	10-12 cms girth, root balled
Bp	Betula pendula	7	10-12 cms girth, root balled
Cb	Carpinus betulus	4	10-12 cms girth, root balled
Pa	Prunus avium	1	10-12 cms girth, root balled
PsA	Prunus subhirtella 'Autumnalis'	1	10-12 cms girth, root balled
Hedging			
Bse	Buxus sempervirens	148	5
Pce	Prunus cerasifera (green form)	31	4
HM	Hedge Mix comprising	65	4
	20% Acer campestre		52
	40% Crataegus monogyna		104
	40% Prunus cerasifera (green)		104
NSM Native Shrub Mix			
	20% Corylus avellana	65	1
	30% Crataegus monogyna		13
	10% Ilex aquifolium		20
	20% Prunus cerasifera		6
	20% Prunus spinosa		13
Ornamental Shrubs			
AJP	Aucuba japonica 'Picturata'	25	2
CAB	Ceanothus 'Autumnal Blue'	5	2
CBM	Ceanothus 'Blue Mound'	11	3
Csp	Chaenomeles speciosa	9	2
CWG	Cornus 'White Gold'	22	3
Csi	Cotoneaster simonsii	14	2
Cse	Cytisus scoparius	12	2
Ena	Elaeagnus macrophylla	14	2
EEG	Euonymus 'Emerald & Gold'	7	6
Hra	Hebe rakensis	42	42
HhH	Hedera helix 'Hibernica'	23	4.5
Hca	Hypericum calycinum	19	4
LaH	Lavandula angustifolia 'Hidcote'	44	6
Maq	Mahonia aquifolium	4	6
Oha	Olearia x haastii	24	3
Rsa	Ribes sanguineum	23	5
Sjr	Skimmia japonica rubella	19	3
		57	3
		32	3
		60	3
All planted areas 50 mm bark mulch			
No peat based products to be used			
All pots/containers to be recycled			
Grass			

Key

Tree protection fencing: 1.8 m Heras fencing mounted firmly on scaffold poles. To be erected before any construction and retained until external works. Fixed with signs 'Construction Exclusion Zone-Keep Out'.

BS5837:2005 'Trees in Relation to Construction Recommendations' Fig 3 scaffolding

FOR PLANTING IN 2006
 Pce Prunus cerasifera (green form) 25 m PD 4/m 100 no at 60-80 cms, bare root (50 mm bark mulch or biodegradable mulch roll, protect with temporary fencing)

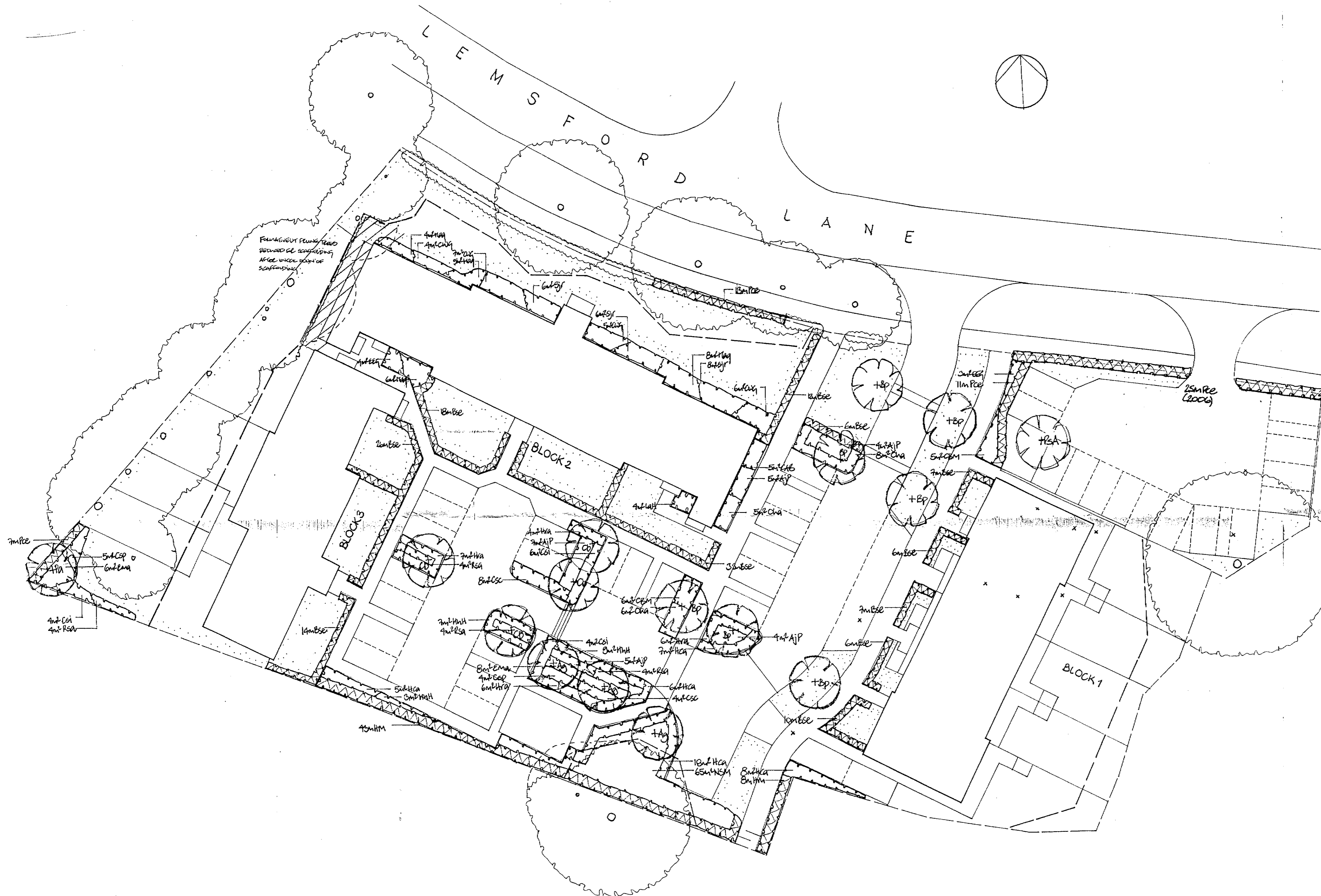

NB INCOMPLETE SERVICES INFORMATION
 CONTRACTOR TO CHECK BEFORE
 PLANTING

Rev C: Replacement hedge planting 1/1/06
 Rev B: Hedge retained, trees added 28/9/06
 Rev A: Tree protection key added 14/6/06

Caroline Hay ASSOCIATES
 LANDSCAPE ARCHITECTS
 2 High St/1 George St, Wingham, Cambs CB4 5EJ
 Tel/Fax 01564 200500

Project
 LEMSFORD LANE
 WELWYN GARDEN CITY

Drawing Title
 PLANTING PLAN

Scale 1:200 Drawn by CJH DBS 21/5/06
 Drg No 596.2 Rev C