

**BLOCK 3
FOUNDATION LAYOUT**

- NOTES**
- THIS DRAWING SHALL BE READ IN CONJUNCTION WITH ALL RELEVANT ENGINEERS AND ARCHITECTS DRAWINGS. ANY DISCREPANCIES FOUND BETWEEN INFORMATION SHOWN ON THIS OR ANY OTHER DRAWING SHALL BE REPORTED TO THE ENGINEER IMMEDIATELY AND PRIOR TO WORKS COMMENCING ON SITE.
 - THE FOUNDATIONS ARE BASED ON INFORMATION ON GROUND CONDITIONS OBTAINED FROM THE SITE INVESTIGATION REPORT BY IAN FARMER ASSOCIATES - REPORT No 5831 DATED APRIL 2004. SUBSOIL BEARING STRATA = GLACIAL GRAVEL WITH AN ALLOWABLE BEARING PRESSURE VALUE OF 175kN/m².
 - MINIMUM FOUNDATION DEPTH IS TO BE 1200mm OR AS INDICATED ON THE DRAWINGS. FOUNDATIONS ARE TO EXTEND AT LEAST 600mm BELOW ANY ROOTS/SOFT AREAS ENCOUNTERED. FOUNDATIONS ARE TO EXTEND AT LEAST 300mm BELOW ANY EXISTING FOUNDATIONS WHICH ARE TO BE REMOVED. ALL EXCAVATIONS ARE TO BE CHECKED/APPROVED BY THE BUILDING INSPECTOR AND SITE INVESTIGATION FIRM PRIOR TO CONCRETING.
 - CONCRETE DETAILS:- CLASS DS-1 SULPHATES/AC-1 REINFORCED CONCRETE TRENCH FILL FOOTINGS
CONCRETE GRADE = C35
MIN. CEMENT CONTENT = 300kg/m³
MAX. WATER CEMENT RATIO = 0.6
NOM. AGGREGATE SIZE = 20mm (ALTERNATIVE RC35 DESIGNATED MIX TO B.S. 5328)
 - ALL BLOCKWORK BELOW D.P.C. TO BE MIN. 7.0N/mm² BLOCKS LAID IN 1:3 MORTAR (BLOCKS SUBJECT TO CONFIRMATION FROM MANUFACTURER OF SUITABILITY FOR USE BELOW D.P.C.) EXCEPT WHERE SHOWN. BRICKWORK BELOW D.P.C. TO HAVE MIN. 21 N/mm² CRUSHING STRENGTH LAID AS ABOVE.
 - DIRECTION OF SPAN OF PRECAST BEAM AND BLOCK (WHERE APPLICABLE) FLOORING BY SPECIALIST SHOWN THUS:-
 - LOADING ON P.C. GROUND FLOOR:-
SCREENED = 1.8kN/m²
PARTITIONS = 0.5kN/m²
IMPOSED = 1.5kN/m² (SHADED AREAS = 3.0kN/m²)
 - SUB-FLOOR VOIDS TO BE VENTILATED AS INDICATED ON THE ARCHITECTS LAYOUT DETAILS.
 - KEY TO ABBREVIATIONS:-
FFL = FINISHED FLOOR LEVEL
SSL = STRUCTURAL SLAB LEVEL
TOC = TOP OF CONCRETE.
 - ALL FOUNDATIONS ARE TO BE 600mm WIDE SET OUT CENTRALLY UNDER LOAD BEARING WALLS OVER UNLESS NOTED OTHERWISE.

NOTE :- ALL FOUNDATIONS TO BE MIN 750mm THICK INSITU R.C. WITH B1131 MESH TOP / BTM EXCEPT WHERE SHOWN OTHERWISE. WHERE SOFT AREAS OF SUBSOIL ARE ENCOUNTERED EXCAVATE DOWN TO DENSE SAND/GRAVELS AND BACKFILL WITH MASS CONCRETE UP TO U/S OF R.C. FOUNDATION

NOTE: EXISTING FOUNDATIONS TO BE REMOVED ALONG LINE OF PROPOSED FOUNDATIONS DEEPEENED LOCALLY WHERE NECESSARY TO SUIT MIN 300mm BELOW EXISTING FORMATION LEVELS

NOTE :- SIDES OF FOUNDATIONS MAY NEED TEMPORARY SUPPORT DUT TO NATURE OF GROUND IN ACCORDANCE WITH S.I. REPORT

NOTE :- FOUNDATIONS SUBJECT TO COMMENTS/APPROVAL BY LOCAL AUTHORITY REGARDING POSSIBLE SOLUTION FEATURES

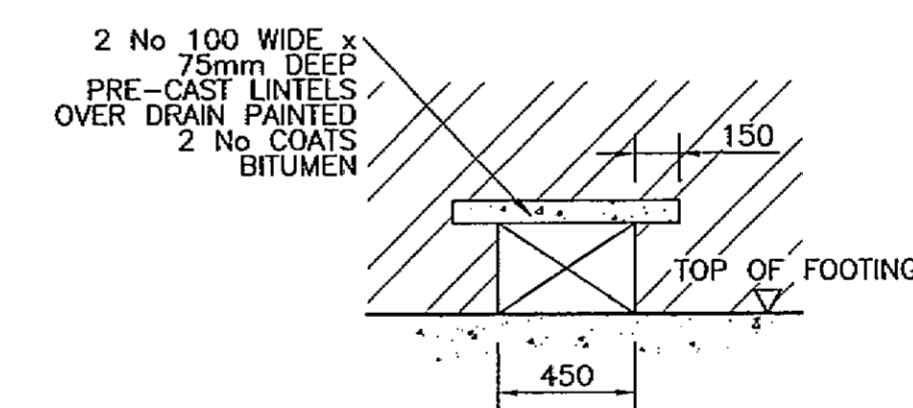

**Typical Lintel
Over Drainage Detail**

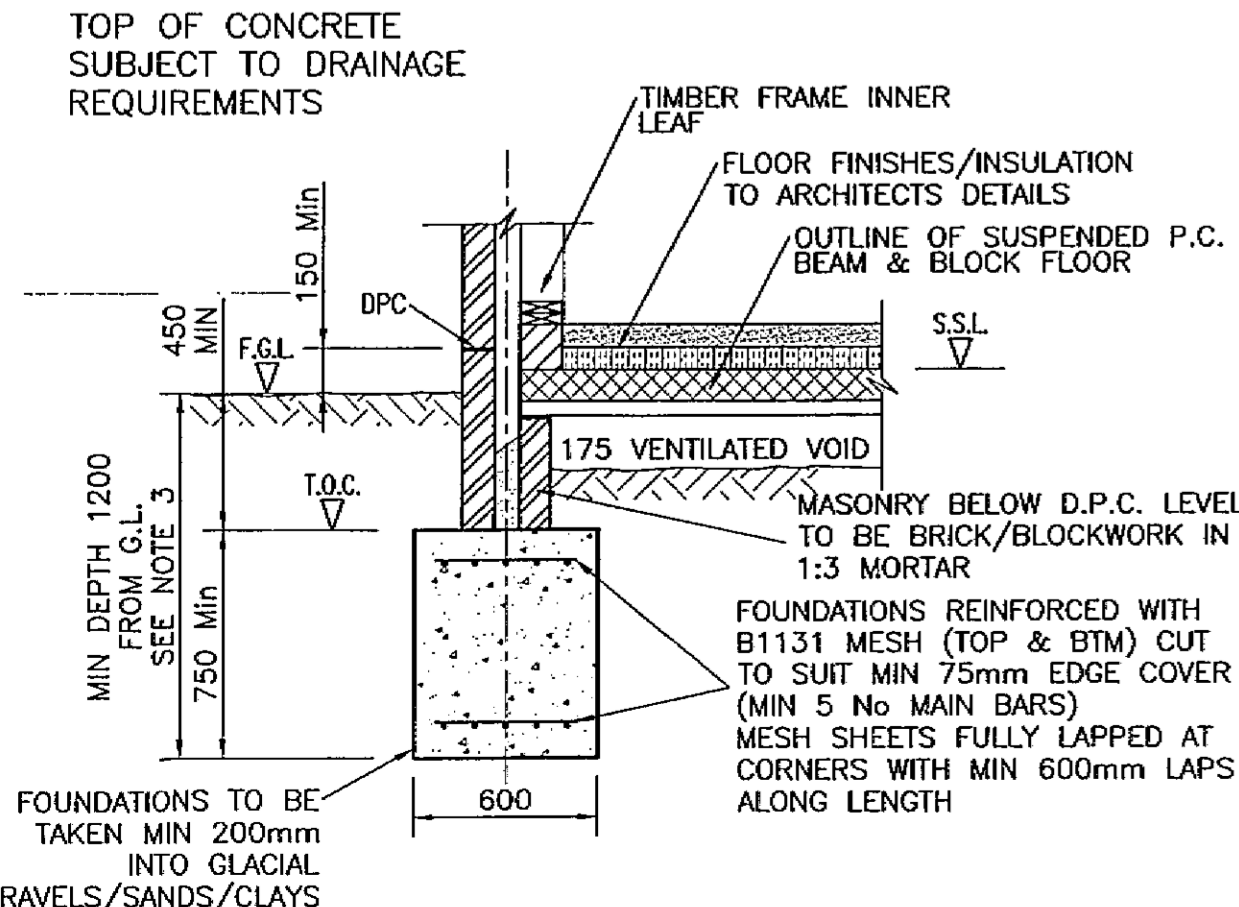

Section A-A

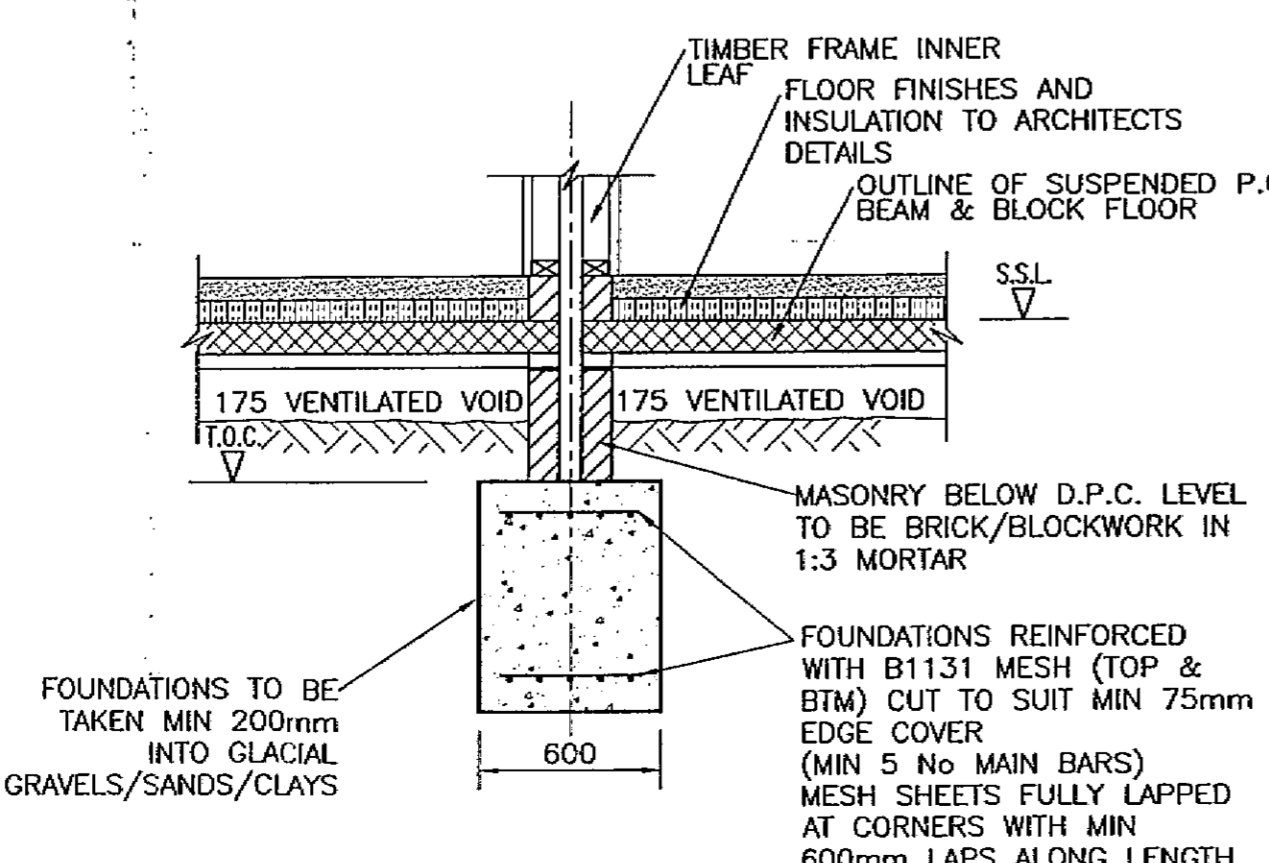

Section B-B

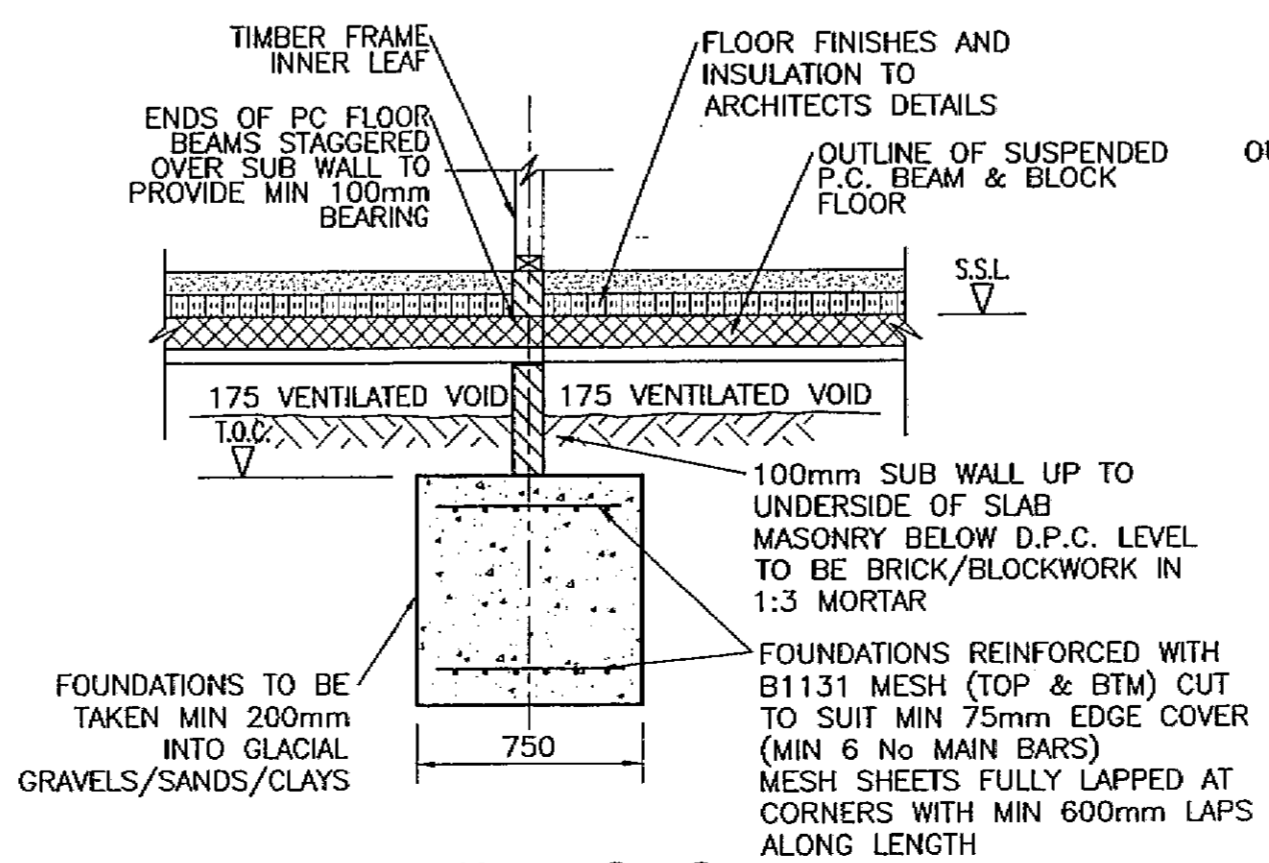

Section C-C

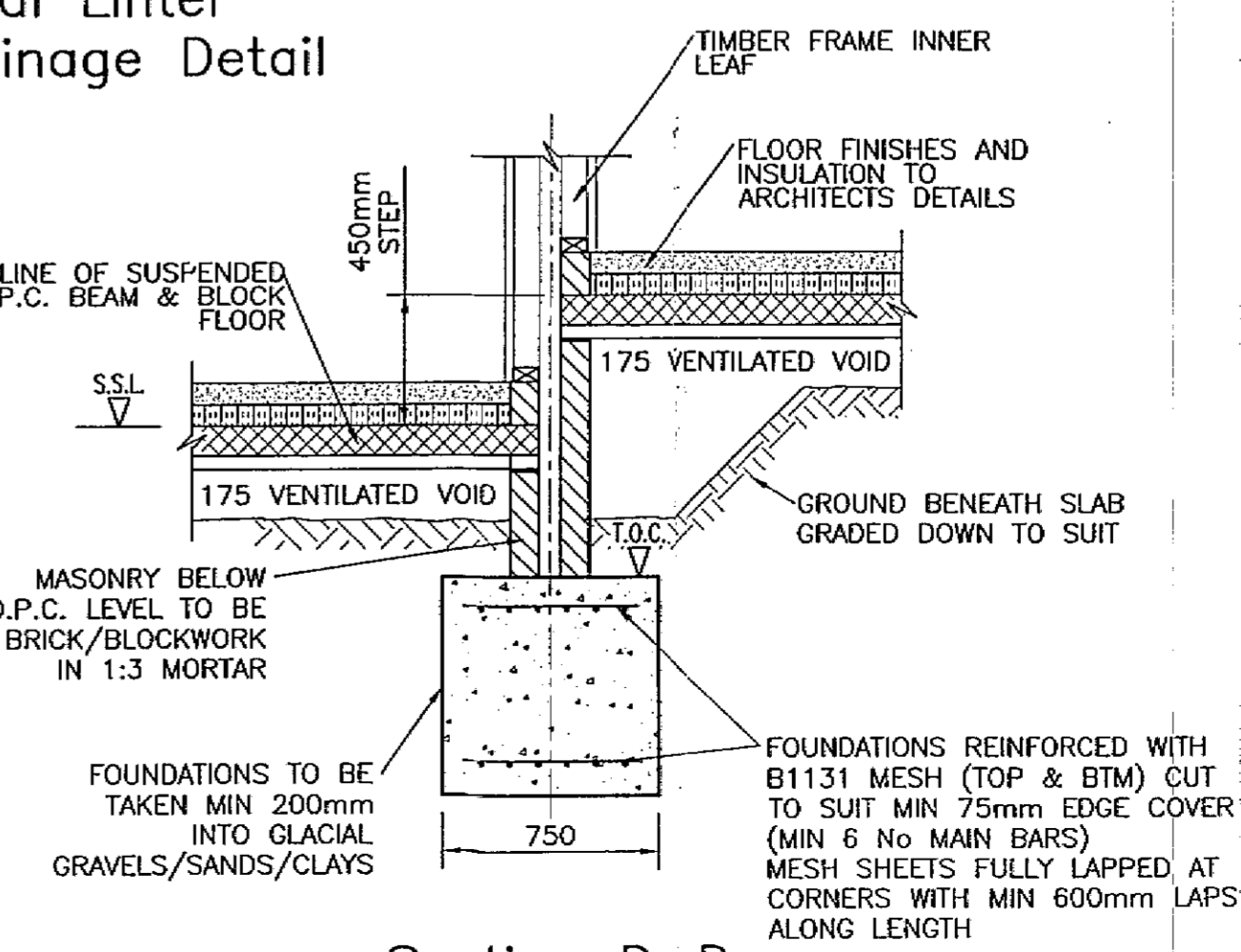

Section D-D

| | | |
|---|---|---------------|
| B | DRAWING AMENDED TO SUIT LATEST ARCHITECTS LAYOUTS AND FOUNDATIONS ADDED TO SUIT TIMBER FRAME MANUFACTURERS REQUIREMENTS AND DRAWING STATUS AMEND TO FOR TENDER. | MAY'06 HCP |
| A | OUTLINE OF EXISTING BUILDING/NOTES ADDED AND FOUNDATIONS/DRAWING AMENDED TO SUIT LATEST ARCHITECTS DRAWINGS. | JUN'05 HCP |

REVISION
STATUS

FOR TENDER

This drawing is the property and copyright of the Consulting Engineer and shall not be without written consent be communicated to a third party.

CLIENT
McCANN HOMES LTD (EASTERN REGION)

SITE
**LEMSFORD LANE,
WELWYN GARDEN CITY**

TITLE
**Block 3
Foundation Layout**

SDP CONSULTING ENGINEERS
Head Office, Suite 3, Salar House, Campfield Road, St Albans, Hertfordshire, AL1 5HF
Tel: 01272 844606, Fax: 01272 830771, Email: sdp@sdpce.co.uk
Southern Office, 21a Bargates, Christchurch, Dorset BH23 1QD
Tel: 01202 490600, Fax: 01202 490601, Email: sdp@south@sdpce.co.uk

| | | | |
|-------------|--------------|------|---------|
| SCALE | 1:50/25 @ A1 | DATE | APR '05 |
| DRAWING NO. | E04-067-204 | REV. | B |