

THIS DRAWING IS COPYRIGHT © BY SHP. THIS DRAWING IS NOT TO BE SCALED. ALL DIMENSIONS TO BE CHECKED ON SITE PRIOR TO COMMENCEMENT OF WORK. SOCIAL HOUSING PARTNERSHIP TO BE ADVISED OF ANY DISCREPANCIES OR ERRORS.
 IT IS THE RESPONSIBILITY OF THE CONTRACTOR TO CHECK ALL SETTING OUT INFORMATION (LEVELS, DIMENSIONS, CO-ORDINATES, ETC) INDICATED ON THIS DRAWING FOR THE WHOLE OF THE WORKS PRIOR TO COMMENCEMENT OF THE WORK AND SECONDARY SETTING OUT ON A COPY OF THIS DRAWING. ANY WORK COMMENCED SHALL BE NOTIFIED OF ANY DISCREPANCIES AND NO WORK SHALL BE COMMENCED UNTIL FURTHER INSTRUCTIONS ARE RECEIVED IN WRITING.

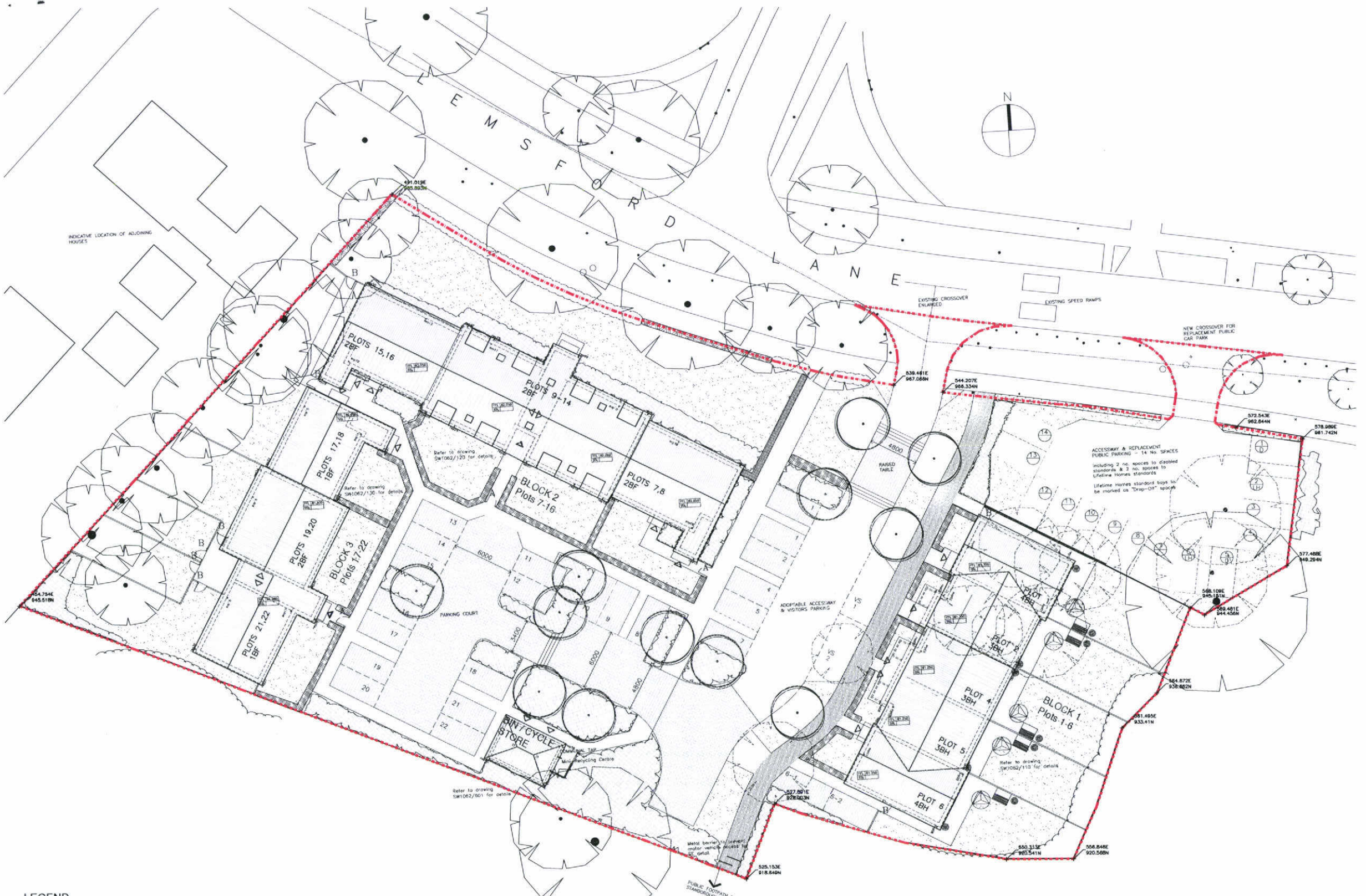

NOTES:

- 1. ACCOMMODATION**
- GENERAL NEEDS RENT (LIFETIME) - 11 UNITS**
 2 x 1 bed/2 person flats (plots 21 & 22)
 4 x 2 bed/4 person flats (plots 7, 8, 19 & 20)
 3 x 3 bed/5 person houses (plots 2, 4 & 3)
 2 x 4 bed/6 person houses (plots 1 & 5)
- LOW COST HOME OWNERSHIP - 10 UNITS**
 2 x 1 bed/2 person flats (plots 17 & 18)
 8 x 2 bed/4 person flats (plots 9 to 16, etc.)
- 2. CAR PARKING**
- No. of off street spaces required: 24
 No. of off street spaces provided: 25
 No. of spaces for visitors provided: 2
 No. of spaces for mobility impaired: 19
 of which: - spaces to disabled standard: 7
 - spaces to Lifetime Homes Standard: 12

L	Replacement parking area amended to LA requirements Parking spaces numbered & allocated	30.03.06 MPP
K	Rotary driers added to houses	20.02.06 MPP
J	Inner gate removed to side Unit 1 Gate & fence relocated to side Unit 6 Note amended re disabled parking spaces	13.02.06 MPP
H	Patio extended to Unit 1 PRELIMINARY ISSUE	12.01.06 MPP
G	Block wall added between Block 1 & car park Boundary added in red, status changed to PLANNING	19.10.05 MPP
F	Amendments made in accordance with revised Planning Application concerning adjacent public car park, addition of mini recycling centre & loss of 1 no. unit from Block 1	14.10.05 AM
E	Amendments made in accord with Eng's drg	24.06.05 MPP
D	Water butt & compost bin spec added Movement to East of Block 2 removed from adoption	08.06.05 MPP
C	Water butts, compost bins & chicone added Site boundary treatment revised to SW around Block 3 Block 2 communal garden increased with Plot 7 garden omitted Shed & paving to Plot 6 amended	23.05.05 MPP
B	Base survey corrected Site boundary setting out points amended Turning head, visitor parking & footpaths revised as SDP drgs Rumble strip added	04.05.05 MPP 18.04.05 MPP
A		

- LEGEND**
- EXISTING HEDGES POLLARDED & REINFORCED WITH NEW SHRUBS AS REQUIRED TO 600mm WIDE x 1200mm HIGH
 - NEW HEDGES 600mm WIDE x 1200mm HIGH ON TIMBER POST & RAIL FRAMEWORK UNTIL ESTABLISHED
 - NEW HEDGES 800mm WIDE x 900mm HIGH WITH 900mm HIGH TIMBER PICKET FENCE - STAINED GREEN
 - NEW HEDGES 800mm WIDE x 600mm HIGH ON TIMBER POST & RAIL FRAMEWORK UNTIL ESTABLISHED
 - SELECTED NEW SHRUBS
 - EXISTING HEDGES SHAPED AND REDUCED TO 600mm WIDE x 1200mm HIGH
 - SITE BOUNDARY

- PROPOSED NEW TREES
- EXISTING TREES
- EXISTING TREES TO BE REMOVED
- GAPING TO EXISTING WOODLAND AREAS IN STANBROUGH PARK
- NEW 900mm HIGH TIMBER PICKET GATE - STAINED GREEN
- NEW 1800mm HIGH TIMBER PALISADE GATE - STAINED GREEN
- GRASSED AREAS
- PARKING SPACE CONCRETE PAVERS - RED BRICKLE FINISH
- PARKING COURT CONCRETE PAVERS - GREY FINISH
- TARMACK/DEAM ROADWAY - BLACK FINISH
- CONCRETE PAVING SLABS - 450x450 - NATURAL FINISH
- DEW FOOTPATH
- 1800mm HIGH TIMBER PALISADE FENCE & POSTS WITH TRELLIS OVER - STAINED GREEN
- 1800mm HIGH ANTI-CLIMB FENCE - TRALADIN SYSTEM 20007 ORA GALV STEEL MESH & POSTS - GREEN POLYESTER COATED FINISH THROUGHOUT
- 1800mm HIGH TIMBER PALISADE FENCE & POSTS - STAINED GREEN

- NEW COMPOST CONVERTER BIN - 330 litre capacity - by BLACKWALL (0870 844 3020)
- NEW WATER BUTT, STAND & DIVERTER KIT - 220 litre capacity - by TRIMED WATER (0845 808 0000)
- 1800mm HIGH BRICKWORK WALL WITH TRELLIS OVER - STAINED GREEN
- ROTARY CLOTHES DRIER WITH METAL SAGE SUNK INTO CONCRETE FOOTING



PROJECT LEMS FORD LANE	
WELWYN	
DRAWING TITLE Site Plan	
DATE April 2005	DRAWN MPP
SCALE 1:200 @ A1	CHECK
STATUS PRELIMINARY	
JOB NO. SW1062	
DRAWING NO. 109	REVISION L