

THIS DRAWING MAY BE USED ONLY FOR THE PURPOSE INTENDED AND ONLY WRITTEN DIMENSIONS SHALL BE USED

NOTES

KEY

- TRAFFIC SIGNAL HEAD PRIMARY SIGNAL
- TRAFFIC SIGNAL HEAD SECONDARY SIGNAL
- PEDESTRIAN SIGNALS WITH ADDITIONAL CYCLE SIGNAL AND MODIFIED PUSH BUTTON DEMAND
- HIGHWAYS AGENCY MAINTENANCE BOUNDARY
- APPROXIMATE HIGHWAYS AGENCY BOUNDARY

1. THE PRECISE EXTENT AND LOCATION OF ROAD MARKINGS AND PAINT LINES SHALL BE ESTABLISHED IN THE DETAILED DESIGN
2. THE TYPE AND PRECISE LOCATION / ORIENTATION OF TRAFFIC SIGNAL POSTS AND HEADS SHALL BE ESTABLISHED IN THE DETAILED DESIGN

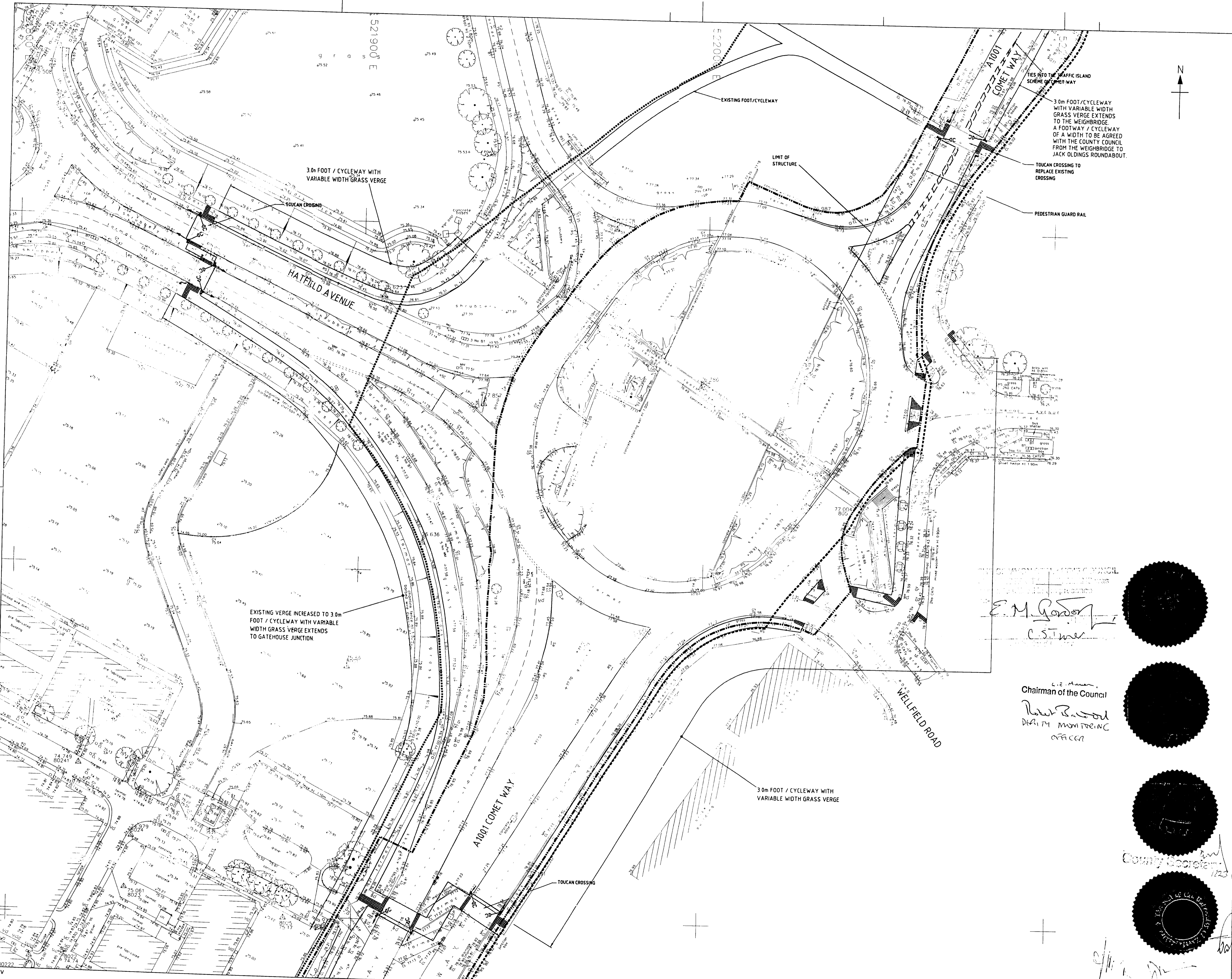
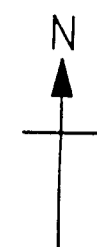

APPROVED FOR THE COUNCIL
 E.M. Gordon
 C. S. Turner

Chairman of the Council
 Robert Rowland
 DEPUTY MAYOR
 OFFICER

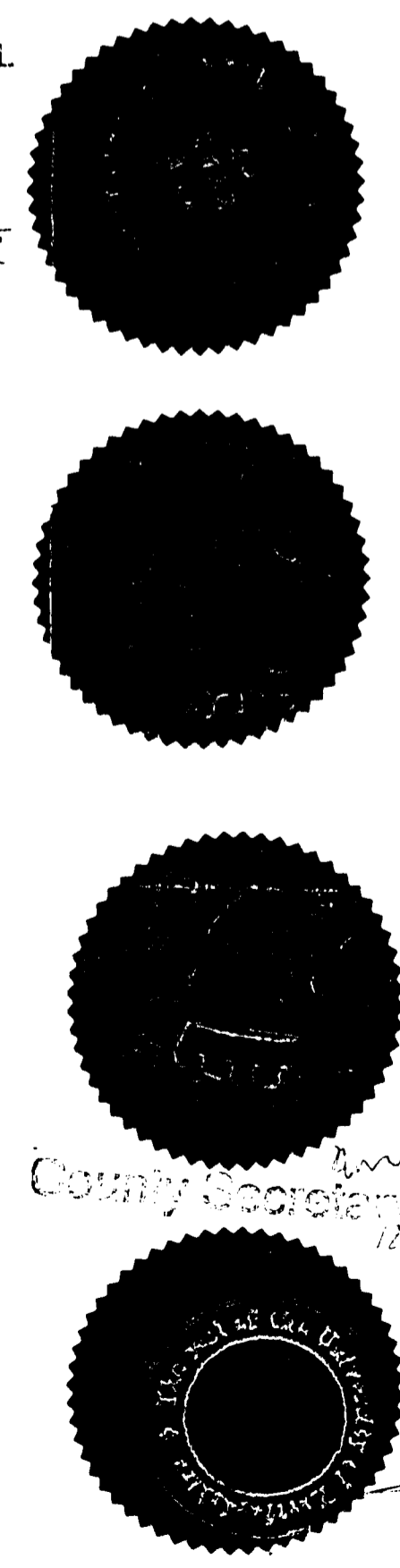

FOOT/CYCLEWAY ANNOTATION REVISED.	PAE	SES	21.12.00	M
FOOT/CYCLEWAY TO WEIGHBRIDGE ADDED. AMENDMENTS TO FT/CYCLEWAY ANNOTATION.	LSC	SES	19.12.00	L
TOUCAN CROSSING AMENDED. COMET WAY ENTRY RADIUS AMENDED. EXISTING ROAD MARKINGS ADDED.	KM	DLSM	15.09.00	K
VARIOUS MINOR AMENDMENTS	KM	GCL	18.07.00	J
SIGNALS ADDED TO TOUCAN CROSSING	RFW	GCL	21.06.00	H
ANNOTATIONS ADDED	RFW	GCL	15.05.00	G
AMENDMENTS TO TACTILE PAVING AND KERBLINES	RFW	GCL	25.04.00	F
PEDESTRIAN/CYCLEWAYS ADDED.	LSC	GCL	14.03.00	E
VARIOUS MINOR AMENDMENTS	LSC	GCL	8.11.99	D
TOUCAN CROSSING ADDED	LSC	GCL	27.9.99	C
SURVEY INFORMATION UPDATED	LSC	GCL	21.9.99	B
ROAD NAMES ADDED	GNC	GCL	10.8.99	A
Revision Details	By	Chk	Date	Suffi

Drawing Number: F8CSB/30 M

BRITISH AEROSPACE
 HATFIELD

Drawing Title
 GREEN LANES
 JUNCTION
 IMPROVEMENT

Scale at A1
 1:500

Drn	PH	PH	PH	PH
Chk	PH	PH	PH	PH
Chk	PH	PH	PH	PH
Chk	PH	PH	PH	PH

Date: 19/07/00

Scott Wilson Kirkpatrick & Co Ltd
 Basing View, Basingstoke
 Hampshire, RG21 4JZ
 Telephone (01256) 461161
 Fax (01256) 460582

Plot Date : 21-Dec-00 09:47 BY : 1406BPE
 AutoCAD File Name : [B] \FBase\Drawings\DRG30M.DWG [1 Xref(s)] 6560_34_.DWG