

NOTES:

All other design team elements, where indicated, have been imported from the consultant's drawings and reference should be made to the individual consultant's drawings for exact setting out, size and type of component.

Discrepancies and / or ambiguities within this drawing, between it and the information given elsewhere, must be reported immediately to the architect for clarification before proceeding.

All works are to be carried out in accordance with the latest British Standards and Codes of Practice unless specifically directed otherwise in the specification.

Responsibility for the reproduction of this drawing in paper form, or if issued in electronic format, lies with the recipient to check that all information has been replicated in full and is correct when compared to the original paper or electronic image. Graphical representations of equipment on this drawing have been co-ordinated, but are approximations only. Please refer to the Specifications and / or Details for actual sizes and / or specific contractor construction information.

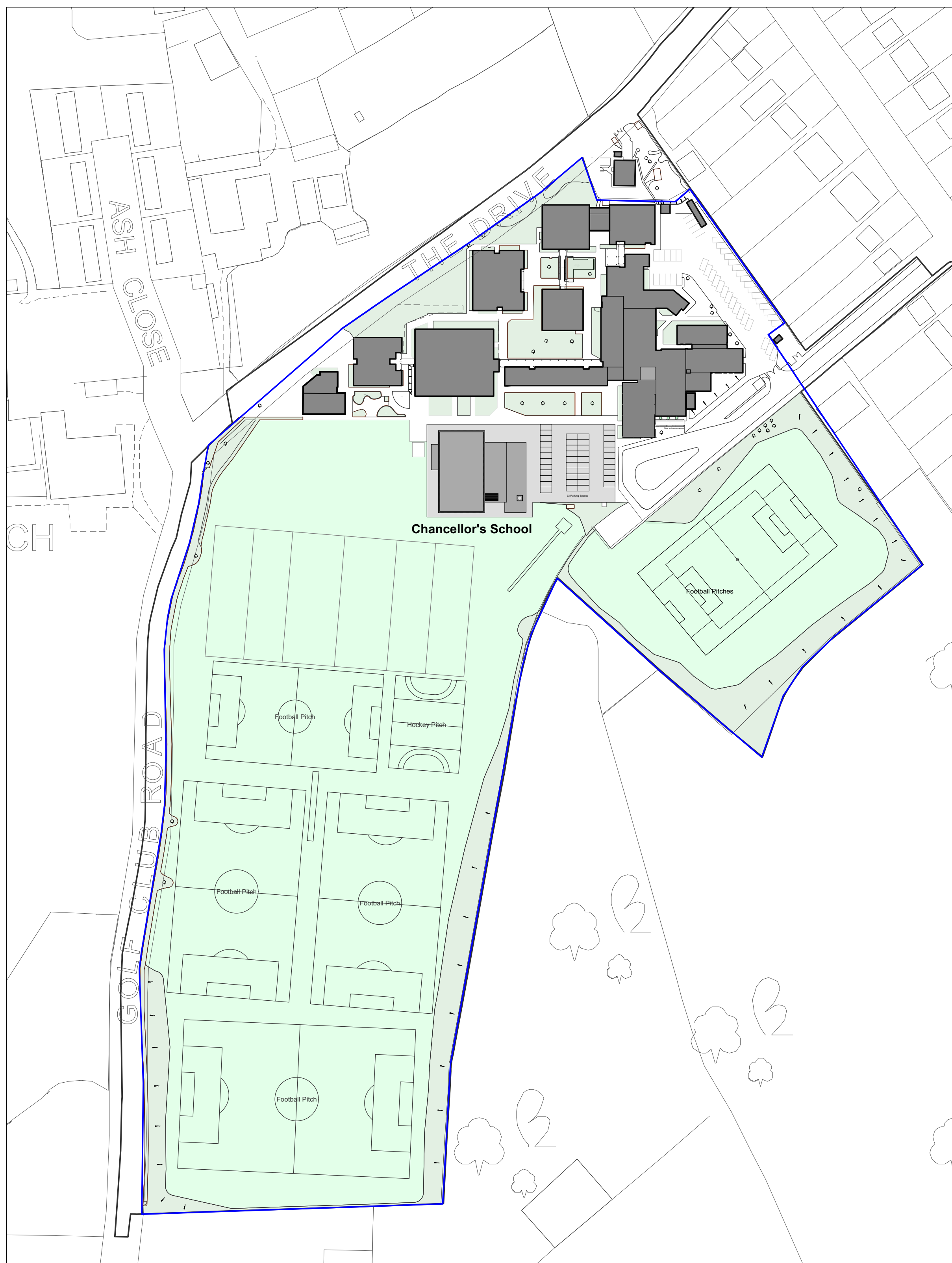

Existing Location Plan
Scale 1:1250

0 1020304050 M

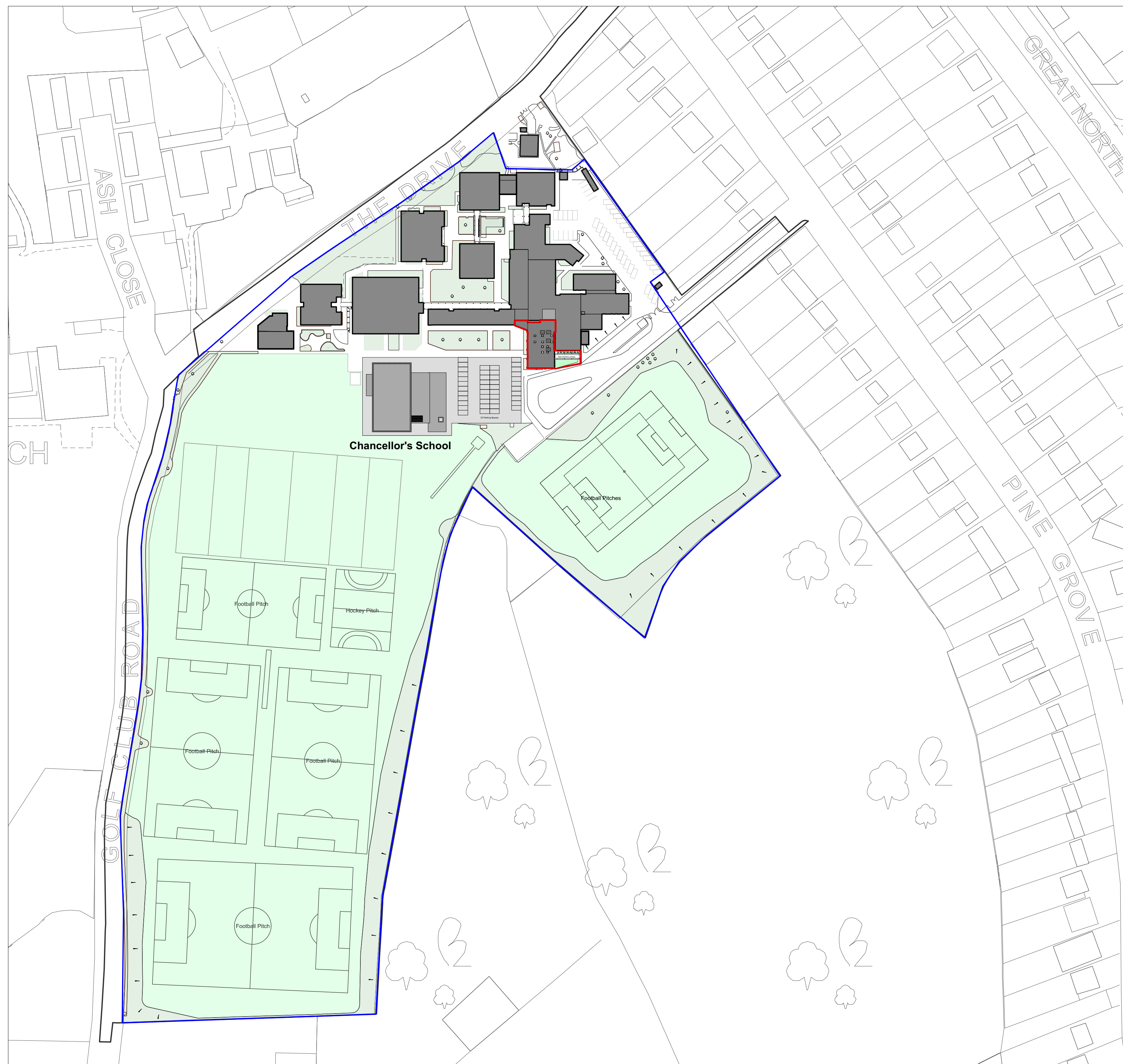

Proposed Location Plan
Scale 1:1250

0 1020304050 M

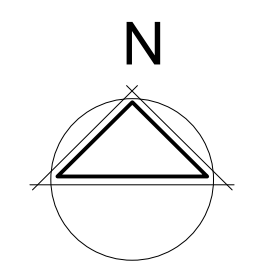

job title Chancellor's School		client Danes Educational Trust		work stage PLANNING APPLICATION	
date AUG 23	drawn AS INDICATED	scales AS INDICATED	scales@A3	building + drawing title CONVERSION OF GYMNASIUM AS EXISTING & AS PROPOSED SITE / SITE LOCATION PLANS	drawing status 2253 / 00 / 0000
Rev.			Date	Notes	By
				Clouded Areas Indicate revisions since last issue	
				LYSTER GRILLET + HARDING ARCHITECTS 01223 351626 admin@lgharchitects.com www.lgharchitects.com <small>Copyright © 2019 Lyster Grillet + Harding Ltd. All rights reserved.</small>	