

© Crown Copyright. Produced by HM Land Registry. Reproduction in whole or in part is prohibited without the prior written permission of Ordnance Survey. Licence Number 100026316.

SCALE BAR 1:1250

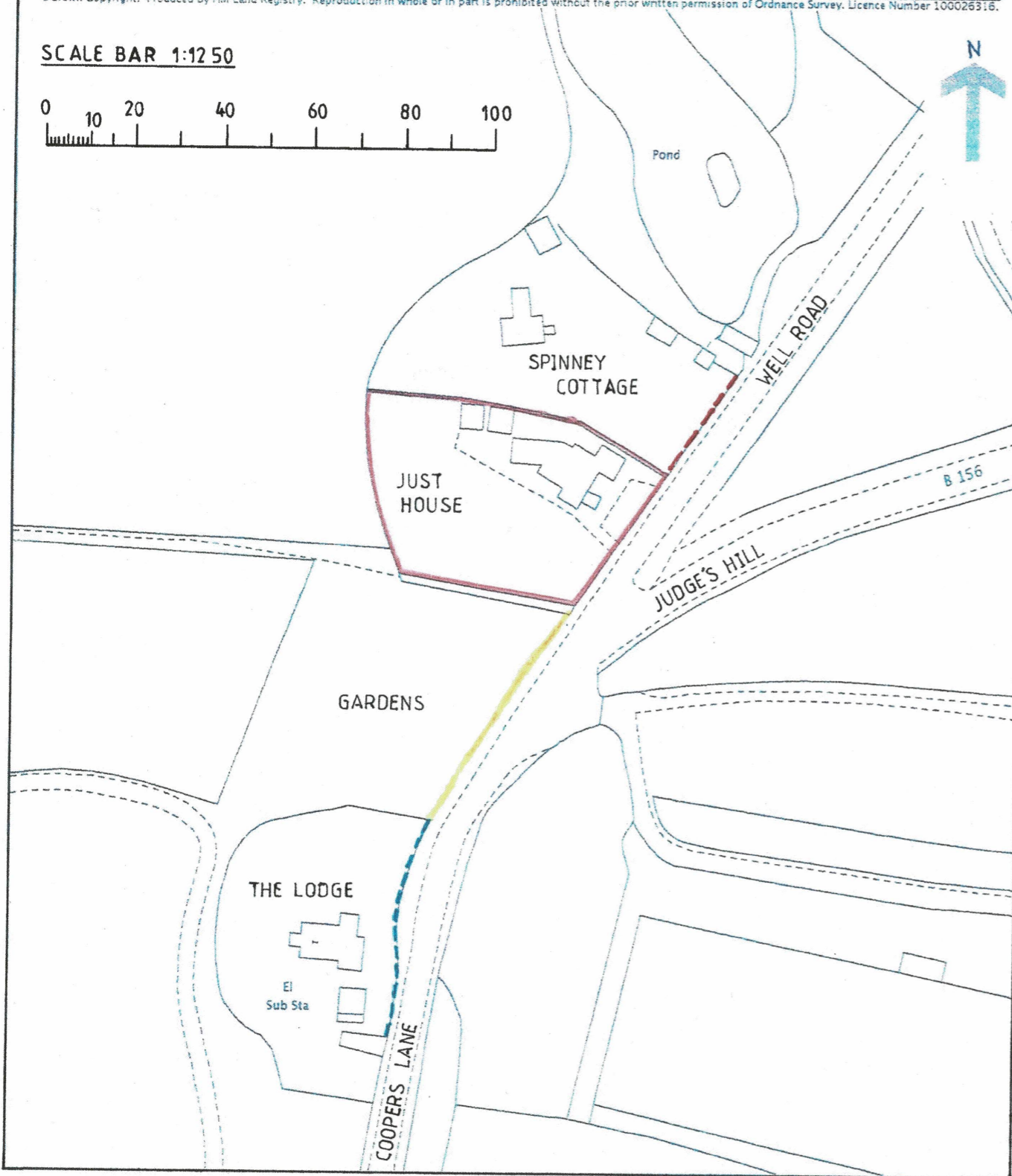

THIS IS A SITE PLAN PROVIDED WITH THE DEEDS OF THE PROPERTY WHICH WAS PREPARED BY THE LAND REGISTRY AND IT CLEARLY SHOWS TWO ACCESSES TO THE PROPERTY CREATING A CARRIAGE DRIVE.

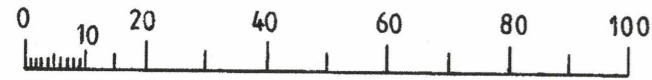

Spinney Cottage is to the North of Just House.

This is the timber fence of Spinney Cottage adjacent to the highway of Well Road. As it can be seen it has been stained dark brown/black.

The fence is 1400mm high.

This is shown on the adjacent location plan in red dashed line.



This is the timber fence adjacent to Coopers Lane of the grounds of Northaw Place to the South of Just House.

The fence is 1850mm high.

It is indicated on the adjacent location plan in a yellow line.



This is the fence of The Lodge, 2 Northaw Place. This was recently erected after being granted planning permission - 6/2016/1053/HOUSE to increase the height from 1500mm to 2000mm above the highway Coopers Lane. The base of the fence is 400mm from the highway.

This is to the South of the above gardens and indicated on the adjacent location plan in a green dashed line.