

GENERAL NOTES

THIS DRAWING HAS BEEN PREPARED FOR PLANNING PURPOSES ONLY.

THIS DRAWING IS TO BE READ IN CONJUNCTION WITH THE FOLLOWING:

- 12038629 LP - LOCATION PLAN
- 12038629 BP - BLOCK PLAN
- 12038629 ESL - EXISTING SITE LAYOUT- 1:200
- 12038629 ESF - EXISTING SITE LAYOUT- 1:100
- 12038629 ESE - EXISTING SITE ELEVATIONS
- 12038629 PSL - PROPOSED SITE LAYOUT - 1:200
- 12038629 PSE - PROPOSED SITE ELEVATIONS
- 12038629 ESBL - EXISTING SALES BUILDING LAYOUT
- 12038629 PSBL - PROPOSED SALES BUILDING LAYOUT
- 12038629 ESBE - EXISTING SALES BUILDING ELEVATION
- 12038629 PSBE - PROPOSED SALES BUILDING ELEVATION

FINISHES LEGEND	
	DENOTES 225mm DEPTH DOUBLE REINFORCED FORECOURT CONCRETE TO SHELL DESIGN STANDARD
	DENOTES 175mm DEPTH SINGLE REINFORCED FORECOURT CONCRETE TO SHELL DESIGN STANDARD
	DENOTES 100mm DEPTH NON LOAD BEARING CONCRETE TO SHELL DESIGN STANDARD
	DENOTES FULL DEPTH CONSTRUCTION STONE MASTIC ASPHALT (SMA) TO SHELL DESIGN STANDARD
	DENOTES PLANNED AREA OF ASPHALT WITH 40mm STONE MASTIC ASPHALT (SMA) WEARING COURSE TO SHELL DESIGN STANDARD
	DENOTES PROPOSED LANDSCAPED AREA
	DENOTES AREA OF PROPOSED PEA GRAVEL
	APPROX. LOCATION OF TANKS TO BE EXHUMED
	DENOTES NEW 300mm KERB QUADRANT
	DENOTES NEW H2 KERB LINE
	DENOTES NEW TRIEF KERB LINE
	DENOTES EXISTING KERB LINE
	DENOTES ITEMS TO BE DEMOLISHED
	DENOTES SITE BOUNDARY

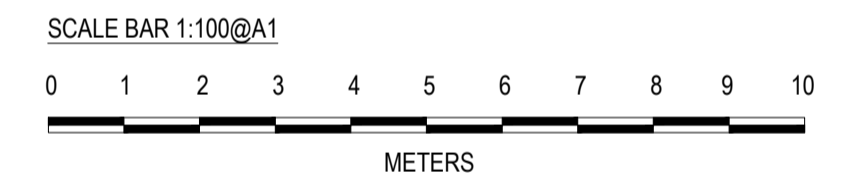

PROJECT MANAGERS:

Passion & Solutions

DESIGNERS:

MBH Design Studio Ltd.
Rosemount House, Rosemount Avenue, West Byfleet, Surrey, KT14 6LB
www.mbhld.com t: 01932 352 727 f: 01932 351 545

PHASE: **PLANNING**

REV	DATE	BY

PROJECT: SHELL WELWYN GARDEN
STANBOROUGH ROAD,
WELWYN GARDEN CITY AL8 6XA

TITLE: PROPOSED SITE LAYOUT - 1:100

SHELL UK OIL PRODUCTS LTD.
SHELL CENTRE, YORK ROAD,
LONDON, SE1 7NA
UNITED KINGDOM

DRAWN BY: NRVE	SCALE: 1:100@A1
DATE: 28.06.21	PLOT DATE: 28.06.21
CAD FILE: E:\ARCHIVE\13801\DRAWING\Welwyn Garden\12038629-PLG-FC1-21	

DWG No:	12038629	PSL1	21	A
---------	----------	------	----	---

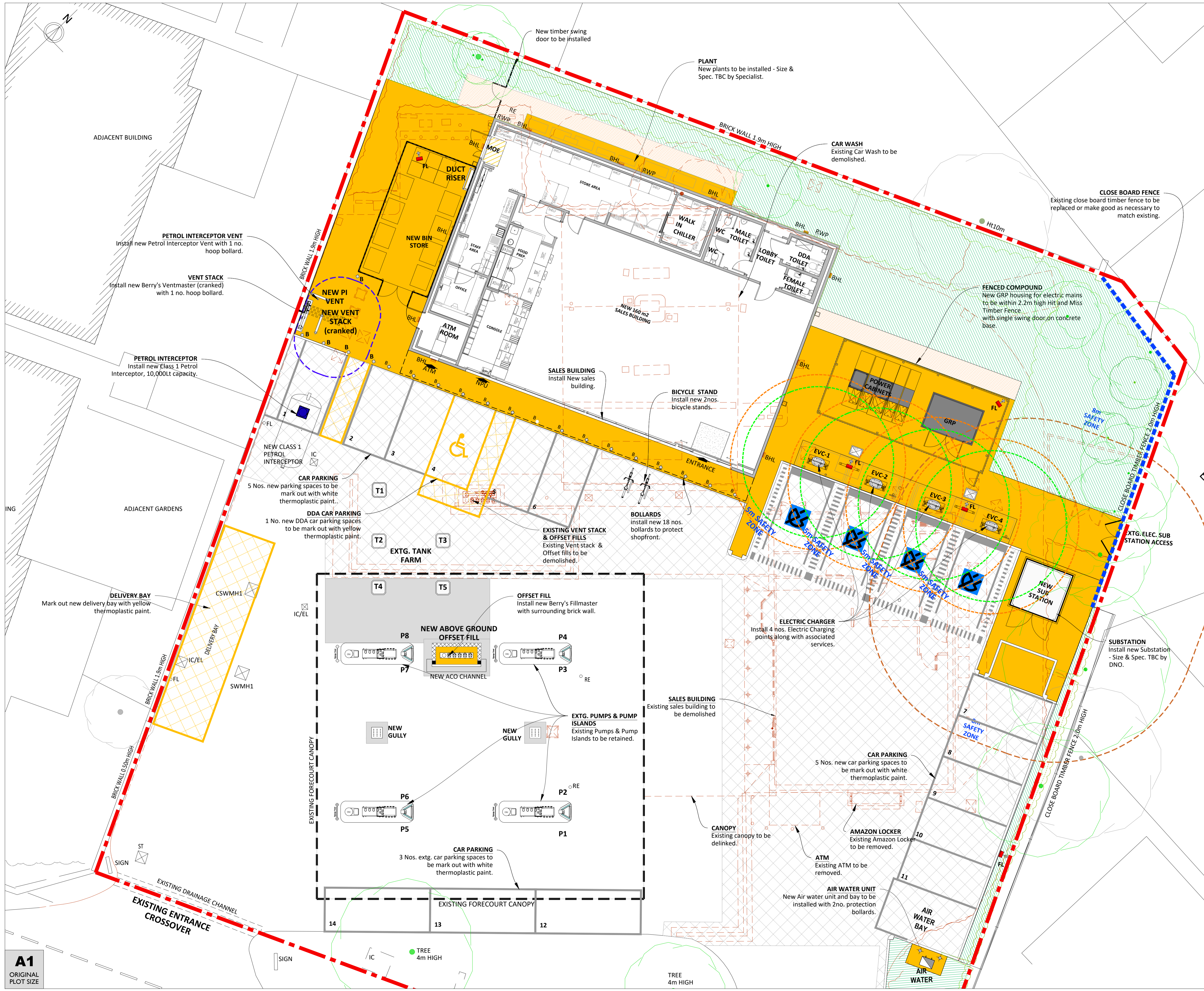

A1
ORIGINAL
PLOT SIZE