

Notes

- Any existing street furniture, covers and frames not identified to be removed under site clearance shall remain
- Vegetation to be cut back as shown on drawing to allow for construction of footpath and carriageway only
- Existing road signs not to be removed until such times as the appropriate replacement sign has been erected
- Prior to any site clearance works, the location of statutory undertakers plant should be confirmed

SAFETY, HEALTH AND ENVIRONMENTAL INFORMATION
UNUSUAL SIGNIFICANT HAZARDS

It is assumed that all works will be carried out by a competent contractor working, where appropriate, to an approved method statement. In addition to the hazards/risks normally associated with the types of work detailed on this drawing, note the following:

CONSTRUCTION
1. Work to be constructed over structural concrete. Depth to top of structure to be confirmed on site
2.

MAINTENANCE / CLEANING
1. None
2.
3.

DECOMMISSIONING / DEMOLITION
1. None
2.
3.

SITE CLEARANCE
SCALE 1:200

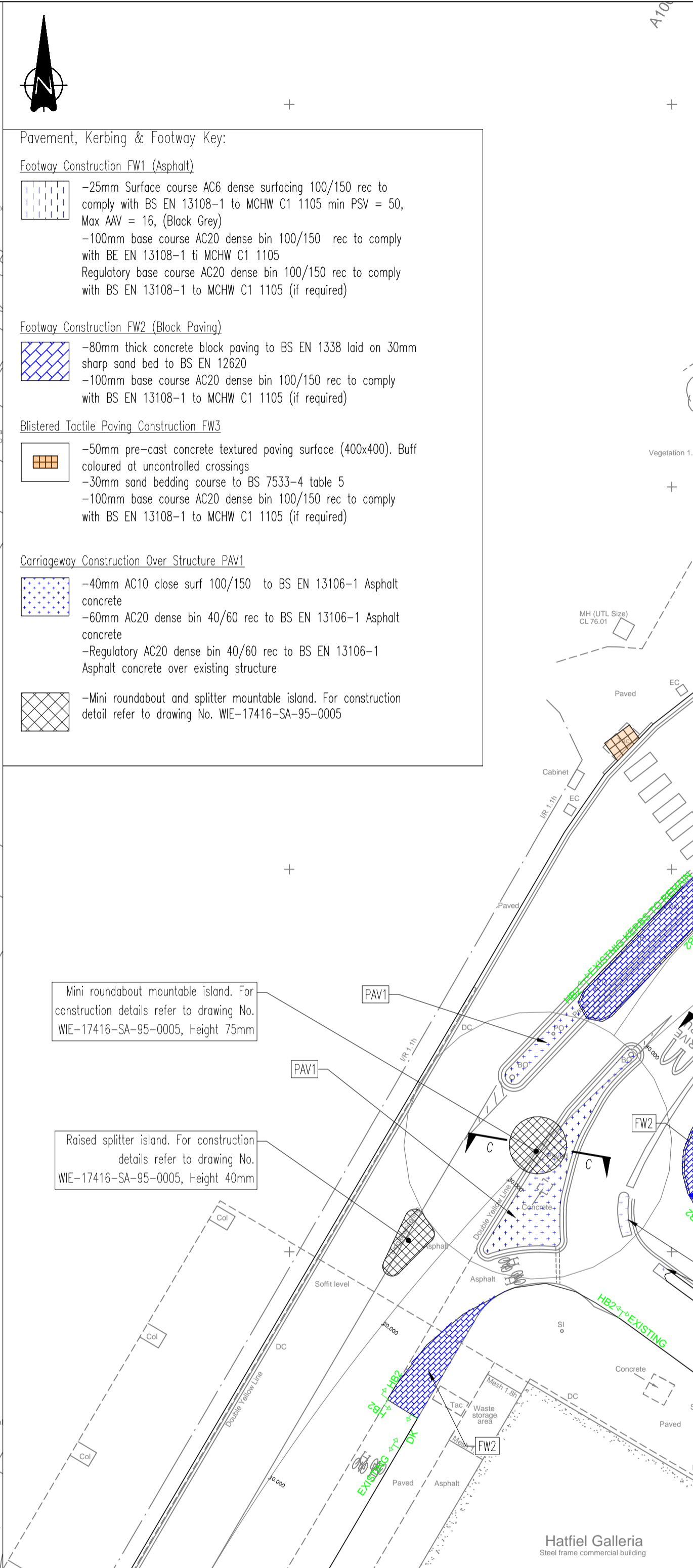

Pavement, Kerbing & Footway Key:

Footway Construction FW1 (Asphalt)

- 25mm Surface course AC6 dense surfacing 100/150 rec to comply with BS EN 13108-1 to MCHW C1 1105 min PSV = 50, Max AAV = 16, (Black Grey)
- 100mm base course AC20 dense bin 100/150 rec to comply with BS EN 13108-1 to MCHW C1 1105
- Regulatory base course AC20 dense bin 100/150 rec to comply with BS EN 13108-1 to MCHW C1 1105 (if required)

Footway Construction FW2 (Block Paving)

- 80mm thick concrete block paving to BS EN 1338 laid on 30mm sharp sand bed to BS EN 12620
- 100mm base course AC20 dense bin 100/150 rec to comply with BS EN 13108-1 to MCHW C1 1105 (if required)

Blistered Tactile Paving Construction FW3

- 50mm pre-cast concrete textured paving surface (400x400). Buff coloured at uncontrolled crossings
- 30mm sand bedding course to BS 7533-4 table 5
- 100mm base course AC20 dense bin 100/150 rec to comply with BS EN 13108-1 to MCHW C1 1105 (if required)

Carriageway Construction Over Structure PAV1

- 40mm AC10 close surf 100/150 to BS EN 13106-1 Asphalt concrete
- 60mm AC20 dense bin 40/60 rec to BS EN 13106-1 Asphalt concrete
- Regulatory AC20 dense bin 40/60 rec to BS EN 13106-1 Asphalt concrete over existing structure

-Mini roundabout and splitter mountable island. For construction detail refer to drawing No. WIE-17416-SA-95-0005

Site Clearance Key:

A B C Site Clearance Reference Table where:
A - Item Description / Unique item reference
B - Destination:
(A - Set aside for re-use)
(S - Client store, off site)
(T - Contractors tip off site)
(R - Remain)
C - Quantity - No / metres

Description table

BO - Bollard
LC - Lighting column (Disconnect power supply)
PO - Stainless steel post
SI - Advertising sign on concrete base

Existing precast concrete kerb to be broken out along with all bedding and backing and removed to licensed tip off site.

Existing block paving to be broken out to receive new footway/carriageway construction.

Existing asphalt footway to be broken out in preparation for pavement and footway. Existing asphalt to be removed to contractors tip off site.

Mini roundabout mountable island. For construction details refer to drawing No. WIE-17416-SA-95-0005, Height 75mm

Raised splitter island. For construction details refer to drawing No. WIE-17416-SA-95-0005, Height 40mm

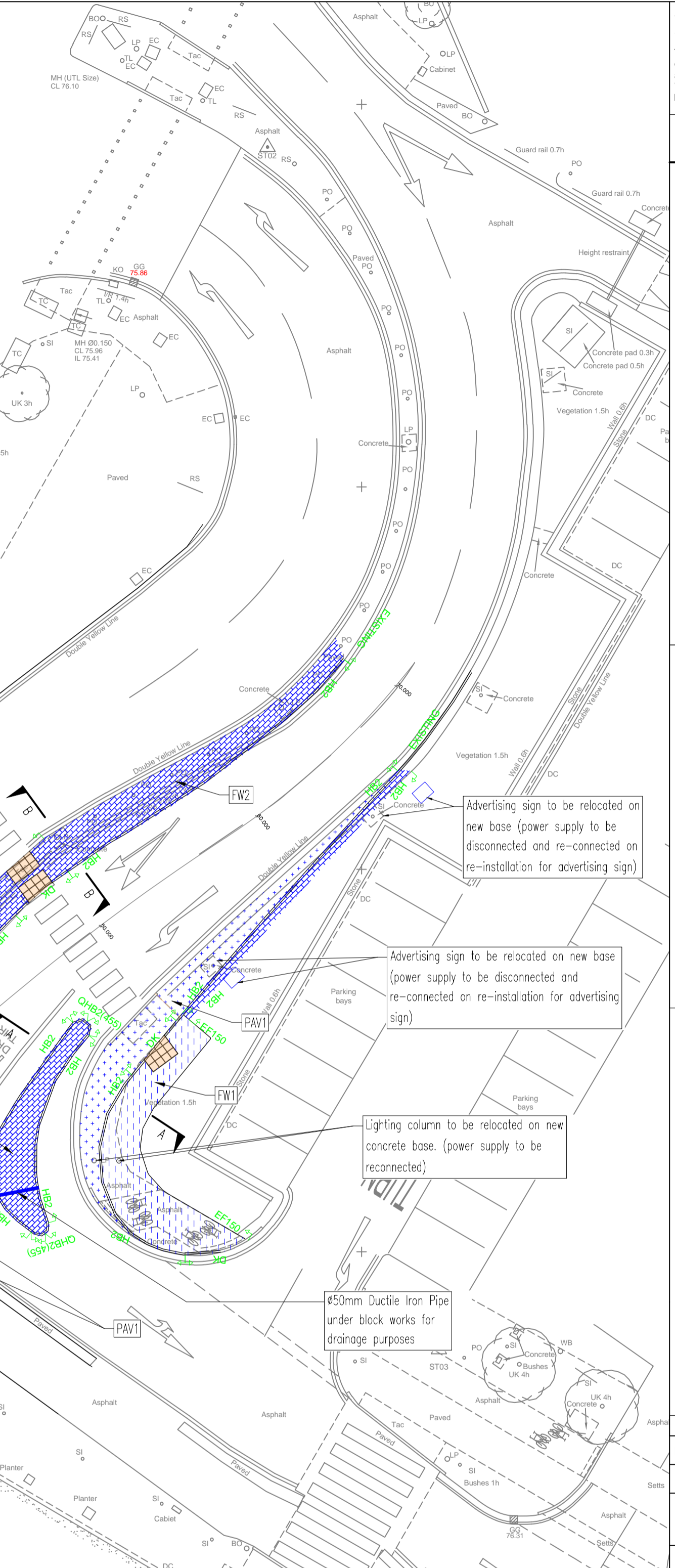

Pavement, Kerbing & Footway Key:

Footway Construction FW1 (Asphalt)

- 25mm Surface course AC6 dense surfacing 100/150 rec to comply with BS EN 13108-1 to MCHW C1 1105 min PSV = 50, Max AAV = 16, (Black Grey)
- 100mm base course AC20 dense bin 100/150 rec to comply with BS EN 13108-1 to MCHW C1 1105
- Regulatory base course AC20 dense bin 100/150 rec to comply with BS EN 13108-1 to MCHW C1 1105 (if required)

Footway Construction FW2 (Block Paving)

- 80mm thick concrete block paving to BS EN 1338 laid on 30mm sharp sand bed to BS EN 12620
- 100mm base course AC20 dense bin 100/150 rec to comply with BS EN 13108-1 to MCHW C1 1105 (if required)

Blistered Tactile Paving Construction FW3

- 50mm pre-cast concrete textured paving surface (400x400). Buff coloured at uncontrolled crossings
- 30mm sand bedding course to BS 7533-4 table 5
- 100mm base course AC20 dense bin 100/150 rec to comply with BS EN 13108-1 to MCHW C1 1105 (if required)

Carriageway Construction Over Structure PAV1

- 40mm AC10 close surf 100/150 to BS EN 13106-1 Asphalt concrete
- 60mm AC20 dense bin 40/60 rec to BS EN 13106-1 Asphalt concrete
- Regulatory AC20 dense bin 40/60 rec to BS EN 13106-1 Asphalt concrete over existing structure

-Mini roundabout and splitter mountable island. For construction detail refer to drawing No. WIE-17416-SA-95-0005

This drawing should not be scaled. Dimensions to be verified on site. Any discrepancies should be referred to the Engineer prior to work being put in hand.

This drawing is the property of Waterman Infrastructure & Environment Limited, and the drawing is issued on the condition that it is not copied, reproduced, related or disclosed to any unauthorised person, either wholly or in part without the consent in writing of Waterman Infrastructure & Environment Limited Pickfords Wharf, Clink Street, London SE1 9DG 1 020 7928 7888 1 020 7902 0992

This drawing is based upon topographical survey information supplied by Survey Solutions and Waterman shall not be liable for any inaccuracies or deficiencies.

Proposed Kerbs/Edging

HB2 PCC half battered kerbs (refer to drawing WIE-17416-SA-95-0004 for details)

DK Proposed dropped kerb comprising of kerb types DL1, EN, DR1 (Half battered left and right ramp, and bullnose) shown on drawing No. WIE-17416-SA-95-0004

EF150 Proposed PCC edging for footway (refer to drawing No. WIE-17416-SA-95-0004 for detail)

QB2(455) Proposed Quadrant Half Battered kerb (refer to drawing No. WIE-17416-SA-95-0004 for detail)

Drainage

450mm ductile iron pipe to BS EN 598, to be laid under block paving and taken through kerb to allow low point to drain

Notes

- Kerb upstand to be set at 125mm for HB2 Kerbs and 6mm at pedestrian crossing points
- For dropped crossing detail, refer to drawing No. WIE-17416-SA-95-0004
- For Kerbs and edging detail refer to drawing No. WIE-17416-SA-95-0004
- Refer to drawing No. WIE-17416-SA-95-0004 for proposed footway details
- For details of blistered Tactile paving type, refer to drawing No. WIE-17416-SA-95-0004
- Prior to any construction works, the location of statutory undertakers plant should be confirmed
- Refer to drawing No. WIE-17416-SA-95-0005 for typical cross section details A-A, B-B & C-C
- Footpath planer and hand laying rolling equipment should be used during removal of existing island and laying material over the structure

Rev	Date	Description	By
A01	23.12.15	FIRST ISSUE	MAC

Project	Hatfield Galleria
Title	Site Clearance & Construction Areas
Client	Land Securities Group PLC

Waterman

Regent House, Hubert Road, Brentwood, Essex CM14 4JE
Tel no 01277 238000
mail@watermangroup.com www.watermangroup.com

Drawing Status				
PRELIMINARY				
Designed by	CTI	Checked by	SN	Project No
Drawn by	MC	Date	December 2015	WIE17416
Scales @ A1 work to figured dimensions only				Computer File No
1:200				WIE-17416-SA-95-0001-A01.dwg
Publisher	Zone	Category	Number	Revision
WIE	SA	95	0001	A01

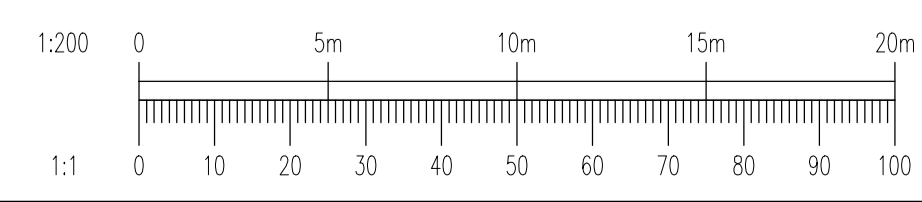

CONSTRUCTION AREAS
SCALE 1:200