

**KEY**

- Tree (Trunk) Locations and Category Grading
- Root Protection Areas and Category Grading (see below)
- Tree Canopy Spreads – only part of the canopy may be shown.
- Trees recommended for removal irrespective of any development of the site or removed due to the site development.
- Construction Site Access and Ground Protection Measures
- Ground Protection Measures
- Footprints of buildings or Structures to be demolished or removed
- Footprints of proposed buildings
- Existing hedges
- Tree Protection Fencing – Demolition Phase
- Tree Protection Fencing – Construction Phase

Category Grading (See Arboricultural Survey – Appendix A)	
	Category A
	Category B
	Category C
	Category U

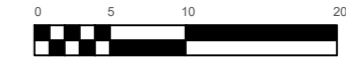
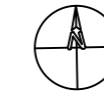

This drawing may not be reproduced without written consent. All copyrights reserved.

Based on drawings supplied by APR Services, Barnet and Nett Assets, Croxley Green.

The original of this drawing was produced in colour – a monochrome copy should not be relied upon.

The position of trees is indicative where access was restricted during the Arboricultural Survey. The position of trees within groups may be indicative and not all stems may be shown.

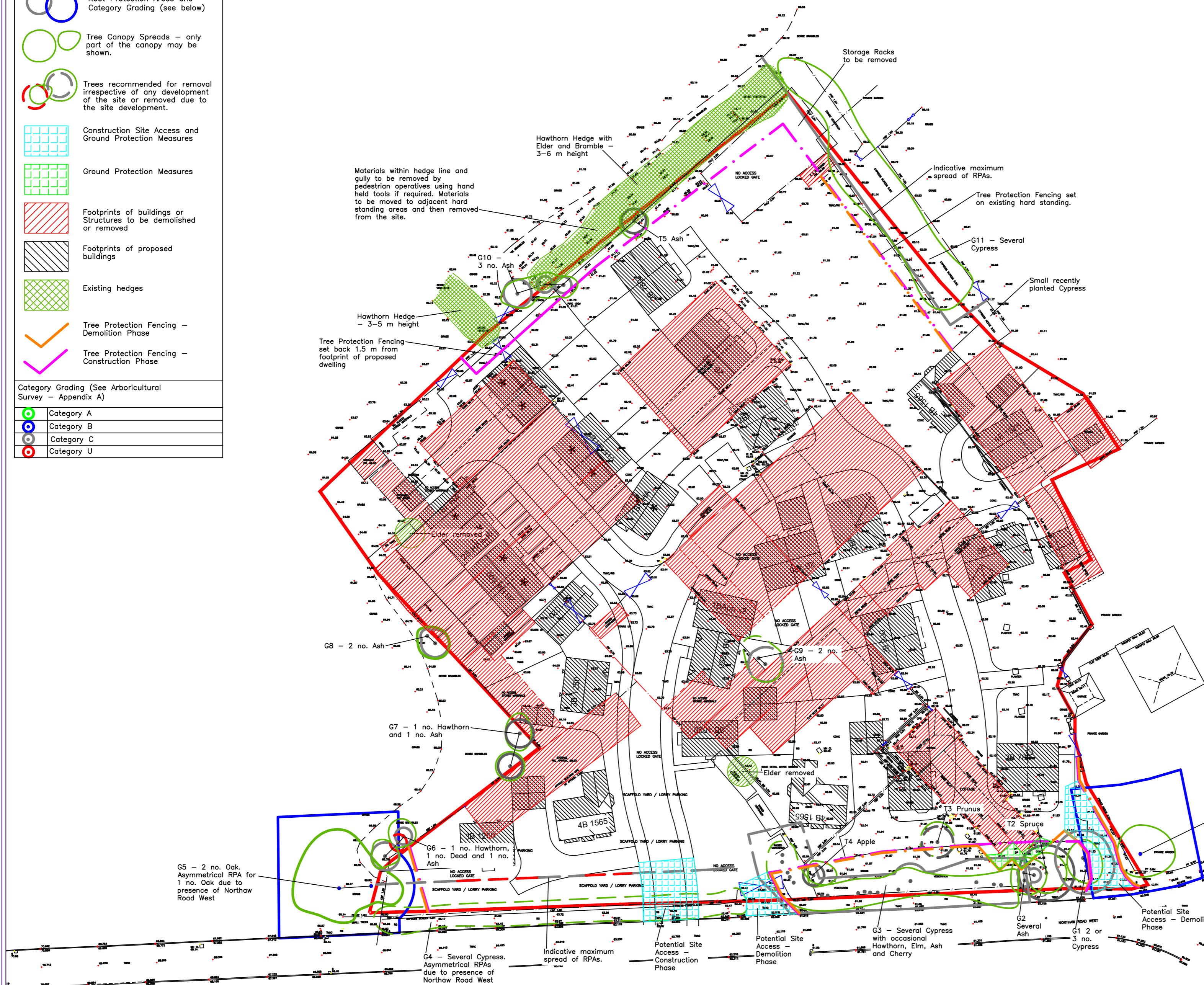

Colesdale Farm, West,  
 Northaw Road West,  
 Cuffley, Hertfordshire  
 EN6 4QZ

Drawing Title:  
Tree Protection Plan

Drawing No:  
TPP/CFNRW/010 B  
 Client: Humphrey  
 Brosnan  
 Scale: 1:500 @ A2  
 Drawn By: drc  
 Date: July 2019

DCCLA

David Clarke BSc (Hons) PD Arb (RFS)  
 CMLI M Arbor A  
 Offices in Hertfordshire and Warwickshire  
 Head Office: Willowbrook House, Church Lane, Fillongley, Warwickshire, CV7 8EW  
 M: (07775) 650 835 or (01676) 541 833  
 e: info@dccla.co.uk