

This drawing must be viewed in colour

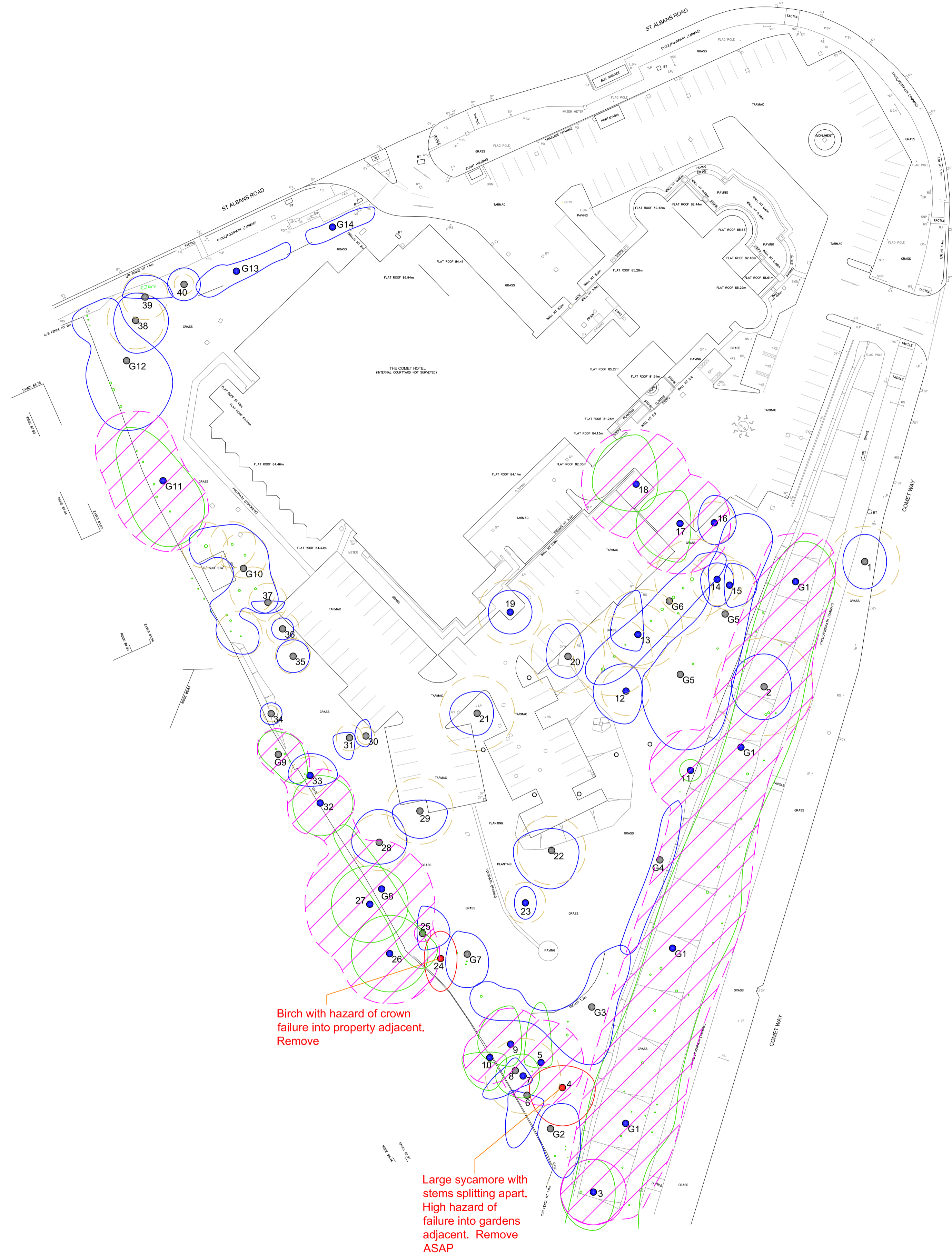

Birch with hazard of crown failure into property adjacent. Remove

Large sycamore with stems splitting apart. High hazard of failure into gardens adjacent. Remove ASAP

TREE CONSTRAINTS PLAN

SITE ADDRESS
Ramada Hatfield Hotel, St Albans Road, Hatfield, AL10 9RH

CLIENT
Fusion

JOB REF
DS14011401

DRAWING NO
DS14011401.02A

DATE
16/06/2014

Patrick Stileman Ltd
9 Chestnut Drive, Berkhamsted, Herts,
HP4 2JL 01442 866112



KEY

- Tree / tree group with high retention priority which should initially be regarded as a constraint
- Tree / tree group with lower retention priority which could defensibly be removed in order to facilitate development
- Tree / tree group which should be removed for reasons of sound arboricultural management
- Root Protection Area (RPA) for tree / tree group with high retention priority
- Root Protection Area (RPA) for tree with low retention priority

BS 5837 category key

- Category U tree
- Category A tree
- Category B tree
- Category C tree

SCALE
1:500 @ A1

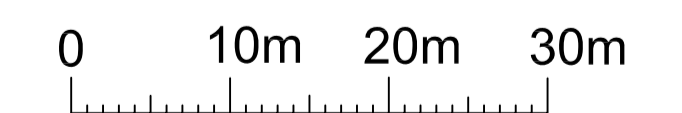

NOTES:

Stem diameters are not drawn to scale. See schedule for dimensions

This drawing is based on the topographic survey supplied to us by the client. We have taken the position of the trees included in the survey to be accurate. The following trees were excluded from the topographic survey and their locations shown are indicative only: 26, 27