

**LEGEND**

**TREE PROTECTION FENCING**

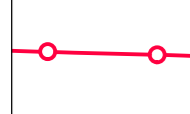

All fencing shall be installed prior to any plant activity on site whatsoever, including: demolition, utility installation, groundworks, and soil stripping

Once erected, all TPF will be regarded as sacrosanct, and will not be removed or altered without prior recommendation by the project arboriculturist and approval of the local planning authority. The TPF shall comprise of interlocking weld-mesh panels (e.g. Heras), well braced by attachment to scaffold pole uprights driven firmly into the ground. Should any alternative method of barrier construction be proposed, consultation with the project arboriculturist will be obtained to clarify the efficacy of the revised design prior to informing the local planning authority and obtaining their consent. Once the exclusion zone has been protected by barriers and/or ground protection, construction work can commence. All weather notices may be erected on the barriers.

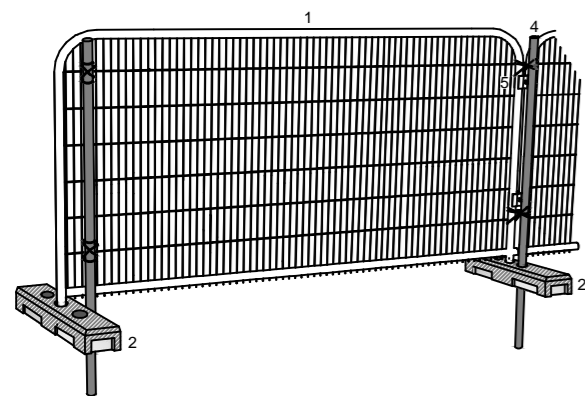

- 1 Weldmesh (e.g Heras) Panels
- 2 Concrete or rubber blocks
- 3 Scaffold pole uprights driven firmly into ground, then secured to panels with wire ties, or;
- 4 Uprights driven firmly into ground through hole in block, then secured to panels with wire ties.
- 5 Panels to be interlinked using clamps

**ALTERNATIVE TPF**

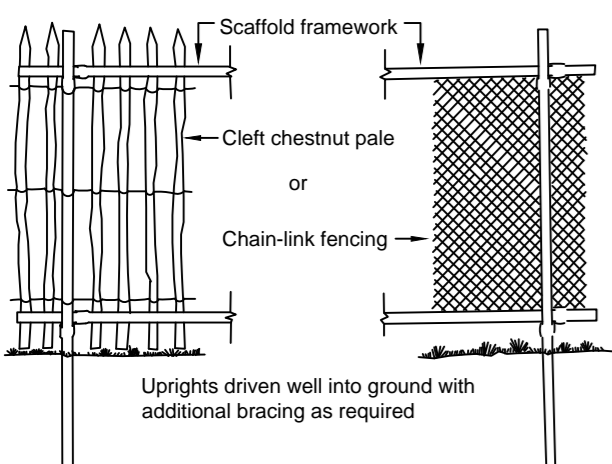

**TREE TO BE RETAINED**

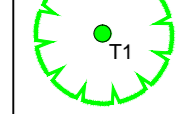

**TREE TO BE REMOVED**

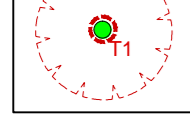

- A CATEGORY TREE
- B CATEGORY TREE
- C CATEGORY TREE
- U CATEGORY TREE

**ROOT PROTECTION AREA (RPA) FOR RETAINED TREES**

**RESTRICTIONS WITHIN TREE PROTECTION AREAS**

- Inside the exclusion area of the fencing, the following shall apply:
- No mechanical excavation whatsoever
  - No excavation by any other means without arboricultural site supervision
  - No hand digging without a written method statement having first been approved by the project arboriculturist.
  - No lowering of levels for any purpose (except removal of grass sward using hand tools)
  - No storage of plant or materials
  - No storage or handling of any chemical including cement washings
  - No vehicular access
  - No fire lighting
- In addition to the above, further precautions are necessary adjacent to trees:
- No substances injurious to tree health, including fuels, oil, bitumen, cement (including cement washings), builders sand, concrete mixing and other chemicals shall be stored or used within or directly adjacent to the protection areas of retained trees
  - No fire shall be lit such that flames come within 5m of tree foliage.

**PHASING OF DEVELOPMENT**

The arboricultural protection on this site must be carried out in the following order:

1. Tree removal and access facilitation pruning
2. Accurate erection of tree protection fencing.
3. Site accessible to construction/demolition traffic
4. Demolition/site clearance
5. Construction
6. Removal of tree protection fencing.
7. Remedial tree surgery

The above phasing must not be changed without approval from the project arboriculturist and agreement with the Council.

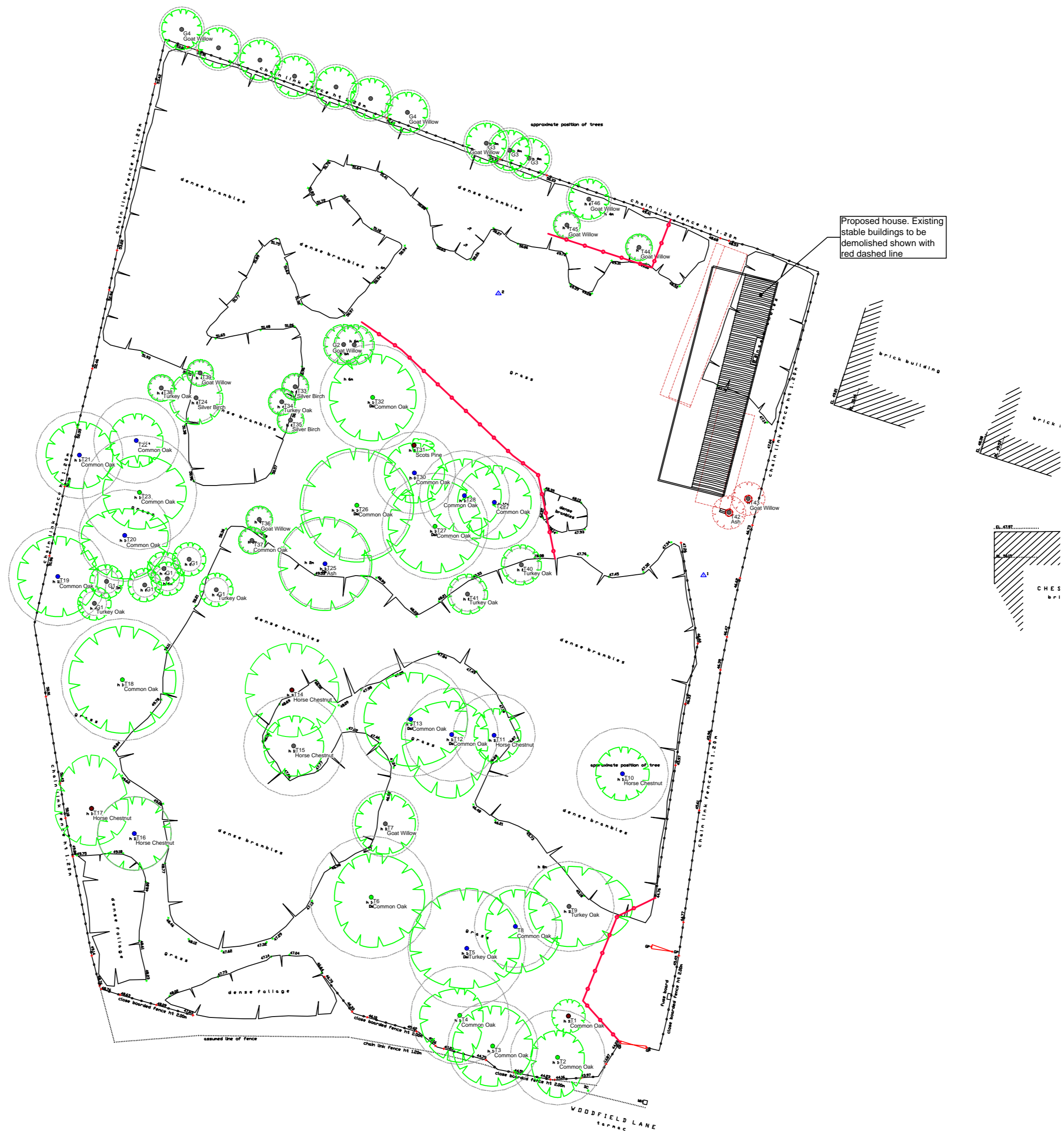

**NOTE:**  
FOR PLANNING PURPOSES ONLY  
DO NOT SCALE FROM DRAWING

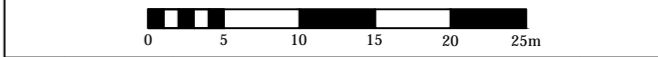

Rev	Date	Details	Drawn

**ACD**  
Ecology  
Arboriculture  
Landscape Architecture

- Rodbourne Rail Business Centre, Grange Lane, Malmesbury, Wilts, SN16 0ES  
Tel: 01666 825646 Fax: 01666 824654
- Courtyard House, Mill Lane Godalming, Surrey, GU7 1EY  
Tel: 01483 425714
- 12 Southgate Street, Winchester, Hampshire, SO23 9EF  
Tel: 01962 855604  
[www.acdlandscape.co.uk](http://www.acdlandscape.co.uk)

Copyright of ACD. All rights described in Chapter IV of the Copyright, Designs and Patents Act 1988 have been generally asserted. 2011. Copyright of this plan remains with ACD until all fees have been paid in full.

scheme: Blue Moon Paddock,  
Woodfield Lane, Essendon  
client: James Westrope  
drawing: Tree Protection Plan  
date: 23.06.2014  
scale: 1:200@A2  
dwg no: PRI19248-03  
drawn: TRG checked: AJB