



Extract of Existing Site Plan.



Extract of Proposed Site Plan.

LEGEND

- Application boundary
- HCHQ Site boundary
- ▲ △ Building entrances
- Existing buildings
- Road / tarmac
- Paths
- Grass
- Vegetation
- Existing tree

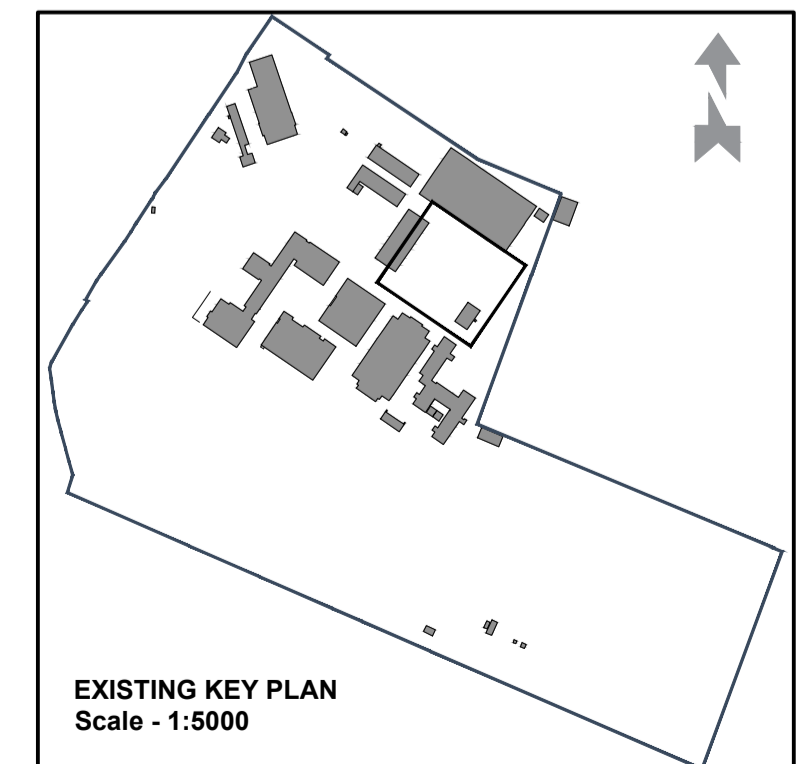
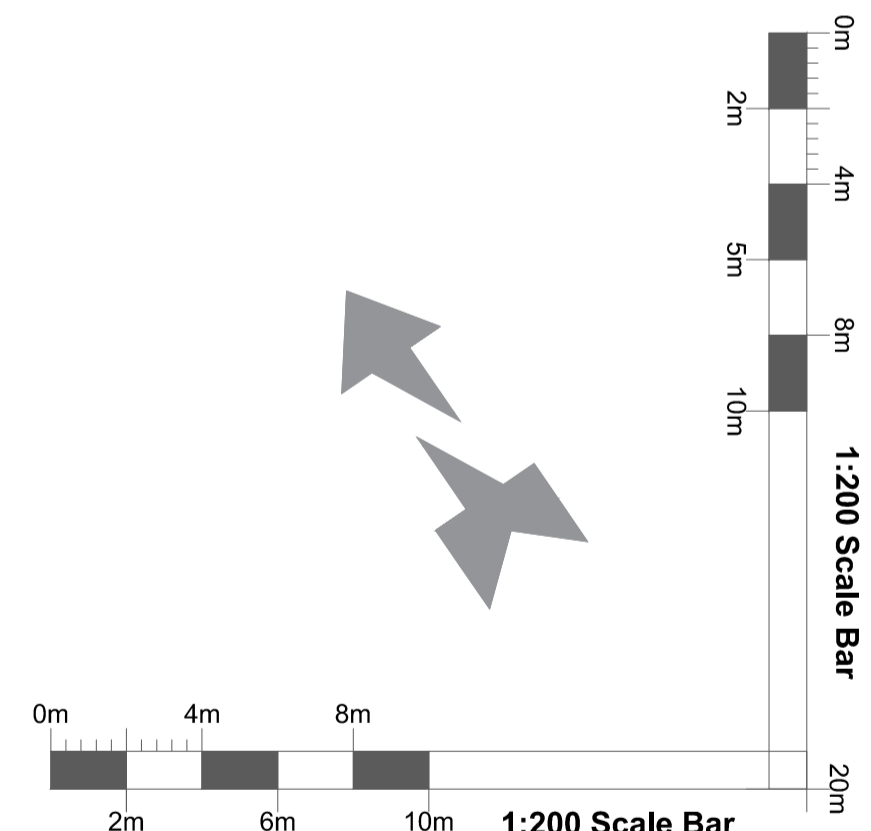

P03 Minor updates	25/06/21 NK
P02 Drawing status updated. Proposed Building relocated 10/06/21 NK	
REV DESCRIPTION	DATE BY
HERTFORDSHIRE CONSTABULARY, HEADQUARTERS REDEVELOPMENT, STANBOROUGH	
Enabling Works	
Temporary Kitchen and Canteen	
Existing and Proposed Site Plans	
VGA PROJECT NUMBER	L&L
7645	
DRAWING NO	REV
HCHQ-VGA-EW-XX-DR-AR-00540	P03
DRAWN / DATE	CHECKED / DATE
NK JAN 21	MC JUN 21
SCALE	SCALE
	1:200 @A1

PLANNING ISSUE

Written dimensions to be taken. Do not scale off the drawings. Any discrepancies written or scaled should be brought to the attention of the architect immediately. All drawings should be read together and in conjunction with relevant related specifications, room data sheets and all other consultant's information.

T: +44 (0) 1438 316 331
 architects@vincent-gorbling.co.uk
 vincent-gorbling.co.uk

Vincent and Corbling Limited, Sterling Court
 Norton Road, Stevenage, Hertfordshire SG1 2JY
 © Copyright Vincent and Corbling Limited 2020

