

SITE PLAN AS EXISTING - 1:200

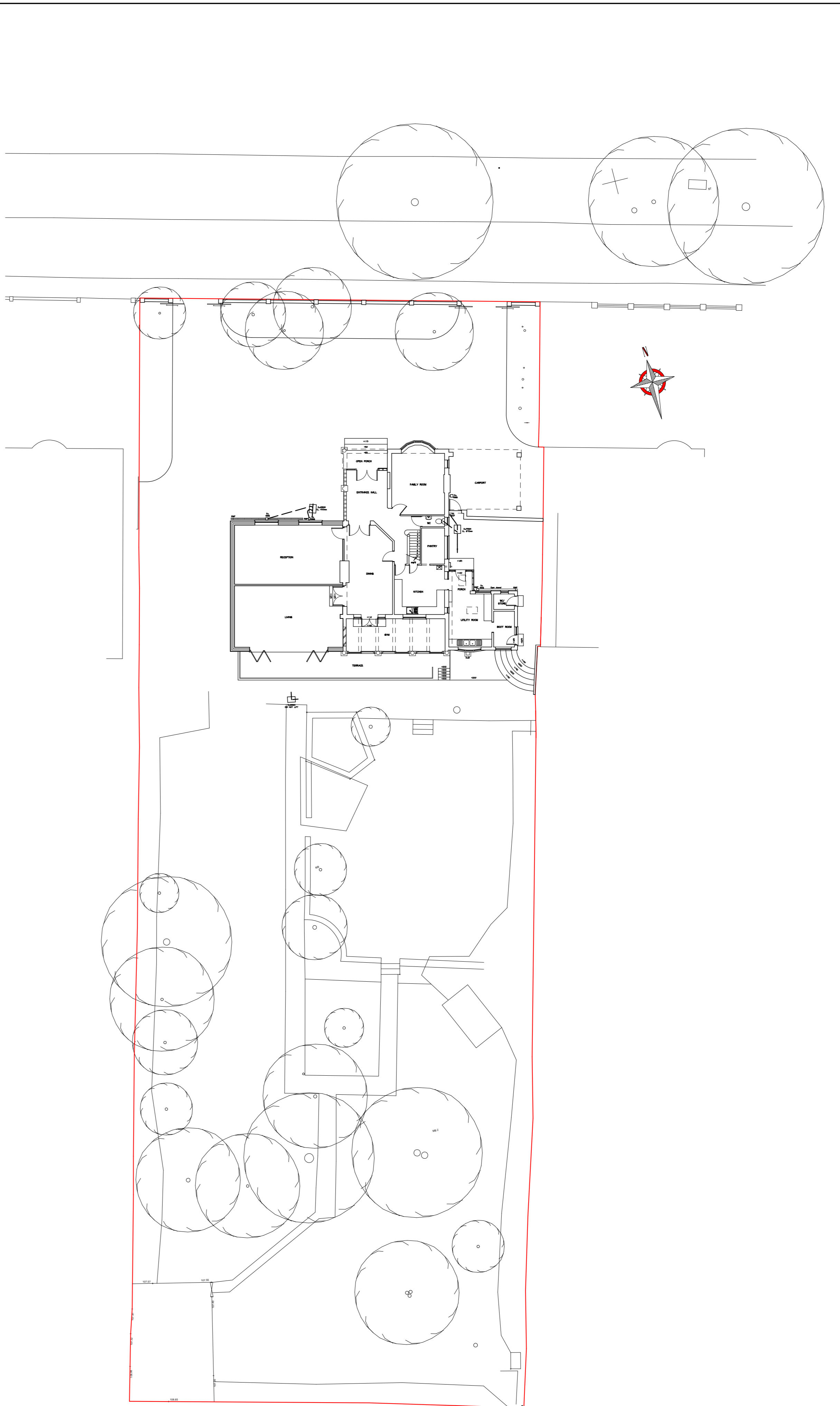

SITE PLAN AS PROPOSED - 1:200

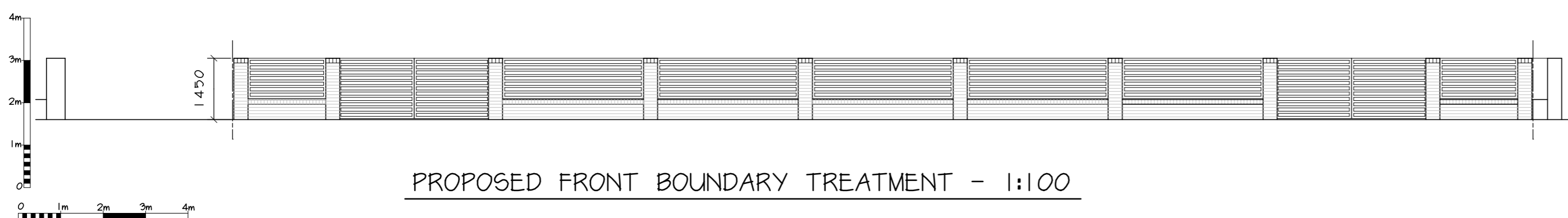

PROPOSED FRONT BOUNDARY TREATMENT - 1:100

<small>COPYRIGHT: The contents of this drawing may not be reproduced in part or in whole without the written consent of Building Design Consultants</small>		<small>DRAWING NUMBER: 21023/3</small>
PROJECT: Proposed extension and alterations		
DRAWING: Existing & proposed site plan and front boundary treatment		
CLIENT: Mr S Richmond & Ms L Montgomery	Building Design Consultants ARCHITECTURAL DESIGNERS STRUCTURAL ENGINEERS BUILDING SURVEYORS PLANNING CONSULTANTS BUILDING CONSULTANTS <small>Seamh Cottage, Birchfield Road, Nordelph, Downham Market PE38 0BP</small>	
SITE: 99 The Ridgeway Northaw Potters Bar EN6 4BG		
DATE: September 2021	Tel: 01992 768866 www.plansandcates.co.uk	
SCALES: 1:200; 1:100 @ A1		
Amendments:		
<small>THIS WORK MAY BE AFFECTED BY THE PROVISIONS OF THE PARTY WALL etc. ACT 1996</small>		
<small>THE CONTRACTOR MAY BE RESPONSIBLE FOR NOTIFYING HSE UNDER CDM REGULATIONS 1994 IF THE PROJECT IS COMMERCIAL OR INDUSTRIAL, A PLANNING SUPERVISOR SHOULD BE APPOINTED</small>		