

File name \\UK.WSPGROUP.COM\CENTRAL\DATA\PROJECTS\70088XXX\70088003 - SALISBURY SQUARE, HATFIELD\03 WIP\TRANSPORT\DRAWING\DWG\SSHT-WSP-00-XX-DR-TP-0003.DWG, printed on 24 November 2021 12:48:05, by Potter, Andrew

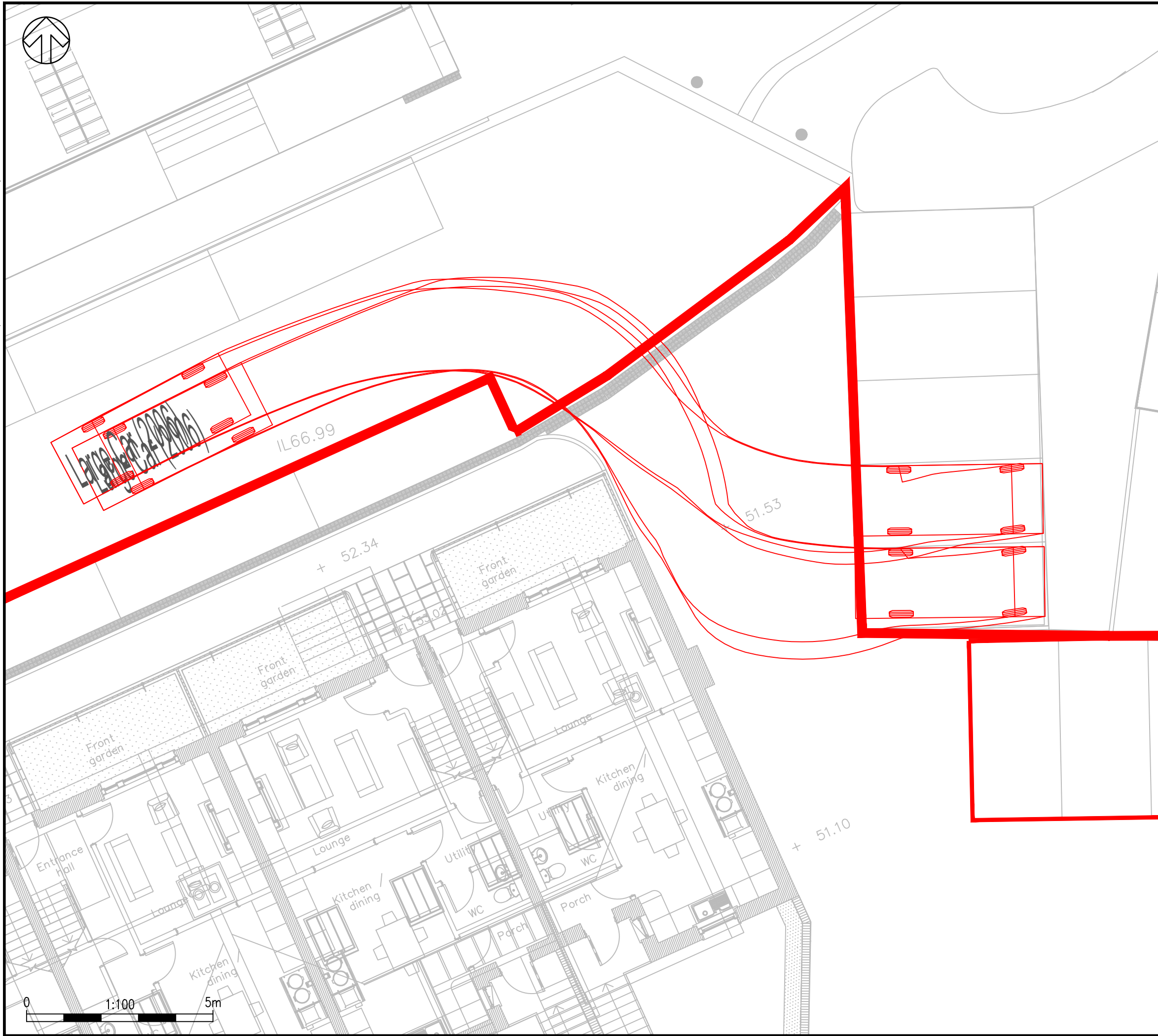

DO NOT SCALE

UNTIL TECHNICAL APPROVAL HAS BEEN OBTAINED FROM THE RELEVANT LOCAL AUTHORITIES OR STATUTORY BODIES, IT SHOULD BE UNDERSTOOD THAT ALL DRAWINGS ARE ISSUED AS PRELIMINARY AND NOT FOR CONSTRUCTION. SHOULD THE CONTRACTOR AND / OR EMPLOYER COMMENCE WORK PRIOR TO APPROVAL BEING GIVEN, IT IS ENTIRELY AT THEIR OWN RISK

| P02 | 24/11/2021 | ACP | SECOND ISSUE | LJK | LJK |
|-----|------------|-----|--------------|-----|-----|
| P01 | 23/11/2021 | ACP | FIRST ISSUE | LJK | LJK |
| REV | DATE | BY | DESCRIPTION | CHK | APP |

DRAWING STATUS: S2 - FOR INFORMATION



62-64 Hills Road, Cambridge, CB2 1LA, UK
T+ 44 (0) 1223 558 050, F+ 44 (0) 1223 558 051
wsp.com

CLIENT: GASCOYNE ESTATES

ARCHITECT: BROOKS MURRAY

PROJECT: SALISBURY SQUARE, OLD HATFIELD

TITLE: CAR PARKING

SCALE @ A3: 1:100 CHECKED: LJK APPROVED: LJK

PROJECT No: 70088003 DESIGNED: --- DRAWN: ACP DATE: November 21

DRAWING No: SSHT-WSP-00-XX-DR-TP-0003 REV: P02

© WSP UK Ltd