

This drawing is property of SAS ENERGY Ltd. No attempt should be made to copy or re-sell the drawing without prior written authorisation by the Managing Director.
This drawing is not be scaled - written dimensions only to be used. Plan drawings indicative for reference only.

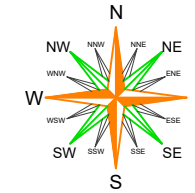
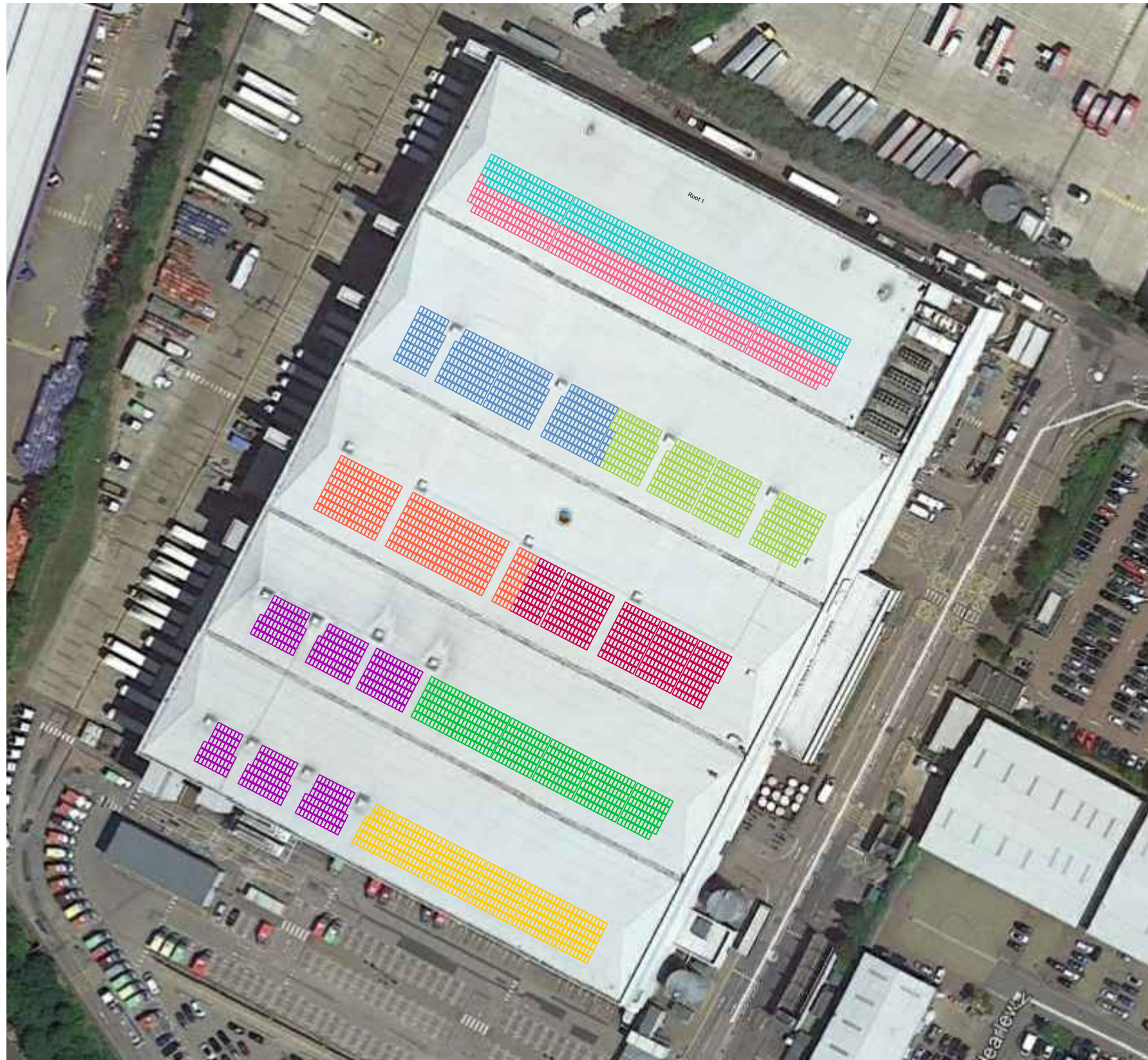

PROJECT NOTES/SPECS

Cable requirement/calculations based on SAS ENERGY document CBLDOC1 in accordance with the following:

1. The Electricity at Work Regulations
2. The Health & Safety at Work Act
3. BS 7671 Requirements for Electrical Installations
4. The IEE Wiring Regulations
5. BS EN 60904 Photovoltaic devices
6. BS EN 61173 Overvoltage protection for photovoltaic power generating systems
7. ENA ER G99 Recommendations for the connection of Generating Plant to Public Electricity Suppliers Distribution Systems
8. IEC 60364-7-712 Electrical installations in Buildings Part 7-712: Requirements for special installations or locations. Solar PV power supply systems.



REV	REVISION DETAIL	BY	APV	DATE



CLIENT	SYZYGY		
JOB	PLOT 5200 HATFIELD AL10 9BD		
TITLE	INVERTER PANEL PLAN		
STATUS	FOR INFORMATION		
DRAWN	CHKD	DATE	SCALE
NT		11/12/2020	1:1250 @ A3
DRAWING No.		REVISION	
SOLDOM11271 IPP			