

Schedule of Materials – Condition 2

03/17

York House, Salisbury Square, Hatfield



jb planning associates

Chells Manor, Chells Lane, Stevenage, Herts, SG2 7AA

e-mail info@jbplanning.com url www.jbplanning.com

tel 01438 312130 fax 01438 312131

schedule of materials

1156

1. Bricks to be used on each elevation of York House

Red Flemish Bond – Hatfield Mix bricks with snapped dark headers would be used at the site. Sample photograph is enclosed as appendix one.

2. Render Finish on Brickwork and Proprietary coloured render finish on external insulation cladding system

Cream painted render would be used, finished with KEIM granital high quality mineral exterior paint – please see appendix two.

3. New vertically proportioned sliding sash timber windows (multi-paned)

Sample photograph and technical details enclosed as appendix three. The windows would be painted white.

4. Masonry Parapets

Portland stone would be used – please see sample photograph enclosed as appendix four.

5. Chamfered and Stooled Window Cills

Portland stone would be used – please see sample photograph enclosed as appendix five.

6. Shopfront Plinths

Portland stone would be used – please see technical detail enclosed as appendix six.

7. Timber Panelling, Decorative Mouldings, Column Cladding and Stall Risers

To be constructed in same style as that shown in appendix seven.

8. Glass Reinforced Plastic Cornice, Pediment and Window-Frame Decorative Moulding Profiles

Would have a white painted finish – see sample photographs at appendix eight.

9. White Factory Finished Timber Sash Windows with Slender Glazing Bars And Sealed Double Glazing Units

Sample photograph and technical details enclosed as appendix three. The windows would be painted white.



York House, Salisbury Square, Hatfield

Schedule of Materials - Condition 2

10. Galvanised Steel Sections and Decorative Steel Pineapple Post-Tops Finished in Powder Colour-Coating

Please see appendix nine. The colour is to be confirmed.

11. Square Perforated Steel Sheet Finished in Pyrolytic Chromium Carbide Coating

Specification/details enclosed as appendix ten.

12. Rear Escape Door To Entrance Lobby

To have a white painted finish. Please see appendix eleven.

13. Black Cast Iron Rainwater Pipes, Hoppers and Brackets

To have a semi-gloss finish. Please see appendix twelve.

14. Air-Extract Louvres to Plant Room Roof

To be dark grey in colour with louvered finish. Please see appendix thirteen.

15. Plant Room Access Door

To have a white painted finish. Please see appendix eleven.

PA/1156/LS
1 March 2017



Appendix 1





Appendix 2

KEIM Granital® High quality, mineral exterior paint



1. Product description

Keim Granital is a classic mineral paint system for use on exterior mineral surfaces. Offers water repellency, vapour permeability and forms a chemical crystalline bond with the substrate. Keim Granital is made using pure inorganic mineral fillers, earth oxide colour pigments and potassium silicate binder.

2. Field of application

Exterior mineral paint for all mineral, absorbent surfaces, in particular suitable for both for the renovation of old surfaces and in new construction projects.

3. Product properties

Keim Granital is a proven extremely long life exterior mineral paint system with excellent covering power, is non fading and contains only lightfast inorganic colour pigments.

Water vapour permeable
Colourfast and UV resistant
Resistant to mould and fungal growth
Free from solvents, biocides and preservatives
Incombustible
Resistant to industrial fumes and acid rain
Highly water repellent
Resists fungal and algal growth

Material characteristics

Specific weight: approx. 1.45g/cm³

Colour fastness: A1

Water vapour diffusion density:

$$V \geq 2000\text{g}/(\text{m}^2\text{d})$$

Diffusion-equivalent air-layer thickness:

$$s_d \leq 0.01\text{m}$$

class I

Water permeability rate (24h):

$$w < 0.1 \text{ kg}/(\text{m}^2\text{h}^{0.5})$$

class III (< 0.1)

Gloss at 85°:

1.5 (matt)

Colour shades

White and in accordance with the Keim Palette Exclusiv swatch.

4. Application instructions

Substrate preparation

All loose, flaking and unstable material must be identified and then thoroughly removed, all surfaces must be thoroughly washed down with clean cold water to remove all surface dirt and dust. When all surfaces are clean, sound, wind dry, dust free and free from all surface contaminants, decoration using Keim Mineral Paints may proceed.

Application

If the substrate is porous we would advise to first coat all surfaces with Keim Granital Dilution, brush applied and worked well into all surfaces, this will help reduce any high surface porosity and should be left for a minimum period of 12 hours before further decoration.

Onto unpainted surfaces Keim Granital should be applied as a two coat system, the first coat to be diluted with up to 30% by weight Keim Granital Dilution and applied by brush or roller, working well into all surfaces. After a minimum period of 12 hours a final coat of Keim Granital may be applied undiluted.

For previously painted surfaces Keim Granital Grob diluted with up to 20% by weight Keim Granital Dilution should be used as a first coat. It is important to point out that when any redecoration is taking place this must be taken back to a natural breakline.



Application conditions

Ambient and substrate temperature above 5°C and below 30°C. Do not apply in direct sunlight or onto sun-heated surfaces, nor if it is raining or if there is an immediate likelihood of rain.

Consumption

Approx. 0.4 kg/m² Keim Granital and 0.06lt/m² Keim Granital Dilution (at 30% Keim Granital Diution).

Consumption rates are offered for guideline purposes only and are quoted for smooth rendered surfaces. Actual rates are the responsibility of the applicator. Project specifications should be referred to for specific rates.

Cleaning of tools

Clean immediately after use with water

5. Packaging

5kg & 25kg containers

6. Storage

Approx. 12 months, if kept cool, but frost free in tightly closed containers.

7. Safety instructions

Cover surfaces which are not to be painted, in particular glass, natural stone, ceramics etc. Protect the eyes and skin from splashes. Keep out of reach of children.

Refer to COSHH data sheet.

The stated values and properties are the result of extensive development work and practical experience. Our recommendations for application, whether given verbally or in writing, are intended to provide assistance in the selection of our products and do not establish a contractual relationship. In particular, they do not release those purchasing and applying our products from the duty of establishing for themselves, with due care, the suitability of our products for the intended application. Standard building industry practices must be complied with. We retain the right to make modifications to improve the products or their application. This edition supersedes all earlier editions.

**KEIM**

MINERAL PAINTS LTD

Santok Building
Deer Park Way, Donnington Wood
Telford, Shropshire, TF2 7NA
Tel. (01952) 231250
Fax (01952) 231251

www.keimpaints.co.uk
sales@keimpaints.co.uk



Appendix 3



Sliding Sash Windows

Sliding Sash - Heritage

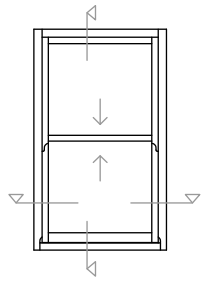

Concealed Trickle Vent

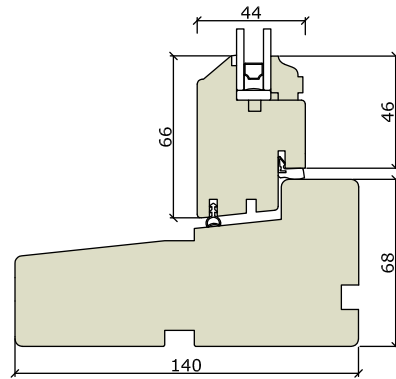
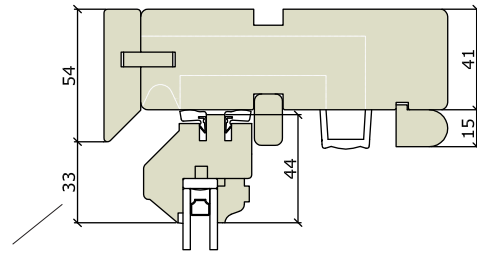

Various Cill Extension sizes available

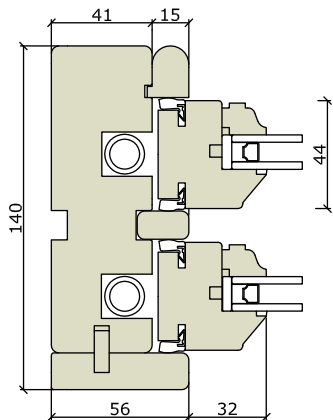

Spiral Balance

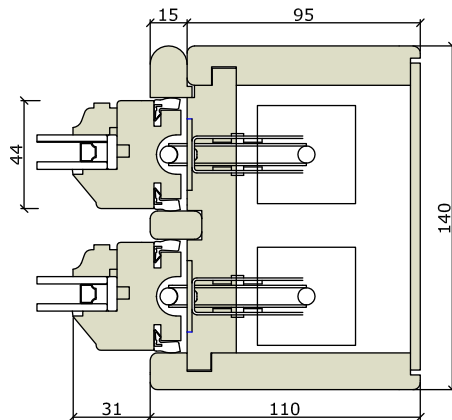

Cords & Weights



Appendix 4





Appendix 5





Appendix 6

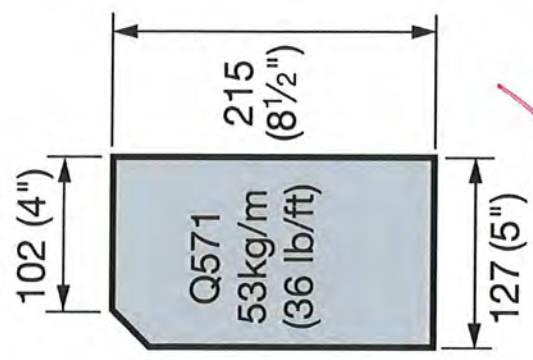
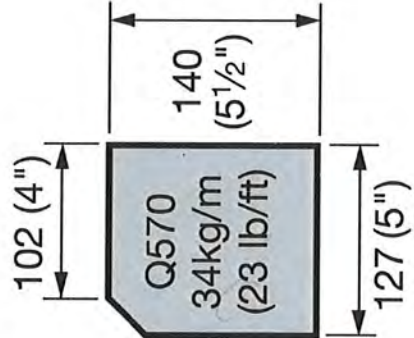
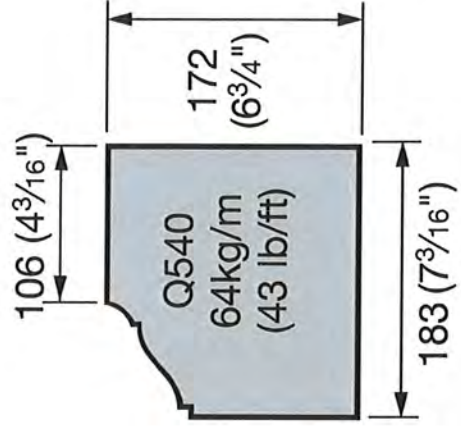
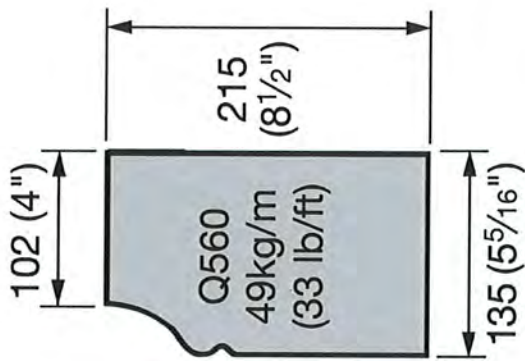
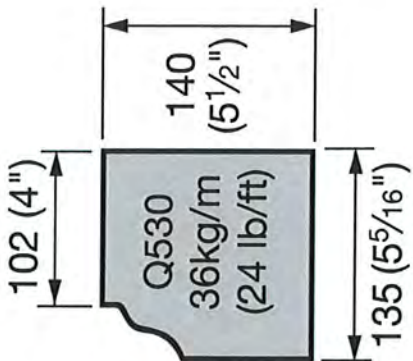

SHAPFRONT PLINTH IN
RECONSTITUTED PORTLAND STONE

Close



Appendix 7





Appendix 8



Frame 10

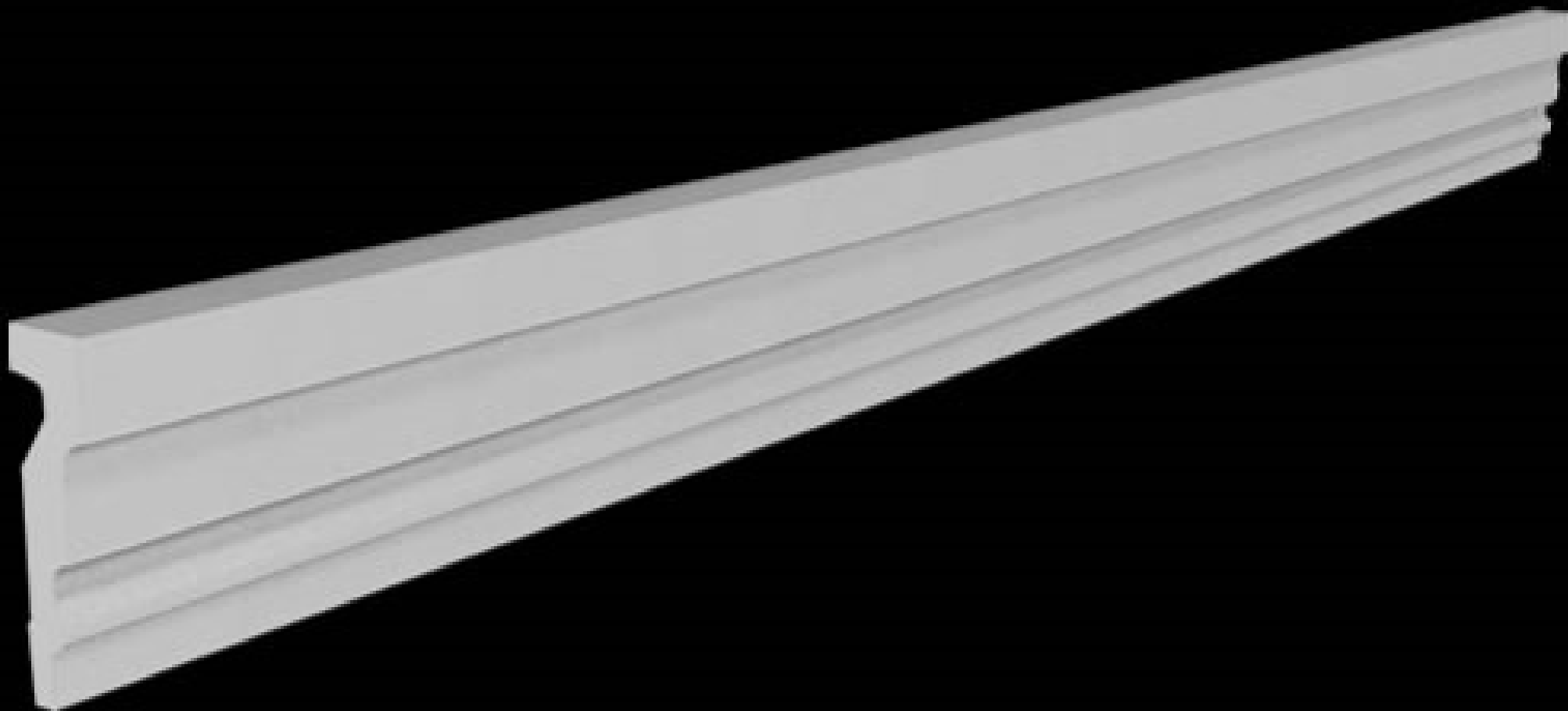

Exterior Pediment 1

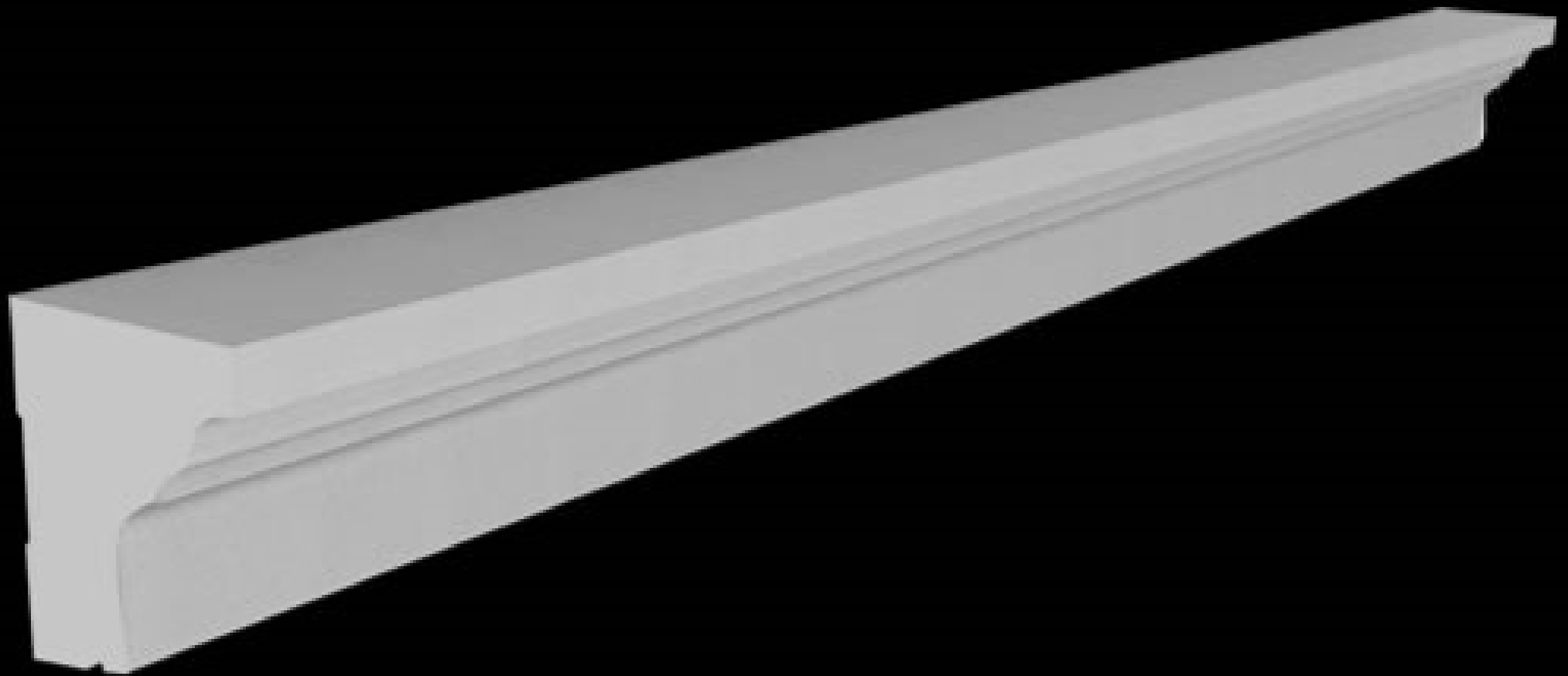



Appendix 9





Appendix 10

Aluminium Sheet Square Hole C10 • U15

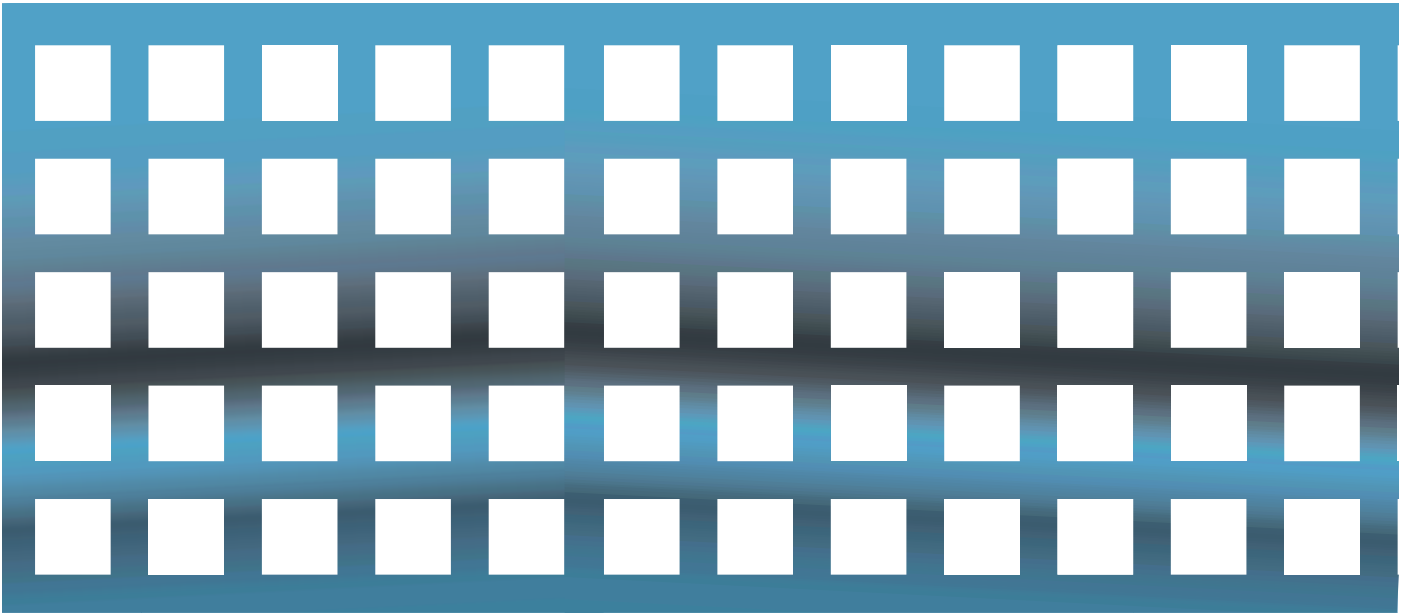

Hole Diameter (C): 10mm

Pitch (U): 15mm

Open Area: 44%

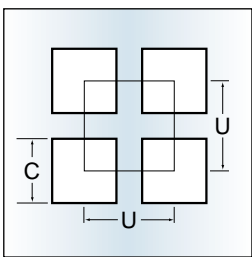

Thickness	Sheet Size (mm)
1.0	2000 x 1000
1.5	2000 x 1000 2500 x 1250
2.0	2000 x 1000 2500 x 1000 3000 x 1500
3.0	2000 x 1000 2500 x 1000



Appendix 11



Appendix 12





Appendix 13



jb planning associates

Chells Manor, Chells Lane, Stevenage, Herts, SG2 7AA
e-mail info@jbplanning.com url www.jbplanning.com
tel 01438 312130 fax 01438 312131