**FORMER BEALES HOTEL
COMET WAY, HATFIELD
Proposed Access**

Road Safety Audit - Stage 1

Final Report

August 2022

TBL19/318

REPORT APPROVAL

Project Details

Project Title	Former Beales Hotel, Comet Way, Hatfield		
Project Subtitle	Proposed Access		
Road Safety Audit	Stage 1		
Document Reference	TBL19/318	Audit Brief Date	2 nd August 2022
Overseeing Organisation	Hertfordshire County Council		
Design Organisation	Matthew Brown	RPS	
Client	-	HGH Planning	
Maintaining Agent Details	-	-	

Approvals

This document requires the following approvals:

Name	Title
Sarah Bowie	Audit Team Leader
Mario Gatti	Audit Team Member

Distribution

This document has also been distributed to:

Name	Title & Organisation
Matthew Brown	Associate – RPS (Transport & Engineering)

1 INTRODUCTION

1.1 The Scheme and its Purpose

This report results from a Stage 1 Road Safety Audit (RSA) carried out on a proposed development access junction on Comet Way, Hatfield, Hertfordshire.

The works are associated with the demolition of the former Beales Hotel and the erection of 145 residential flats. The development will provide 125 car parking spaces and 176 long stay and 8 short stay cycle parking spaces.

The proposed vehicle access is sited to the north of the existing access junction and will consist of a left in left out priority junction.

1.2 Terms of Reference & Audit Report

The Road Safety Audit Brief was approved and issued by Matthew Brown of the Design Organisation on behalf of the Overseeing Organisation. The RSA team has been approved by the Overseeing Organisation.

Table 1 - Audit Team Membership

Membership	Name	Details
Audit Team Leader	Sarah Bowie	IEng, MICE, FIHE, MCIHT, MSoRSA, HE RSA Cert Comp
Audit Team Member	Mario Gatti	BSc Civ Eng, MCIHT, MSoRSA, HE RSA Cert Comp

The Road Safety Audit was undertaken in accordance with the requirements of GG 119. No additional audit requirements were requested. The audit comprised of an examination of the brief and the documents provided to the Audit Team, listed in **Appendix A**.

The audit took place at Taylor Bowie Ltd Cambridgeshire office during August 2022 and both Audit Team Members examined the site together in daylight hours on the morning of Friday 5th August 2022 between the times of 0700 and 0830hrs. The weather during the site visit was hot and sunny. The carriageway was dry. Traffic flows at all times were light. Several pedestrians and cyclists were observed during the site visit.

The scheme has been examined, and this report compiled only on the road safety implications of the scheme as presented and has not examined or verified the compliance of the designs to any other criteria.

No Departures from Standards (DfS) have been provided to the Audit Team. It is important that if there are any DfS, then they are submitted to the Overseeing Organisation (OO) as soon as possible with appropriate mitigating measures for the OO to approve.

All Problems and Recommendations are referenced to the design drawings and the locations have been indicated on the A4 plan supplied for use by the Audit Team in **Appendix B** (where applicable).

1.3 Audit Administration

Issues identified during the audit and site visit which the Terms of Reference exclude from this report, but which the audit team wishes to draw to the attention of the OO, will be set out in a separate letter. These issues could include maintenance items and operational issues.

The Audit Team have not identified any issues during this Stage 1 RSA and site visit that are considered to be outside the Terms of Reference.

2 ITEMS RAISED AT PREVIOUS ROAD SAFETY AUDITS

No previous Road Safety Audits have been undertaken on these proposals.

3 ITEMS RAISED AT THIS STAGE 1 ROAD SAFETY AUDIT

3.1 Local Alignment

No Problems identified in this category at this Stage 1 Road Safety Audit.

3.2 General

PROBLEM	1
Location	Footway/cycleway facility (Drwg No. JNY11241-RPS-0100-SK04)
Summary	Upstand may increase the risk of pedestrian injury.
<p>Cross-section information has not been provided at this stage of audit. The scheme drawings appear to show ramp road markings suggesting that a raised cycleway is to be provided across the proposed access junction.</p> <p>An upstand between the footway and cycleway may result in an increased risk of pedestrian trip hazards, particularly blind/partially sighted or mobility impaired users resulting in pedestrian injury</p>	
RECOMMENDATION	
The Audit Team recommend that an appropriate cross section is provided.	

3.3 Junctions

No Problems identified in this category at this Stage 1 Road Safety Audit.

3.4 Walking, Cycling and Horse Riding

No Problems identified in this category at this Stage 1 Road Safety Audit.

3.5 Traffic Signs, Carriageway Markings and Lighting

PROBLEM	General
Location	Throughout the scheme extents (Drwg No. JNY11241-RPS-0100-SK04)
Summary	Existing signage and other street furniture may be vulnerable to vehicular strikes due to insufficient clearance or may cause injury to pedestrians/cyclists.
<p>The scheme proposals indicate that the alignment of the exiting footway and cycleway is to be amended in the vicinity of the proposed access junction to accommodate cycle lane priority in line with LTN 1/20.</p> <p>At present there are a number of signs and bollards located within existing verge areas in the vicinity of the proposed access junction. From the drawing provided for this audit it is unclear where these will end up being located.</p> <p>Concern arises that after the proposals are implemented, inappropriately sited signing and other street furniture may be vulnerable to vehicular strikes due to insufficient lateral clearance.</p> <p>Furthermore, signs remaining close to or within proposed footway/cycleway areas may create an obstruction for pedestrians/cyclists resulting in injury.</p>	
RECOMMENDATION	
The Audit Team recommend that at the detailed design stage that signs and other street furniture are sited appropriately and at suitable mounting heights.	

END OF PROBLEMS IDENTIFIED & RECOMMENDATIONS OFFERED IN THIS STAGE 1 ROAD SAFETY AUDIT

4 AUDIT TEAM STATEMENT

We certify that this Road Safety Audit has been carried out in accordance with GG 119.

AUDIT TEAM LEADER	
Name	Sarah Bowie - IEng, MICE, FIHE, MCIHT, MSoRSA, HE RSA Cert Comp
Signed	
Position	Director
Organisation	Taylor Bowie Ltd
Date	10 th August 2022

AUDIT TEAM MEMBER	
Name	Mario Gatti - BSc Civ Eng, MCIHT, MSoRSA, HE RSA Cert Comp
Signed	
Position	Associate Consultant
Organisation	Taylor Bowie Ltd
Date	10 th August 2022

APPENDIX A

Documents Forming the Audit Brief

Drawings:

DRAWING NO.	TITLE
JNY11241-RPS-0100-SK04	Proposed Access

Documents/Data:

**RPS – Transport Statement – Former Beales Hotel Comet Way Hatfield Hertfordshire AL10 9NG
– 26 May 2022 – JNY11241-01c Transport Statement Version 01c**

APPENDIX B

Problem Location Plan

© 2019 RPS Group

- NOTES**
1. This drawing has been prepared in accordance with the scope of work set out in the appointment letter and in respect to the information provided to RPS. RPS does not accept any liability for any use of this document other than by its client and only for the purposes for which it was prepared and provided.
 2. RPS does not accept responsibility for the accuracy of any information provided to RPS or for the accuracy of any information derived from it. Only dimensions shown on drawings should be used.
 3. This drawing is to be read in conjunction with all relevant scheme drawings.

Key:
 --- Site boundary

Based on drawing - (FloorPlan-L00 (240522))

No.	Description	By	CB	Date



20 Ferngate Street, Luton, Bedfordshire, UK
 T: +44(0)1525 38911000 E: rps@rpsgroup.com

Client: HGH Planning
 Project: Former Beales Hotel
 Title: Proposed Access

Status: PRELIMINARY
 Project Number: JNY10241
 RPS Drawing Figure Number: JNY11241-RPS-0100-SK04
 rpsgroup.com

Drawn By: MSB
 Date Created: 18/07/22
 Scale: B/A3
 Scale: 1:250

PM/Checked by: MSB

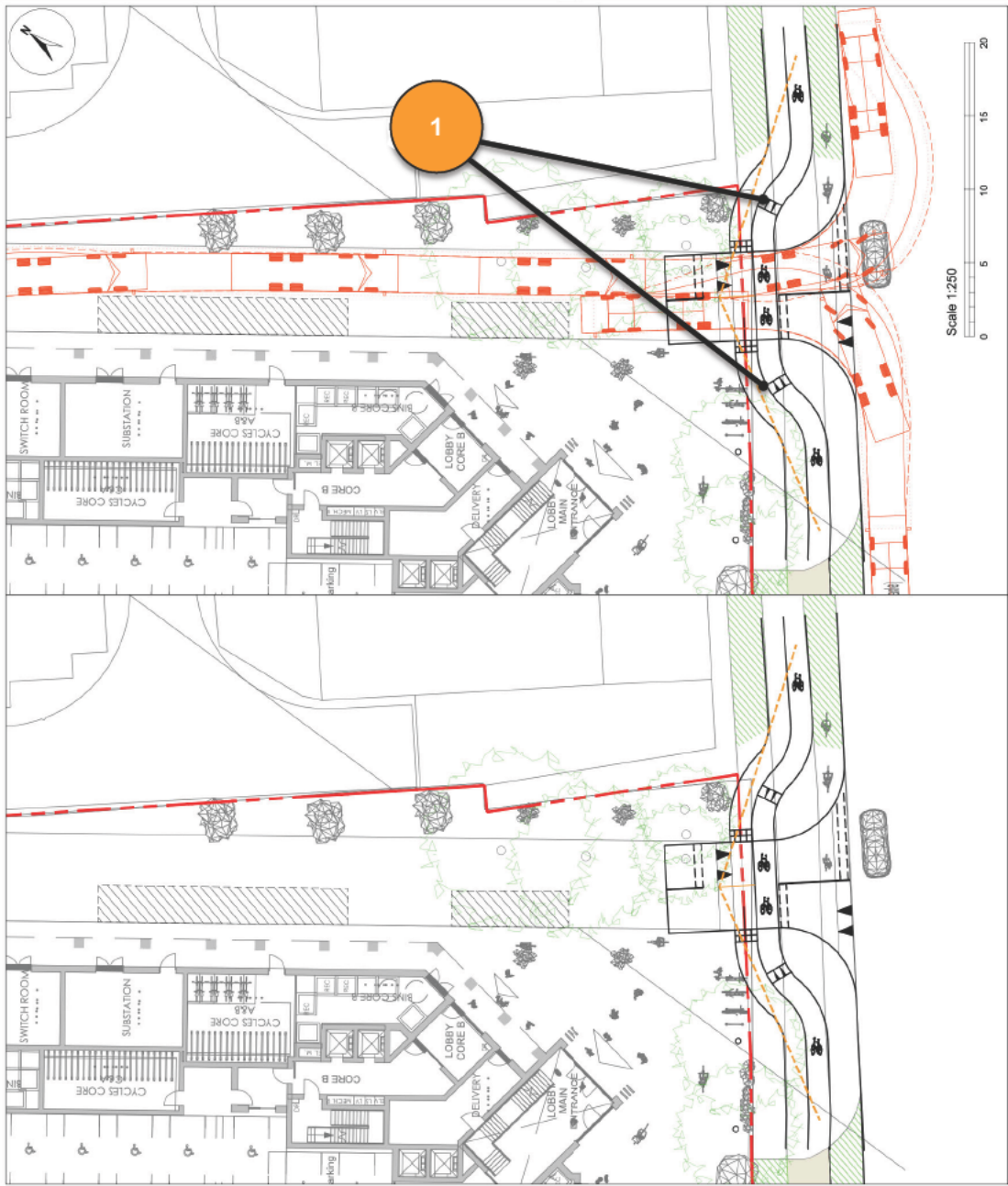

Taylor Bowie Ltd
ROAD SAFETY & TRANSPORTATION CONSULTANCY

E: info@taylorbowie.co.uk

W: www.taylorbowie.co.uk