

proposed ground plan

- 1 front entrance
- 2 hall
- 3 study
- 4 living
- 5 cloakroom
- 6 kitchen
- 7 utility
- 8 proposed extension
- 9 rear garden

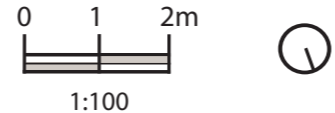

proposed rear elevation

- 1 utility
- 2 proposed extension
- 3 rear entrance
- 4 kitchen
- 5 side passage

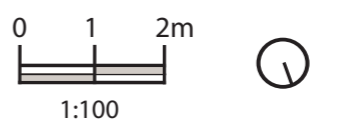

**Legend**

- brickwork
- 100mm dense concrete block
- 100mm infill cavity insulation
- steel supports
- core structural steel beam
- structural steel beam
- indicates demolition
- FFL finish floor level

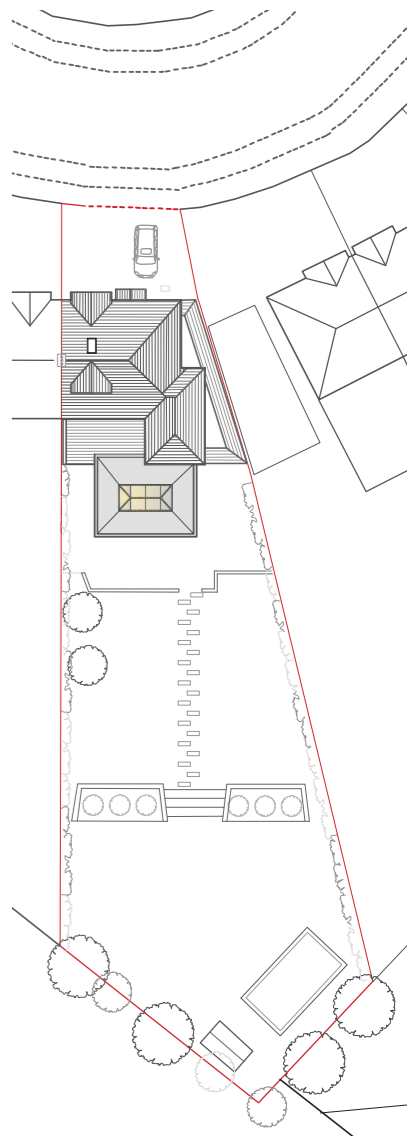

proposed site plan

document title:  
**proposed ground floor plan/  
 proposed rear elevation**

scale: 1: 100 @ A3	date: 04/01/2023	author: KMann	checked: JP
-----------------------	---------------------	------------------	----------------

**dSK Design > Construct**  
 Plan-Design-Build  
 52 Marriott Way, tel: 07779 944427  
 Bovey Tracey, TQ13 9RZ email: kenny.dsk@gmx.co.uk

site location  
**29 Selwyn Crescent  
 Hatfield, Herts, AL10 9NL**

contract code  
**604.selwyn- SW**

No liability will be accepted for amendments made by other persons. Use only written dimensions. All dimensions in (mm) to be checked on site and any discrepancies to be reported to the design team prior to working from.

This drawing pack and its subsequent revisions remain the copyright of DSK Design > Construct Under the copyright & Patent Act 1998 and may not be reproduced or amended without prior written consent.

project title:  
**single storey rear extension**

drawing No:  
**604. 05**

rev :  
 \_\_\_\_\_