

Soft Landscaping Notes

- This drawing shows the general arrangement of the landscape proposals - detailed planting proposals, including species, sizes and numbers to be provided as a planning condition on approval, though species will be based on those shown below.
- All planting to take place within the November to March planting season where possible, hedge and tree planting to be into prepared pits backfilled with topsoil, areas of shrub planting to receive min. 400mm topsoil over non-deleterious subsoil. Establishment maintenance for five years after planting to include replacement of any dead or failed plants.
- Existing retained trees are to be protected during construction in accordance with BS5837.
- Species to include the following:

Trees
Predominantly native species around site perimeter and in car park, to include oak, birch, field maple, rowan and wild cherry. More ornamental species closer to the new buildings, to provide year round interest and colour, and to include flowering and fruiting species with benefits for wildlife, such as flowering cherry, crab apple and Amelanchier.

Hedges
Mixed native species where around perimeter, to include blackthorn, hawthorn, field maple, wild rose and hazel. Single species closer to buildings, with beech, hornbeam or privet.

Shrubs
Mixture of native and ornamental species around car parks, native species to include hazel, holly, rose and dogwood. More ornamental species closer to buildings, including flowering/ fruiting species such as rose, Choisya, Philadelphus, Hypericum, lavender and laurel, with honeysuckle, ivy and other climbing plants on proposed pergolas and boundary fences.

Rain Gardens
Shrubs and grasses tolerant of intermittent damp conditions, to include dogwood, iris, Ligularia, Miscanthus, Alchemilla and Acanthus.

Wildflower Areas
Areas to be sown with locally appropriate wildflower grassland seed mix, to include cornflower, cowslip, field scabious, hemp agrimony, knapweed, ox-eye daisy, red campion, St John's wort, wild marjoram and some common poppy for short term effect.

Orchards and Herb Garden
Orchards to include a variety of fruit trees, including plum, cherry, apple and pear, with contemporary and also traditional varieties used. Herb garden to include common garden herbs, with perennial or shrubby species such as sage, rosemary, thyme, mint, fennel, sorrel and bay, together with annual planting of chives, oregano and marjoram.

ARBORICULTURIST TREE LEGEND

- **A - CATEGORY (HIGH QUALITY & VALUE)**
 - **B - CATEGORY (MODERATE QUALITY & VALUE)**
 - **C - CATEGORY (LOW QUALITY & VALUE)**
 - **U - CATEGORY (UNSUITABLE FOR RETENTION)**
- ROOT PROTECTION AREAS (RPA)**
(AS DEFINED BY BS 5837:2012)
- APPROXIMATE SHADING ARC**
(AS DEFINED BY BS 5837:2012)

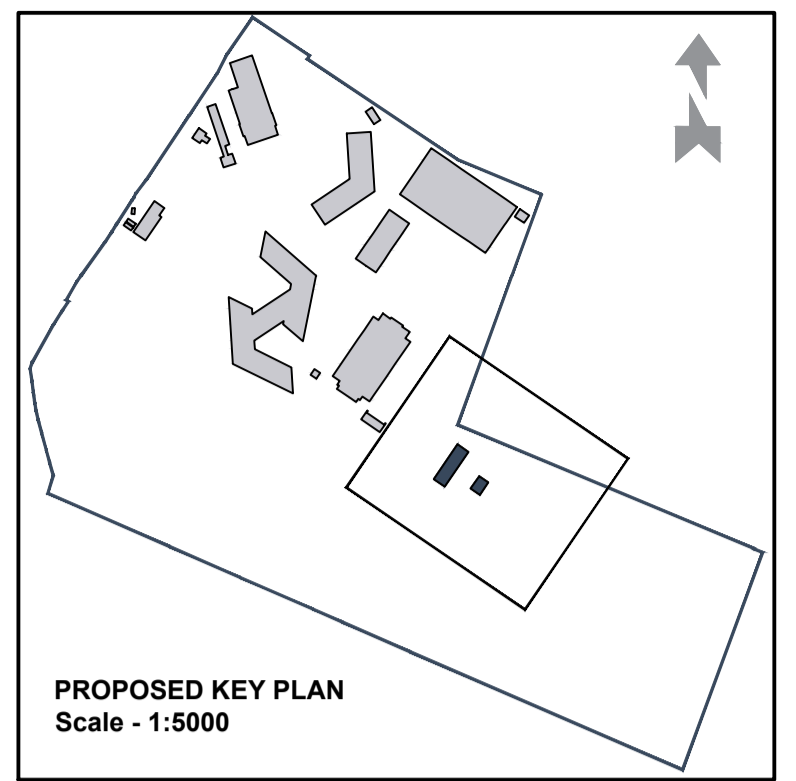

LEGEND

- Application boundary
- HCHQ site boundary
- ▲ ▲ Building access
- - - Proposed fence line
- Road tarmac
- Existing gravel / unsurfaced
- Proposed concrete blocks
- Proposed paving / pedestrian
- Grass
- Existing rubber matting on grass
- Proposed shrubs
- Existing tree
- Proposed tree

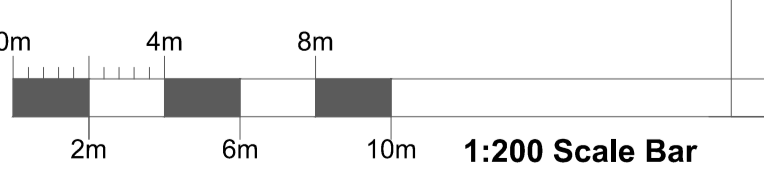

P05	Scale of drawing updated	09.07.21	CB
REV	DESCRIPTION	DATE	BY

HERTFORDSHIRE CONSTABULARY, HEADQUARTERS REDEVELOPMENT, STANBOROUGH

Enabling Works Proposed Dog Unit Proposed Block Plan

VGA PROJECT NUMBER		L&L
7645		
DRAWING NO		REV
HCHQ-VGA-EW-XX-DR-AR-00376		P05
DRAWN / DATE	CHECKED / DATE	SCALE
CB JUL 21	MC JUL 21	1:200 at A1

PLANNING ISSUE

Written dimensions to be taken. Do not scale off the drawings. Any discrepancies written or scaled should be brought to the attention of the architect immediately. All drawings should be read together and in conjunction with relevant related specifications, room data sheets and all other consultant's information.

T: +44 (0) 1438 316 331
architects@vincent-gorling.co.uk
vincent-gorling.co.uk
Vincent and Corbing Limited, Sterling Court
Norton Road, Stevenage, Hertfordshire SG1 2JY
© Copyright Vincent and Corbing Limited 2020

